

Program for the  
73rd Annual Meeting of the  
**Southern Sociological Society**

Hyatt Regency Atlanta

Atlanta, Georgia

April 21-24, 2010

**“Worlds at Risk”**

THE  
SOUTHERN  
SOCIOLOGICAL  
SOCIETY

*"docemus quaerimus"*



**Past Presidents of the Southern Sociological Society**

2009 Kathleen F. Slevin, College of William and Mary  
2008 Larry W. Isaac, Vanderbilt University  
2007 Ronald W. Wimberley, North Carolina State Univ.  
2006 Judith Blau, North Carolina-Chapel Hill  
2005 Michael Hughes, Virginia Polytechnic Institute  
2004 Charles M. Tolbert II, Baylor University  
2003 Patricia Yancey Martin, Florida State University  
2002 Rachel A. Rosenfeld, North Carolina-Chapel Hill  
2001 Kenneth C. Land, Duke University  
2000 Maxine Atkinson, North Carolina State University  
1999 Lynn Smith-Lovin, University of Arizona  
1998 Rebecca G. Adams, North Carolina-Greensboro  
1997 Karl L. Alexander, Johns Hopkins University  
1996 John Moland, Jr., Alabama State University  
1995 Thomas C. Hood, University of Tennessee  
1994 Walter R. Gove, Vanderbilt University  
1993 Shirley B. Laska, University of New Orleans  
1992 Ronald L. Akers, University of Florida  
1991 Joel Smith, Duke University  
1990 Lewis M. Killian, University of West Florida  
1989 John Shelton Reed, North Carolina-Chapel Hill  
1988 Ida Harper Simpson, Duke University  
1987 Abbott L. Ferriss, Emory University  
1986 Jeffrey K. Hadden, University of Virginia  
1985 Everett K. Wilson, North Carolina-Chapel Hill  
1984 George A. Hillery, Jr., Virginia Polytechnic Institute  
1983 Joseph H. Fichter, Loyola University-New Orleans  
1982 Charles B. Nam, Florida State University  
1981 Irving L. Webber, University of Alabama  
1980 M. Elaine Burgess, North Carolina-Greensboro  
1979 Clifton D. Bryant, Virginia Polytechnic Institute  
1978 Gerhard E. Lenski, North Carolina-Chapel Hill  
1977 Thomas R. Ford, University of Kentucky  
1976 Alan C. Kerckhoff, Duke University  
1975 Charles U. Smith, Florida A&M University  
1974 Fredrick L. Bates, University of Georgia  
1973 Charles M. Grigg, Florida State University  
1972 Richard L. Simpson, UNC-Chapel Hill  
1971 Alvin Boskoff, Emory University  
1970 John T. Doby, Emory University  
1969 John C. McKinney, Duke University  
1968 Ernest Q. Campbell, Vanderbilt University  
1967 A. Lee Coleman, University of Kentucky  
1966 Joseph S. Himes, North Carolina College  
1965 Bryce F. Ryan, University of Miami  
1964 Selz C. Mayo, North Carolina State University  
1963 Alvin L. Bertrand, Louisiana State University  
1962 Meyer F. Nimkoff, Florida State University  
1961 Edgar T. Thompson, Duke University  
1960 E. William Noland, UNC-Chapel Hill  
1959 Harold F. Kaufman, Mississippi State University  
1958 C. Horace Hamilton, North Carolina State University  
1957 Homer L. Hitt, Louisiana State University  
1956 Irwin T. Sanders, University of Kentucky  
1955 Morton B. King, Jr., University of Mississippi  
1954 Guy B. Johnson, UNC-Chapel Hill  
1953 Leland B. Tate, Virginia Polytechnic Institute  
1952 Rudolf Heberle, Louisiana State University  
1951 H.C. Brearley, George Peabody College for Teachers  
1950 Lee M. Brooks, UNC-Chapel Hill  
1949 Wayland J. Hayes, Vanderbilt University  
1948 Coyle E. Moore, Florida State University

1947 T. Lynn Smith, Louisiana State University  
1946 Charles S. Johnson, Fisk University  
1945 Howard Beers, University of Kentucky  
1944 Katharine Jocher, UNC-Chapel Hill  
1943 Katharine Jocher, UNC-Chapel Hill  
1942 William E. Cole, University of Tennessee-Knoxville  
1941 B.O. Williams, University of Georgia  
1940 Fred C. Frey, Louisiana State University  
1939 E.W. Gregory, University of Alabama  
1938 Rupert B. Vance, North Carolina-Chapel Hill  
1937 Wilson Gee, University of Virginia  
1936 E.T. Krueger, Vanderbilt University

**Roll of Honor of the Southern Sociological Society**

2009 Patricia Yancey Martin, Florida State University  
2009 Clifton Bryan, Virginia Tech University  
2008 Ida Harper Simpson, Duke University  
2007 Richard L. Simpson, UNC-Chapel Hill  
2002 Ronald L. Akers, University of Florida  
1996 Lewis M. Killian, University of West Florida  
1995 Charles B. Nam, Florida State University  
1994 Alan C. Kerckhoff, Duke University  
1990 Rudolf Heberle, Louisiana State University  
1989 Kurt W. Back, Duke University  
1986 Guy B. Johnson, UNC-Chapel Hill  
1986 Joseph H. Fichter, Loyola University, New Orleans  
1984 Joseph S. Himes, Univ. of North Carolina, Greensboro  
1982 Vernon J. Parenton, Louisiana State University  
1979 Ernst Borinski, Tougaloo College  
1977 T. Lynn Smith, University of Florida  
1977 Rupert B. Vance, UNC-Chapel Hill

**Charles S. Johnson Awardees**

2010 Larry J. Griffin, UNC-Chapel Hill  
2007 William W. Falk, University of Maryland  
2006 Dolores P. Aldridge, Emory University  
2002 John Moland, Jr., Alabama State University  
1997 Charles U. Smith, Florida A&M University

**Katharine Jocher-Belle Boone Beard Awardees**

2010 Irene Padavic, Florida State University  
2004 Barbara Risman, North Carolina State University  
1999 Patricia Yancey Martin, Florida State University  
1995 Rachel Rosenfeld, UNC-Chapel Hill

**Distinguished Contributions to Teaching Awardees**

2010 Edward L. Kain, Southwestern University  
2008 Gregory Weiss, Roanoke College  
2006 Idee Winfield, College of Charleston  
2004 Maxine Atkinson, North Carolina State University  
2002 Clifton D. Bryant, Virginia Tech University  
2002 Department of Sociology, James Madison University

**Martin L. Levin Distinguished Service Awardees**

2010 Thomas C. Hood, University of Tennessee-Knoxville  
2007 Clifton D. Bryant, Virginia Tech University  
2006 Abbot L. Ferriss, Emory University  
2004 Catherine Harris, Wake Forest University  
2003 Martin L. Levin, Mississippi State University

**Distinguished Lectureship Awardees**

2008 Larry J. Griffin, UNC-Chapel Hill  
2007 E.M. Beck, University of Georgia

# 73rd Annual Meeting of the Southern Sociological Society

Hyatt Regency Atlanta  
Atlanta, Georgia  
April 21-24, 2010

## Worlds at Risk



### **President**

Angela M. O'Rand, *Duke University*

### **Program Committee Co-Chairs**

Donald C. Reitzes, *Georgia State University*

John R. Reynolds, *Florida State University*

### **Secretary-Treasurer**

Stephanie A. Bohon, *University of Tennessee-Knoxville*

### **Local Arrangements Committee Chair**

Deirdre A. Oakley, *Georgia State University*

## **Southern Sociological Society Committees for 2009-2010**

### Officers and Executive Committee (elected)

President: Angela M. O'Rand, Duke University  
Vice President: Christopher G. Ellison, University of Texas  
President Elect: Vincent J. Roscigno, Ohio State University  
Vice President-Elect: Catherine Zimmer, University of North Carolina-Chapel Hill  
Secretary-Treasurer: Stephanie A. Bohon, University of Tennessee  
Recording Secretary: Jeralynn Cossman, Mississippi State University  
Past-President: Kathleen F. Slevin, College of William and Mary  
Past-Past-President: Larry W. Isaac, Vanderbilt University  
Past-Past-Past President: Ronald C. Wimberley, North Carolina State University  
Elected Member: John Reynolds, Florida State University, 2012  
Elected Member: Denise Bissler, Randolph Macon College, 2012  
Elected Member: April Brayfield, Tulane University, 2011  
Elected Member: Stephanie Moller, University of North Carolina-Charlotte, 2011  
Elected Member: David Brunsma, University of Missouri, 2010  
Elected Member: Kirsten Dellinger, University of Mississippi, 2010

### Publications Committee (elected)

Chair: Shelia R. Cotton, University of Alabama-Birmingham, 2010  
Francois Nielsen, Editor, *Social Forces* (ex-officio), UNC-Chapel Hill  
Robert Freymeyer, Editor, *The Southern Sociologist* (ex-officio), Pres. College  
Beth Rubin, University of North Carolina-Charlotte, 2014  
Holly J. McCammon, Vanderbilt University, 2013  
Stephanie Bohon, University of Tennessee, 2012  
Peggy Thoits, University of North Carolina-Chapel Hill, 2012  
William W. Falk, University of Maryland, 2011

### Program Committee (appointed)

Co-Chair: Donald Reitzes, Georgia State University  
Co-Chair: John Reynolds, Florida State University  
Rebecca Bach, Duke University  
Anne Barrett, Florida State University  
Linda Belgrave, University of Miami  
Charles Brody, University of North Carolina-Charlotte  
Lee Clarke, Rutgers University  
Harry Dahms, University of Tennessee-Knoxville  
Tanya Koropecyk-Cox, University of Florida  
Pamela Wilcox, University of Cincinnati

### Local Arrangements Committee (appointed)

Chair: Deirdre Oakley, Georgia State University  
William Boozer, Georgia State University  
Dawn Baunach, Georgia State University  
Woody Beck, University of Georgia  
Vincent Carter, Emory University  
Solveig Cunningham, Emory University

Finance Committee (elected and appointed)

Chair: Stephanie A. Bohon, University of Tennessee, 2012  
President: Angela M. O’Rand, Duke University  
President-Elect: Vincent Roscigno, Duke University  
Ron Wimberley, North Carolina State University, 2012  
Charles M. Tolbert II, Baylor University, 2011  
Dawn Robinson, University of Georgia, 2010

Elections Committee (appointed)

Lynne Cossman, Recording Secretary, Mississippi State University  
Nicole Rader, Mississippi State University

Nominations Committee (appointed)

Chair: Christopher Ellison, University of Texas, 2010  
Irene Padavic, Florida State University, 2012  
Michael Wise, Appalachian State University, 2012  
Barbara Johnson, University of South Carolina-Aiken, 2011  
Georgia Wilson, Miami University, 2011  
Verna Keith, Florida State University, 2011  
Cathy Zimmer, University of North Carolina-Chapel Hill, 2010  
Joel Devine, Tulane University, 2010  
Hilquias “Keo” Cavalcanti, James Madison University, 2010  
Debra Street, SUNY-Buffalo, 2010  
David Gay, University of Central Florida, 2012

Committee on Honors (appointed)

Chair: Toni Calasanti, Virginia Tech University, 2011  
Karen Campbell, Vanderbilt University, 2012  
Florence Bonner, Howard University, 2012  
Dawn Robinson, University of Georgia, 2011  
Carl Bankston, Tulane University, 2010  
Linda George, Duke University, 2010

Committee on Racial and Ethnic Minorities (appointed)

Chair: David Brunsma, University of Missouri 2011  
Cameron Lippard, Appalachian State University, 2011  
Eunice Bakanic, College of Charleston, 2010  
Bruce Wade, Spelman College, 2010  
Gabriel Acevedo, University of Texas-San Antonio, 2012  
Tameka Davis, Georgia State University, 2012

Committee on Professions (appointed)

Chair: Suzanne Kurth, University of Tennessee, 2010  
Jennifer Johnson, Virginia Commonwealth University, 2011  
Xiaohe Xu, Mississippi State University, 2011  
Matt Lee, Louisiana State University, 2010  
Rae Blumberg, University of Virginia, 2012  
Kenneth Spenner, Duke University, 2012

Committee on Sociological Practice (appointed)

Chair: William Canak, Middle Tennessee State University, 2010  
Sarah Jane Brubaker, Virginia Commonwealth University, 2011  
Michael Maume, University of North Carolina-Wilmington, 2011  
Barry R. Beasley, South Carolina Department of Natural Resources, 2009  
Brigitte Neary, University of South Carolina-Upstate, 2012  
Rachel Kimbro, Rice University, 2012

Committee on Sociology in Community and Small Colleges (appointed)

Chair: Denise Bissler, Randolph Macon College, 2011  
Amie Hess, Meredith College, 2012  
Siti Kusujarti, Warren Wilson, 2012  
Chandrouti Persaud, Mississippi Valley State, 2011  
Daniel Harrison, Lander University, 2010  
Lisa Peloquin, Elon University, 2010

Membership Committee (appointed)

Chair: Christopher Ellison, University of Texas, 2011  
Salvatore Saporito, College of William and Mary, 2011  
Darren Sherkat, University of Southern Illinois, 2011  
Rebecca Powers, East Carolina University, 2011  
Gary Jensen, Vanderbilt University, 2010  
Robert Davis, North Carolina A&T, 2012  
Regina Bures, University of Florida, 2012

Committee on the Status of Students (appointed)

Chair: Jeff Will, University of North Florida, 2012  
Brandy Simula, Emory University, 2011  
Deenesh Sohoni, William and Mary, 2011  
Susan Webb, Coastal Carolina University, 2010  
Robert Moore, Frostburg State University, 2010  
Fenian Chen, North Carolina State University, 2012

Committee on the Status of Women (appointed)

Chair: Elizabeth Gorman, University of Virginia, 2011  
Nancy Randall, Wingate, 2012  
Patricia Drenteau, University of Alabama-Birmingham, 2012  
Emily Fairchild, New College, Florida, 2011  
Elizabeth Sheff, Georgia State University, 2010  
Marieke Van Willigen, East Carolina University, 2010

Site Selection Committee (appointed)

Chair: Angela M. O'Rand, Duke University  
Site Selection Officer: Kenneth C. Land, Duke University  
Site Selection Officer: Dennis McSeveney, University of New Orleans  
Stephanie A. Bohon (ex-officio), University of Tennessee  
Ronald C. Wimberley, North Carolina State University  
Kathleen F. Slevin, College of William and Mary  
Larry W. Isaac, Vanderbilt University

Archivist (appointed)

James Hougland, University of Kentucky, indefinite term

Presidential Aide (appointed)

Rebecca Tippett

Electronic Communications Coordinator/Webmaster (appointed)

James Maples, University of Tennessee-Knoxville, 2012

Audio-Visual Coordinator (appointed)

Carmel E. Price, University of Tennessee-Knoxville, indefinite term

Consortium of Social Science Associations (COSSA) Liaison (appointed)

Vincent J. Roscigno, Ohio State University

Organizational Liaison (appointed)

Kirsten Dellinger, University of Mississippi

Parliamentarian (appointed)

Thomas C. Hood, University of Tennessee-Knoxville, indefinite term

## From Angela M. O’Rand, SSS President

Happy 2010!

Let us hope that this year will be happier in some ways than 2009. I selected the theme of “Worlds At Risk” for 2010 at our meetings in 2008 when I had just become President-Elect. Little did I expect that within a few months we would find ourselves entering the unprecedented economic downturn of most of our lives. However, I selected the theme then because numerous social indicators that concern us as sociologists strongly indicated that while much evidence pointed to positive trends in such things as child well-being, gender equality, the management of some infectious diseases, etc., risks were spreading across all domains of daily life. Growing economic insecurities attached to risks from declining high school graduation rates, wage stagnation or decline, underemployment/unemployment, and financial loss were already documented in the sociological literature on educational attainment, labor markets, income and wealth trajectories, poverty rates, declining health insurance coverage, and shifts in pension coverage. And, while these changes have moved the management of more and more uncertainty to individuals, families, and households, families themselves have continued to be highly differentiated and volatile arrangements. Similarly, global environmental hazards have come close to home, while engagement in military actions abroad has introduced other new global risks. And, although global wealth has increased dramatically and populations are aging around the world, the quality of life for many populations has not improved or has deteriorated.

So we have good news and bad news to talk about in Atlanta. We visited the meeting site in November, and we are very excited about its quality. The Hyatt Regency in Atlanta is a lovely and comfortable hotel in downtown Atlanta within walking distance of scores of restaurants of all kinds and interesting landmarks, exhibits, and entertainment venues. Check out the report [*The Southern Sociologist*, Winter 2010, p. 8] of our Local Arrangements Committee chaired by Deirdre Oakley from Georgia State University.

Program Co-Chairs Don Reitzes (Georgia State University) and John Reynolds (Florida State University) report that we received over 500 individual paper submissions plus panel submissions including about 200 panelists. This is a very positive turnout with exciting titles throughout. The Program Committee is now at work putting the final schedule together. I want to thank them all. In addition to Don and John they include: Rebecca Bach (Duke), Anne Barrett (Florida State), Linda Belgrave (University of Miami), Charles Brody (University of North Carolina-Charlotte), Lee Clarke (Rutgers), Harry Dahms (University of Tennessee-Knoxville), Tanya Koropecj-Cox (University of Florida), and Pamela Wilcox (University of Cincinnati).

Three plenary speakers are already on our program. Evelyn Nakano Glenn of the University of California-Berkeley and President of the American Sociological Association this year—which will also be meeting in Atlanta—will present a talk on “Citizenship: Belonging, Recognition, and Rights” in which she will be comparing conceptions of citizenship and models of belonging. Two of our SSS colleagues will also be making presentations in plenary sessions: George Ritzer (University of Maryland) will present “Consuming America: What Have We Done to Ourselves? What Did They Do to Us?” And, Arne Kalleberg (University of North Carolina-Chapel Hill) will present “Socializing Risk: The Promise of Flexicurity.”

So, thank you for making plans to join us. See you all in Atlanta in a few months.

[From *The Southern Sociologist*, Winter 2010, pp. 1-2.]

## Program Summary

Wednesday, April 21

Committee Meeting— Executive Committee (Geneva); 2:00 PM—6:00 PM  
Registration (International Tower Lobby); 4:00 PM—6:00 PM

Thursday, April 22

Committee Meeting— Publications Committee (Geneva); 7:30 AM—8:30 AM  
Committee Meeting— Executive Committee (Geneva); 8:30 AM—11:00 AM  
Book Exhibit (Grand Hall East); 8:00 AM—5:00 PM  
Registration (International Tower Lobby); 8:00 AM—5:00 PM  
Committee Meeting— Finance Committee (Geneva); 12:00 PM—1:00 PM  
Graduate Student Reception (Max Legers, 320 Peachtree St.); 6:00 PM—9:00 PM  
Dinner with the Committee on Sociology in Community and Small Colleges; 6:30 PM meet in the lobby  
of the conference hotel  
SWS-South Silent Auction (Cairo); 7:30 PM—8:30 PM  
SWS-South Business Meeting (Cairo); 8:30 PM—9:30 PM

Sessions 9:00 AM—10:30 AM

1. Panel Session— Incorporating Documentaries into the Classroom (Grand Hall B)
2. Paper Session— Difficulties of Fighting Power (Manila)
3. Paper Session— Environmental Attitudes, Behaviors, and Policies (Montreal)
4. Paper Session— Gender and Leisure (Grand Hall C)
5. Paper Session— Gendered Bodies, Discourses, and Identity (Brussels)
6. Paper Session— Health: Institutional Contexts and Individual Consequences (Hong Kong)
7. Paper Session— How Globalization Works (Cairo)
8. Paper Session— Innovative Teaching (Vancouver)
9. Paper Session— Sociology Through Film (Singapore)
10. Paper Session— Tests of the Generalizability of Criminological Theory (Grand Hall A)
11. Paper Session— The Economic Meltdown: How Outlooks on the Future Shape Risk Perception and Decision Making (Grand Hall D)

Sessions 10:45 AM—12:00 PM

12. Plenary Speaker: ASA President Evelyn Nakano Glenn (Cairo)

Sessions 12:15 PM—1:45 PM

13. Panel Session— Do You Want to Work at a Small or Community College? (Manila)
14. Paper Session— Attitudes about Crime and Punishment (Grand Hall D)
15. Paper Session— Economy, Work, and Community Change (Singapore)
16. Paper Session— Framing Rhetorics of Social Problems (Cairo)
17. Paper Session— Historical Timing: Socioeconomic Mobility of Racial-ethnic Minorities (Hong Kong)
18. Paper Session— Identities True and False: Commercial Music as Problematic (Grand Hall B)
19. Paper Session— Intersections: Contemporary Culture and Identity (Vancouver)
20. Paper Session— Matters of Life and Lifestyle (Grand Hall C)
21. Paper Session— Patients, Families, and Perceptions of Health Care Issues (Montreal)
22. Paper Session— Research on Gender and the Media (Grand Hall A)
23. Paper Session— Sports and Leisure (Brussels)

Thursday, April 22 (cont'd)

Sessions 2:00 PM—3:15 PM

24. Plenary Speaker: Arne Kalleberg (Cairo)
25. Panel Session— Public Sociology and the Classroom: Variations on a Theme (Montreal)
26. Paper Session— “Like a Virgin”: Research on Adolescent Sexuality (Singapore)
27. Paper Session— Doing Sociology: Reflections, Methods, and More (Grand Hall A)
28. Paper Session— Social Movements (Manila)
29. Paper Session— Space and Stratification, Place and Portability: Healthcare, Language, and Transportation (Vancouver)
30. Paper Session— Technology and Identity/Role (Grand Hall D)

Sessions 3:30 PM—5:00 PM

31. Paper Session— Discrimination, Disparities, and Social Reproduction (Hong Kong)
32. Paper Session— Expanding Disasters: Directions for the Sociology of Disaster (Grand Hall B)
33. Paper Session— From Global Crisis to Global Alternatives? Part 1: Dominant and Challenging Ideologies (Grand Hall C)
34. Paper Session— Gender Roles in Public and Private Spheres (Singapore)
35. Paper Session— Health and Health Care: Professional and Lay Perspectives (Brussels)
36. Paper Session— Identity and Emotion (Grand Hall A)
37. Paper Session— Network Context, Crime, and Fear of Crime (Vancouver)
38. Paper Session— Sexuality Research (Cairo)
39. Paper Session— Social Construction of Race (Manila)
40. Paper Session— Sociology of Religion (Grand Hall D)
41. Paper Session— Teaching Sociology Through Film (Montreal)

Sessions 5:15 PM—6:30 PM

42. Panel Session— Center for the Study of Social Justice (Brussels)
43. Panel Session— The Pros and Cons of Working at a Community College (Singapore)
44. Paper Session— Expanding Disasters: Directions for the Sociology of Disaster 2 (Grand Hall B)
45. Paper Session— Frame Analysis and Social Movements (Cairo)
46. Paper Session— From Global Crisis to Global Alternatives? Part 2: States, Place, and Policy (Grand Hall C)
47. Paper Session— Qualitative Research on Crime and the Criminal Justice System: Drugs, Courts and Jail (Grand Hall D)
48. Paper Session— Social Control: Multiple Forms and Contexts (Manila)
49. Paper Session— Social Psychology: Race and Identity (Hong Kong)
50. Paper Session— Studies of Popular Culture (Grand Hall A)
51. Paper Session— Teaching Criminology and Criminal Justice: Special Issues (Vancouver)
52. Paper Session— The Intersections of Gender and Sexuality (Montreal)

Friday, April 23

ASA Chair's Breakfast (Geneva); 7:00 AM—8:00 AM

Committee Meeting— Executive Committee (Heritage); 8:00 AM—10:00 AM

Book Exhibit (Grand Hall East); 8:00 AM—5:00 PM

Registration (International Tower Lobby); 8:00 AM—5:00 PM

Friday, April 23 (cont'd)

Sessions 9:00 AM—10:30 AM

53. Panel Session— Radical Sociology in a Time of Crisis and Ambiguity (Hong Kong)
54. Paper Session— Climate Change: How the Growth Machine and Big Coal Threaten Us All (Grand Hall B)
55. Paper Session— Countries and Communities in Transition (Cairo)
56. Paper Session— Gender and Education (Manila)
57. Paper Session— Immigration, Ethnic Segregation, Acculturation, and Crime (Singapore)
58. Paper Session— Issues of Gender and Sexuality in Deviance and Crime (Grand Hall D)
59. Paper Session— Popular Culture/Media (Grand Hall A)
60. Paper Session— Qualitative Identity Research: Identity Conflicts and Constructing Collectives (Grand Hall C)
61. Paper Session— Social Class in the U.S. (Lenox)
62. Paper Session— Solving Teaching Problems (Montreal)
63. Paper Session— Violence, Poverty, and Loss: Mental Health Effects and Interventions (Vancouver)

Sessions 10:45 AM—12:00 PM

64. Plenary Speaker: George Ritzer (Cairo)
65. Paper Session— Fighting HIV/AIDS in the African-American Community: A Peer Education Model (Vancouver)
66. Paper Session— From Cradle to Grave: Technology Usage Across the Life Course (Montreal)
67. Paper Session— Gender, Work and Family (Singapore)
68. Paper Session— Great Raced and Gendered Expectations: The Reproduction of Inequality in the Unlikeliest of Places (Manila)
69. Paper Session— Identity Research: Gender, Power, and Self in College Communities (Grand Hall D)
70. Paper Session— The Impact of Language on Social Identity (Grand Hall A)

Sessions 12:15 PM—1:45 PM

71. Panel Session— Experiential Learning in Community College and Small College Sociology Classes (Vancouver)
72. Paper Session— Climate Change and Environmental Policy: Local, National, and International Contexts (Grand Hall B)
73. Paper Session— Community, Poverty, and Public Health (Grand Hall C)
74. Paper Session— Faces of Violence (Manila)
75. Paper Session— Family Structure: Constraints and Choices (Singapore)
76. Paper Session— New Research in Social Psychology (Lenox)
77. Paper Session— Race and Politics (Grand Hall A)
78. Paper Session— Spatial and Temporal Analysis of Crime (Montreal)
79. Paper Session— The Uses of Music in the 21st Century: Social Movement, Work, Corporate Taste (Cairo)
80. Paper Session— Theory: Bourdieu as a Social and Critical Theorist (Grand Hall D)
81. Paper Session— Workplace Experiences (Hong Kong)

Sessions 2:00 PM—3:15 PM

82. Author-Meets-Critics Session— “Doing Business with Beauty: Black Women, Hair Salons, and the Racial Enclave Economy” by Adia Harvey Wingfield (Hong Kong)
83. Panel Session— Navigating the Academic Job Market (Manila)
84. Panel Session— The Relevance of the Master’s Degree for All Graduate Departments (Montreal)

Friday, April 23 (cont'd)

- 85. Paper Session— Culture, Institutions, and Meaning (Grand Hall C)
- 86. Paper Session— Immigration (Grand Hall A)
- 87. Paper Session— Intimate Relationships: Formation, Stability, and Quality (Lenox)
- 88. Paper Session— Regionalizing the Sociology of Culture: Media, Institutions, and Disciplines (Singapore)
- 89. Paper Session— Sexuality Issues of College Students (Vancouver)
- 90. Paper Session— Social Movement Dynamics (Cairo)
- 91. Paper Session— Theory: Gouldner, Mills, Marcuse, and Critical Theory in America (Grand Hall D)
- 92. Paper Session— Undergraduate Teaching: Gathering of New Research (Grand Hall B)

Sessions 3:30 PM—5:00 PM

- 93. Panel Session— Experiential Learning in Community College and Small College Sociology Classes Session II (Manila)
- 94. Panel Session— Session Honoring Irene Padavic as Recipient of the Katherine Jocher-Belle Boone Beard Award for Gender Scholarship (Cairo)
- 95. Paper Session— Applied Sociology with a “Southern Face” (Montreal)
- 96. Paper Session— Challenges in Qualitative Research: Dilemmas in Ethics, Funding and Fieldwork (Lenox)
- 97. Paper Session— Migration Research and Immigrant Outcomes (Vancouver)
- 98. Poster Session (International Ballroom North)
- 99. Paper Session— Racial-ethnic Identity (Hong Kong)
- 100. Paper Session— Risk and Disease: Medical and Community Perspectives (Singapore)
- 101. Paper Session— Teaching Sociology Through Film, Session 2 (Grand Hall A)
- 102. Paper Session— Theory: Ethnography, Grounded Theory, and Social Critique (Grand Hall D)
- 103. Paper Session— Work and Labor (Grand Hall C)
- 104. Paper Session— Youth Crime and Violence (Grand Hall B)

Sessions 5:00 PM—6:30 PM

- 105. Presidential Honors & Convocation Plenary (International Ballroom South)

Presidential & Awards Reception (International Ballroom North); 6:30 PM—8:00 PM

Saturday, April 24

- Committee Meeting— SSS Business Meeting (International Ballroom South); 7:30 AM—8:30 AM
- Registration (International Tower Lobby); 8:00 AM—12:00 PM
- Committee Meeting— Executive Committee (Saturday) (Heritage); 8:30 AM—11:00 AM
- Committee Meeting— Site Selection Committee (Heritage); 12:00 PM—1:00 PM

Sessions 9:00 AM—10:30 AM

- 106. Panel Session— Academic Workshop on “Preparing for a Program Review” (Montreal)
- 107. Panel Session— Sociology and...: Team-Teaching across Disciplines (Manila)
- 108. Panel Session— Writing a Grant for NSF (Lenox)
- 109. Paper Session— Caring for Elders: Places, Policies, and Practices (Grand Hall B)
- 110. Paper Session— Help-Seeking, Social Networks, and Stress (Vancouver)
- 111. Paper Session— Interactionist Studies in Masculinity (Hong Kong)
- 112. Paper Session— Intersecting Inequalities: Race-ethnicity, Class, and Gender (Grand Hall A)
- 113. Paper Session— Intimate Partner Violence (Grand Hall C)
- 114. Paper Session— Macro-structuring of Religion (Singapore)

Saturday, April 24 (cont'd)

- 115. Paper Session— Service Workers and Professionals (Cairo)
- 116. Paper Session— Sociological Theory: Classical and Contemporary Perspectives (Grand Hall D)

Sessions 10:45 AM—12:15 PM

- 117. Panel Session— What Else Can I Do With My Advanced Degree in Sociology? Alternatives to Academia (Grand Hall B)
- 118. Paper Session— Applying Qualitative Methods to Sex and Gender Research: Rodeos, Drag Shows, Nurses and Bears (Grand Hall C)
- 119. Paper Session— Education Policies and Programs: Effectiveness and Outcomes (Cairo)
- 120. Paper Session— Emotions, Identity and Politics in the Battle over Terri Schiavo (Singapore)
- 121. Paper Session— Expectations and Perceptions in Education: Social Class, Cultural Capital, and Gender (Lenox)
- 122. Paper Session— Group Identity and Collective Memory (Montreal)
- 123. Paper Session— Health Disparities, Social Capital, and Vulnerability (Manila)
- 124. Paper Session— Impacts of Social Policy on Economic and Racial Inequality (Grand Hall A)
- 125. Paper Session— Interactionist Studies in Symbolic Boundaries (Hong Kong)
- 126. Paper Session— Interracial Relationships and Identities (Vancouver)
- 127. Paper Session— Theory between Politics, Policy, and Culture (Grand Hall D)

Sessions 12:30 PM—1:45 PM

- 128. Panel Session— Teaching Critical Sociological Thinking: A Teaching Workshop (Manila)
- 129. Paper Session— Gender and Aging: Representations and Realities (Singapore)
- 130. Paper Session— Gender Issues in Higher Education (Grand Hall A)
- 131. Paper Session— Industrial Relations & Global and Local Markets (Montreal)
- 132. Paper Session— Issues in Identity (Grand Hall C)
- 133. Paper Session— Law & Society: Judicial and Regulatory Enforcement (Vancouver)
- 134. Paper Session— Perceptions of Crime, Crime Avoidance, and Crime Coping (Lenox)
- 135. Paper Session— Political and Environmental Knowledges (Grand Hall B)
- 136. Paper Session— Race, Inequality, and Justice (Cairo)
- 137. Paper Session— The Sound of Music (Hong Kong)
- 138. Paper Session— Theory: Symbolic Interactionism and Identity (Grand Hall D)

Sessions 2:00 PM—3:30 PM

- 139. Panel Session— How to Participate in Assessment Without Really Trying (Lenox)
- 140. Paper Session— Applied Sociology and Evaluation Research (Grand Hall C)
- 141. Paper Session— Community Research Partnerships: Revisiting the City as a Social Laboratory (Cairo)
- 142. Paper Session— Effects of Religion and Spirituality (Singapore)
- 143. Paper Session— Higher Education: Organization, Control, and Social Capital (Grand Hall A)
- 144. Paper Session— Investigations into the Social Construction of Knowledge (Grand Hall D)
- 145. Paper Session— Motivations and Mechanisms for Making the World a Better Place (Montreal)
- 146. Paper Session— Racial-ethnic Prejudice and Discrimination (Hong Kong)
- 147. Paper Session— Religious and Cultural Divides (Grand Hall B)
- 148. Paper Session— Stratification of Buying and Borrowing, Living and Dying (Vancouver)
- 149. Paper Session— Well-being in Later Life: Transitions, Trajectories, and Timing (Manila)

## Wednesday, April 21

**Committee Meeting— Executive Committee (Geneva); 2:00 PM—6:00 PM**

**Registration (International Tower Lobby); 4:00 PM—6:00 PM**

## Thursday, April 22

**Committee Meeting— Publications Committee (Geneva); 7:30 AM—8:30 AM**

**Committee Meeting— Executive Committee (Geneva); 8:30 AM—11:00 AM**

**Book Exhibit (Grand Hall East); 8:00 AM—5:00 PM**

**Registration (International Tower Lobby); 8:00 AM—5:00 PM**

**Committee Meeting— Finance Committee (Geneva); 12:00 PM—1:00 PM**

**Graduate Student Reception (Max Legers, 320 Peachtree St.); 6:00 PM—9:00 PM**

**Dinner with the Committee on Sociology in Community and Small Colleges; 6:30 PM meet in the lobby of the conference hotel**

**SWS-South Silent Auction (Cairo); 7:30 PM—8:30 PM**

**SWS-South Business Meeting (Cairo); 8:30 PM—9:30 PM**

## Thursday, April 22, 9:00 AM—10:30 AM

### **1. Panel Session— Incorporating Documentaries into the Classroom (Grand Hall B)**

**Presider:** Beth L. Davison, Appalachian State University

In this workshop, we will discuss (1) the technological resources needed to promote short scholarly documentary projects in the classroom; (2) demonstrate the basic knowledge and skills that are needed to guide student projects; and (3) discuss how to ensure the productions reflect scholarly work.

- Beth L. Davison, Appalachian State University (davisonb@appstate.edu)
- Tom S. Hansell, Appalachian State University (hansellts@appstate.edu)

### **2. Paper Session— Difficulties of Fighting Power (Manila)**

**Presider:** Alison E. Adams, Oklahoma State University

- **ODUM UNDERGRADUATE STUDENT PAPER AWARD—**“*Sometimes You Have to Sell Your Soul a Little Bit*”: *Maintaining Meaning and Identity in the Midst of Non-Profit Politics*, Jessica Herbst, Southwestern University (herbstj@southwestern.edu)
- *The Role of Countermovements in Shaping Protest: Public Barriers to Civil Society in a Democratizing Nation*, Alison E. Adams, Oklahoma State University (alison.adams@okstate.edu); Thomas E. Shriver, Oklahoma State University
- *Cycles of Repression and Tactical Innovation: Environmental Dissent in Communist Czechoslovakia*, Thomas E. Shriver, Oklahoma State University (tom.shriver@okstate.edu); Alison E. Adams, Oklahoma State University
- *Centro Civico or Subsidized Food? Contradictions in the Venezuelan Community Council Movement and the Implications for Participatory Democracy*, Rebecca Annice Hanson, University of Georgia-Athens (beccara606@gmail.com)

### **3. Paper Session— Environmental Attitudes, Behaviors, and Policies (Montreal)**

**Presider:** Michelle Petrie, University of South Carolina Aiken

- *Racial Differences in Perceived Environmental Threat: Testing the Hierarchy of Needs*, Michelle Petrie, University of South Carolina – Aiken (michellepetrie@yahoo.com); James Coverdill, University of Georgia
- *Justice for All? The Effects of Previous Behavior, Political Liberalism, and Identity on Perceptions of Green and Environmental Injustice*, Christie Parris, Emory University (christieparris@yahoo.com)
- *Environmental Attitudes and Behaviors of South Carolina Residents: The Role of Geographic Location versus Sociodemographic Characteristics*, Catherine Mobley, Clemson University (camoble@clemson.edu); James Witte, George Mason University; Katie Giacalone, Clemson University Restoration Institute
- *The Opinion-Policy Relationship: Explaining Inter-Country Similarities and Differences in Environmental Policy*, Alicia A. Weaver, Birmingham-Southern College (aweaver@bsc.edu)
- *Traveling by Bicycle in Charleston South Carolina: An Examination of How Utility Cyclists Utilize an Insider/Outsider Framework to Make Sense of Risks*, Deborah M. McCarthy, College of Charleston (mccarthyd@cofc.edu)

### **4. Paper Session— Gender and Leisure (Grand Hall C)**

**Presider:** Frances L. Shupe, University of Louisville

- *Impact of Work and Family on Woman who Cease Illicit Drug-use*, Rachel J. Coonce, University of Louisville (rjcoon01@louisville.edu)
- *Demoralizing Effects on Female Athletes from Lack of Public and University Support*, Keith J. Prager, University of Louisville (kjprag01@louisville.edu)
- *Reflections from Roads' Scholars: A Discussion of the Pros and Cons of a Decade of Research on Touring Motorcyclists*, Patricia L. Gagne, University of Louisville (gagne@louisville.edu); Mark Austin, University of Louisville
- *Good Jobs, Good Deeds: The Gender-specific Influences of Job Characteristics on Volunteering*, Hiromi Taniguchi, University of Louisville (hiromi.taniguchi@louisville.edu)
- *K-12 Funding of Athletics and District-Level Academic Performance by Gender*, Russell E. Ward, Jr., Francis Marion University (rward@fmarion.edu)

**Discussant:**

Frances L. Shupe, University of Louisville (flshup01@louisville.edu)

### **5. Paper Session— Gendered Bodies, Discourses, and Identity (Brussels)**

**Presider:** Leia K. Cain, East Carolina University

- *“No, I’m Not Hiding a Bomb Under There”: The Practice of Veiling Among Young Muslim Women in Metropolitan Atlanta*, Renu Urvashi Sagreiya, Agnes Scott College (rsagreiya@agnesscott.edu)
- *Frequently Abused Gender Discourse*, Bradford Emory White, University of Alabama at Birmingham (bew89@uab.edu)
- *The Aggregation of Symbolic Interactionism and Gender Construction in a Family Setting*, Leia K. Cain, East Carolina University (leia.cain.davenport@gmail.com)

## **6. Paper Session— Health: Institutional Contexts and Individual Consequences (Hong Kong)**

**Presider:** Kenneth Hudson, University of South Alabama

- *The Relationship Between Childhood Obesity and Social Competence*, Sandra L. Jackson, Emory University (sljack3@emory.edu); Solveig A. Cunningham, Emory University
- *Fight or Flight: Medical Culture, Social Institutions, and the Response to H1N1 in the U.S. and Japan*, Mari Armstrong-Hough, Duke University (marijean@soc.duke.edu)
- *Disease and the World-System: The Spread of HIV/AIDS throughout China*, Travis F. Whalen, Virginia Polytechnic Institute and State University (tfw115@vt.edu)
- *Valuing Their Voices: HIV/AIDS Activism in an Era of Professionalization and Public Apathy*, Gabriela Uassouf, Dickinson College (uassoufg@dickinson.edu); Dan Schubert, Dickinson College
- *The Impact of Labor Market Segmentation on Access to Health Care in Low Income Neighborhoods: Preliminary Results*, Kenneth Hudson, University of South Alabama (ckhudson@usouthal.edu); Shermeka M. Hawthorne, University of South Alabama; Martha Arrieta, University of South Alabama; Errol Crook, University of South Alabama

## **7. Paper Session— How Globalization Works (Cairo)**

**Presider:** Debarashmi Mitra, Delta State University

- *State, Civil Society, and Human Rights in the Era of Globalization*, Debarashmi Mitra, Delta State University (dmitra@deltastate.edu)
- *Globalization, Infant Feeding, and Rationalization of Motherhood: Comparative Analyses of Interviews with US and Ukrainian Mothers*, Anna A. Rubtsova, Emory University (grubtso@emory.edu)
- *Toward a Theoretical Approach to International Studies*, Lynn D. Nelson, Virginia Commonwealth University (lnelson@vcu.edu)
- *Bridging the Knowledge Divide as a Developmental Challenge for the Less Developed World in the Global Knowledge Economy: Lessons from the Case of China*, Jungwon Yoon, Georgia Institute of Technology (wonnie78@gmail.com)
- *Structural Adjustment in Nicaragua: The Impact on Workers in the Agriculture and Manufacturing Sectors*, Anderson M. Bean, UNC Greensboro (ambean@uncg.edu)

## **8. Paper Session— Innovative Teaching (Vancouver)**

**Presider:** Kris De Welde, Florida Gulf Coast University

- *Musical Sociology*, Roxanne Gerbrandt, Austin Peay State University (gerbrandtr@apsu.edu); Preston Gilmore, Austin Peay State University
- *Local Social Problems in a Global Perspective: A Framework for Teaching*, Miodrag Petrovic, National University of Singapore (misha0001@gmail.com); Deenesh S. Sohoni, The College of William and Mary
- *Greening Service Learning: Teaching Social Justice and Sustainability via a Sociology of Food course*, Kris De Welde, Florida Gulf Coast University (kdewelde@fgcu.edu)
- *Inquiry and Reflection: Helping Students See Their Growth as Thinkers*, Sarah Rusche, North Carolina State University (serusche@gw.ncsu.edu); Kendra J. Jason, North Carolina State University
- *The Implications of Changing Social Processes and Technology on Sociology Course Assessment*, David Hunt, Augusta State University (hdhunt@aug.edu)

## 9. Paper Session— Sociology Through Film (Singapore)

**Presider:** Jean-Anne Sutherland, UNC Wilmington

- *Aesthetic or Movement? Filmic Representations of Social Movement as Ideographic Tools for Learning*, Thomas N. Ratliff, Virginia Polytechnic Institute and State University (tnr07@vt.edu); Karl Precoda, Virginia Polytechnic Institute and State University
- *Using “Promises” to Teach Students about the Israeli-Palestinian Conflict, Cultural Racism, Systemic Racism, and Prejudice Reduction Theories*, Linda M. Waldron, Christopher Newport University (lwaldron@cnu.edu)
- *Cultural Reflections in American Cinema*, Randall Adams, Tennessee Technical University (radams@tntech.edu)
- *The Symbolic Processes of Film: Creating and Sustaining Identities and Emotions*, Joshua Tuttle, UNC Wilmington (jdt6049@uncw.edu)

### **Discussant:**

Jean-Anne Sutherland, UNC Wilmington (sutherlandj@uncw.edu)

## 10. Paper Session— Tests of the Generalizability of Criminological Theory (Grand Hall A)

**Presider:** Jordana N. Navarro, University of Central Florida

- *Sex as a Moderator for the Parenting-delinquency Relationship among Low-income Youth*, Audrey Gossom, Western Kentucky University (audrey.leis@wku.edu); Samantha Roach, Western Kentucky University
- *The Physical Force of Emotionality: Helping Explain Gender Differences in Offending through the Physical and Emotional Responses to Experienced Racial Discrimination*, Mary Bond Edmond, University of Georgia (mbond@uga.edu)
- *Do Criminological Theories of Crime Explain Offending Among Immigrant Populations?*, Jennifer R. Scroggins, University of Tennessee, Knoxville (jscroggi@utk.edu); Wanjun Cui, University of Tennessee, Knoxville
- *Going Cyber: Using Routine Activities Theory to Predict Cyberbullying Experiences*, Jordana N. Navarro, University of Central Florida (jordananavarro@knights.ucf.edu); Jana Jasinski, University of Central Florida
- *Identifying the Psychological Mechanisms that Mediate the Relationship Between Criminal Victimization and Anti-Social Behavior and Substance Use*, Stephen Watts, UGA (swatts@uga.edu)

## 11. Paper Session— The Economic Meltdown: How Outlooks on the Future Shape Risk Perception and Decision Making (Grand Hall D)

**Presider:** Kyle C. Longest, Furman University

- *As Good as Gold: Examining the Cultural Foundations of Risk Aversion in Retirement*, Joel B. McKelvey, Florida State University (jbm06@fsu.edu)
- *Risky Business: Risk Ratings and the Spread of Neoliberal Reforms*, Diogo L. Pinheiro, Emory University (dpinhei@emory.edu)
- *Bringing the State Back In - Again*, Ian M. Taplin, Wake Forest University (taplin@wfu.edu)
- *Surviving in America: Hope and Despair*, Glenn S. Coffey, GSC Legal and Social Consultants (glenn\_coffey@yahoo.com)
- *Socialized to Give: Trajectories of Giving from Adolescence to Young Adulthood*, Kyle C. Longest, Furman University (kyle.longest@furman.edu)

Thursday, April 22, 10:45 AM—12:00 PM

**12. Plenary Speaker: ASA President Evelyn Nakano Glenn (Cairo)**

**Presider:** Angela M. O’Rand, SSS President, Duke University

- *Citizenship: Belonging, Recognition and Rights*, Evelyn Nakano Glenn, University of California, Berkeley

Thursday, April 22, 12:15 PM—1:45 PM

**13. Panel Session— Do You Want to Work at a Small or Community College? (Manila)**

Sponsored by the Committee on Sociology in Small and Community Colleges.

**Presider:** Denise L. Bissler, Randolph-Macon College

- *The Juggling Professor: Balancing Teaching, Service and Professional Responsibilities at a Liberal Arts College*, Daniel Harrison, Lander University (dharrison@lander.edu)
- *The Pressure Is On to Do It All*, Peg Wimmer, Ferrum College (pwimmer@ferrum.edu)
- *Incorporating Research into Sociology Courses at Small Colleges*, Robert H. Freymeyer, Presbyterian College (rhfreym@presby.edu); Barbara E. Johnson, University of South Carolina Aiken
- *Faculty Engagement and Student Research in Small Colleges*, Bennett M. Judkins, Emory and Henry College (bjudkins@ehc.edu); Karen C. Mundy, Lee University

**Discussant:**

Denise L. Bissler, Randolph-Macon College (dbissler@rmc.edu)

**14. Paper Session— Attitudes about Crime and Punishment (Grand Hall D)**

**Presider:** Christopher G. Ellison, University of Texas at Austin

- *God and Punishment: Examining the Relationship between Religiosity and Justice Attitudes*, Stacy Haynes, Mississippi State University (shaynes@soc.msstate.edu); Amy Burdette, Mississippi State University; R. Gregory Dunaway, Mississippi State University
- *Inequality, Heterogeneity, and Punitiveness in 19 Western Nations: A Multi-Level Analysis*, Sarah J. Reed, University of Texas at Austin (sjreed@mail.utexas.edu); Christopher G. Ellison, University of Texas at Austin
- *In Their Own Words: Police Officers Comment on Rape Myth Acceptance*, Amy Dellinger Page, Appalachian State University (pagead@appstate.edu); Hajra Khan, Appalachian State University
- *Alcoholic Behavior Tolerance in the United States: A Study of the National Survey of Drug Use and Health from 1991 to 2008*, Bryant W. Hamby, University of Alabama at Birmingham (bwhamby@uab.edu)
- *Perceptions of Immigrant Criminality*, Deenesh S. Sohoni, The College of William and Mary (dssoho@wm.edu); Tracy W.p. Sohoni, University of Maryland

### **15. Paper Session— Economy, Work, and Community Change (Singapore)**

**Presider:** Barbara Harris Combs, Shorter College

- *Racial Segregation and Volunteering*, Joongbaeck Kim, University of Tennessee (jkim64@utk.edu)
- *Louisiana's Oil and Gas Industry, Demographic Changes, and Metro/Non-metro Differences*, Brett M. Lehman, Louisiana State University (blehma1@tigers.lsu.edu)
- *Push and Pull: Should I Stay or Should I Go?*, Barbara Harris Combs, Shorter College (bcombs@shorter.edu)
- *New Homes! (for the "right" family): Exclusionary Messages in Subdivision Advertising*, Jennifer Heneghan, University of North Florida (jenisean@bellsouth.net)
- *Gentrification of the Rainey Street Neighborhood*, Christina H. Ngo, University of Texas at Austin (christina.ngo@mail.utexas.edu)

### **16. Paper Session— Framing Rhetorics of Social Problems (Cairo)**

**Presider:** James Witte, George Mason University

- *"We can do better!": Shifting the Frame from Disaster to Disability in Atlanta's Movement to End Homelessness, 1981-1989*, William Wyatt Holland, Georgia State University (wwholland@mindspring.com)
- *Language, Power, and Environmental Justice*, Shelby Gilbert, Florida Gulf Coast University (sgilbert@fgcu.edu)
- *Indian Religion and Politics: Frame Analysis and the Case of the BJP*, Damanvir K. Sidhu, University of North Carolina at Charlotte (dksidhu@unc.edu); Scott FitzGerald, UNC Charlotte
- *Surveying TV Weathercasters and Newsroom Directors about their Attitudes and Beliefs Regarding Climate Change*, James Witte, George Mason University (jwitte@gmu.edu); Edward Maibach, George Mason University; Kathy Rowan, George Mason University; Xiaoquan Zhao, George Mason University; Kris Wilson, University of Texas; Joe Witte, George Mason University
- *National Pride and Civic Engagement*, Matthew F. Van Voorhis, University of Florida (mvoorhis@ufl.edu)

### **17. Paper Session— Historical Timing: Socioeconomic Mobility of Racial-ethnic Minorities (Hong Kong)**

**Presider:** Dr. Dorothy E. Everts, University of Arkansas-Monticello

- *The Social Conditions Affecting the Rapid Increase in the Free Black Population in British North America, 1500-1860*, Dr. Dorothy E. Everts, University of Arkansas-Monticello (everts@uamont.edu)
- *Hurdles, Happenstance and Helplessness: Examining Impediments to Employment in a Down Economy*, Jeffrey A. Will, University of North Florida (jwill@unf.edu); Leni Akapnitis, Center for Community Initiatives; Tim Cheney, Center for Community Initiatives; Tracy Milligan, Center for Community Initiatives
- *Lessons for Rebuilding After Major Catastrophe: Addressing the Need for Adequate Post-Disaster Housing on the Road to Permanent Housing*, Dana Greene, North Carolina Central University (dgreene@ncu.edu)
- *The Status of Peoples of the African Diaspora*, Valerie Smith, Florida Gulf Coast University (vsmith@fgcu.edu)

### **18. Paper Session— Identities True and False: Commercial Music as Problematic (Grand Hall B)**

**Presider:** Chip Walton, Lynchburg College

- *“Don’t Call What You’re Wearing an Outfit”*: Stratification and Authenticity in Popular Music, Chip Walton, Lynchburg College (walton.c@lynchburg.edu)
- *Truck Driving Men*, Jason T. Eastman, Coastal Carolina University (jeastman@coastal.edu); Doug Schrock, Florida State University; William Danaher, College of Charleston
- *Seeing Music: The Ability of the Visual to Transmit or Transcend Social Inequality through Music*, Ceaser Donovan, Louisiana State University (donovonc@gmail.com)
- *This Is Your Body on Commercial Radio: Formats, Music and Talk*, Matthew W. Irvin, Eastern Kentucky University (matthew.irvin@eku.edu)

**Discussant:**

Chip Walton, Lynchburg College (walton.c@lynchburg.edu)

### **19. Paper Session— Intersections: Contemporary Culture and Identity (Vancouver)**

**Presider:** Keith T. Kerr, Quinnipiac University

- *Post-Colonials: National Identity and Social Cultural Sense of Place*, Jessie Garcia, University of Texas, Pan Am (jaged1@att.net)
- *Interstitial Differences in Musical Performance: Race and Gender across Musical Singer/Songwriters in NYC Open Mics*, Marcus Aldredge, Iona College (muc@earthlink.net)
- *Smokescreens and Shadows: The Enemy Within*, Ryan Caldwell, Soka University of American (racaldwell@gmail.com); Keith T. Kerr, Quinnipiac University
- *Creating Narcissists: Individuals in Postmodern Culture*, Garrick Harden, Lamar University (crotoan814@yahoo.com)
- *Public Policy, Ethnic Enclaves and Identity: the price for public education*, Lorella Praeli, Quinnipiac University (lorella.praeli@quinnipiac.edu)

**Discussant:**

Keith T. Kerr, Quinnipiac University (keith.kerr@quinnipiac.edu)

### **20. Paper Session— Matters of Life and Lifestyle (Grand Hall C)**

**Presider:** Linda L. Belgrave, University of Miami

- *“Safe and Comfortable”*: Fear of Loss as a Barrier to Smoking Cessation, Aukje K. Lamonica, University of Scranton (lamonicaa3@scranton.edu)
- *Quality Time: An Exploration of Subjective Temporality*, Amy M. Ernestes, University of North Carolina at Greensboro (amernste@uncg.edu)
- *Obesity is the Greatest Risk Among African American College Going Students*, Ghyasuddin Ahmed, Virginia State University (gahmed@vsu.edu)
- *The Meaning of Food among College-aged Women*, Lauren M. Quattromani, University of Miami (laurenquattro@yahoo.com); Linda L. Belgrave, University of Miami
- *Infant Mortality in the World-System: The Cross-National Evidence*, Scott Frey, University of Tennessee-Knoxville (rfrey2@utk.edu); Wanjun Cui, University of Tennessee, Knoxville

## **21. Paper Session— Patients, Families, and Perceptions of Health Care Issues (Montreal)**

**Presider:** Andreas Schneider, Texas Tech University

- *What's in a Name?: Medicalization and Its Discontents*, Steven L. Foy, Duke University (steven.foy@duke.edu)
- *Calorie Restriction and Lay Expertise*, Mark P. Jones, University of Alabama-Huntsville (mpj0004@uah.edu)
- *Turning Pain into Pleasure*, Andreas Schneider, Texas Tech University (andreas.schneider@ttu.edu)
- *Bullying and Autism in South Carolina Schools*, Deborah M. Hanna, University of South Carolina at Aiken (dhanna@usca.edu)
- *Social Capital and Health Information Search*, Lijun Song, Vanderbilt University (lijun.song@vanderbilt.edu); Tian-Yun Chang, Vanderbilt University

## **22. Paper Session— Research on Gender and the Media (Grand Hall A)**

**Presider:** Jaita Talukdar, Loyola University New Orleans

- *Post-Feminism for Children: Exploring Parallel Feminist/Post-Feminist Themes in Bratz and Sex and the City*, Sarah Becker, Louisiana State University (sbecker@lsu.edu)
- *Metrosexuals, Bromance (rs) and Cougars: Shakers or Non-shakers of the Gender Structure?*, Jaita Talukdar, Loyola University New Orleans (jtalukda@loyno.edu)
- *Gender and the School Shooting Media Discourse*, Brian M. Knop, University of Mississippi (bmknop@gmail.com)
- *Strippers, Single Moms, Crack Addicts and Butch Cops: Gender, Sexuality and the Role of Women on HBOs The Wire*, Linda M. Waldron, Christopher Newport University (lwaldron@cnu.edu); Cheryl Chambers, Christopher Newport University
- *Battle of the Sexed & the Sexist: Perceptions of Black Youth Regarding Gender Relations in Rap & Hip-Hop Music*, Erica R. Wallace, Davidson College (erwallace@davidson.edu)

## **23. Paper Session— Sports and Leisure (Brussels)**

**Presider:** Tucker Brown, Austin Peay State University

- *Clever Marketing or Subcultural Mantra: Hegemonic Ideology and Thrasher Magazine Content*, Tucker Brown, Austin Peay State University (brownt@apsu.edu)
- *Assimilation and Recreation: The Construction of Social Identities and Ties through Recreation*, Jonathan W. Harris, East Carolina University (jwh0122@ecu.edu)
- *Creating An Embodied Past: History on the Ground at a Plantation Museum*, Sara F. Mason, Gainesville State College (smason@gsc.edu)
- *A Qualitative Triangulation of Critical Theory, Ethnography, and Tourism*, Jerome R. Clemons, Clemson University (jeromec@clemson.edu)
- *Anomie and Religiosity: Data from 104 Professional Football Players*, Eric Carter, Georgetown College (eric\_carter@georgetowncollege.edu); William Samson, Georgetown College

**Thursday, April 22, 2:00 PM—3:15 PM**

## **24. Plenary Speaker: Arne Kalleberg (Cairo)**

**Presider:** Vincent Roscigno, SSS President-Elect, Ohio State University

- *Socializing Risk: The Promise of Flexicurity*, Arne Kalleberg, University of North Carolina, Chapel Hill

## **25. Panel Session— Public Sociology and the Classroom: Variations on a Theme (Montreal)**

**Presider:** Kristin L. Marsh, University of Mary Washington

This session is designed to facilitate interactive exploration of what we mean by public sociology in our teaching—including the benefits and challenges.

- Leslie Martin, University of Mary Washington (lmartin@umw.edu)
- Tracy Citeroni, University of Mary Washington (tciteroni@umw.edu)
- Kristin L. Marsh, University of Mary Washington (kmarsh@umw.edu)

**Discussant:**

Kristin L. Marsh, University of Mary Washington (kmarsh@umw.edu)

## **26. Paper Session— “Like a Virgin”: Research on Adolescent Sexuality (Singapore)**

**Presider:** Yanyi K. Djamba, Auburn University at Montgomery

- *Romance Wraps It, Lust Taps It?*, Nichols M. Neblett, Emory and Henry College (nneblett06@ehc.edu)
- *Assessing Intervening Variables that contribute to Efficacy of Abstinence-Only and Comprehensive Sex Education Programs for High School Students*, Demetrice D. Tuttle, LaGrange College (ddtuttle@lagrange.edu); Baozhen Luo, LaGrange College
- *Gender Differences and Determinants of Premarital Sex Among Never Married Teenagers in 18 African Countries*, Yanyi K. Djamba, Auburn University at Montgomery (ydjamba@aum.edu); Sitawa R. Kimuna, East Carolina University

## **27. Paper Session— Doing Sociology: Reflections, Methods, and More (Grand Hall A)**

**Presider:** Stephen J. Sills, University of North Carolina Greensboro

- *Research Record Keeping: Best and Actual Practices*, Kenneth R. Wilson, East Carolina University (wilsonk@ecu.edu); Alan A. Schreier, East Carolina University; David Resnik, Nih/niehs; Amanda Drozdowski, East Carolina University
- *Seeing the Social World: A Review of Visual Sociology Methods*, Stephen J. Sills, University of North Carolina Greensboro (sjsills@uncg.edu); Aneliese Dar, University of North Carolina Greensboro
- *Utilizing Facebook for Online Focus Groups*, Jean S. Humphreys, Dallas Baptist University (jean@dbu.edu)
- *Walking the Walk vs. Talking the Talk: A Comparative Analysis of the ASA and ASPA Ethics Initiatives*, Thomas P. Dunn, Troy University (tpdunn@troy.edu); Manfred F. Meine, Troy University

## **28. Paper Session— Social Movements (Manila)**

**Presider:** Markus Hadler, Marshall University

- *Reactions to Economic Change*, Jeff McKay, Marshall University (mckay9@marshall.edu); Markus Hadler, Marshall University
- *Structural and Cultural Impediments to Afro-Brazilian Mobilization*, Richard Garnett, Marshall University (garnett@marshall.edu)
- *Negative Social Movements and their Effect on Society*, Zachary Watford, Marshall University (zack.watford@gmail.com)
- *A Synthetic Analysis of the Polish Solidarity Movement: How Solidarnosc Achieved and Maintained Social Solidarity*, Steven Mays, Marshall University (s.wm@hotmail.com)

**Discussant:**

Richard Garnett, Marshall University (garnett@marshall.edu)

### **29. Paper Session— Space and Stratification, Place and Portability: Healthcare, Language, and Transportation (Vancouver)**

**Presider:** Matthew W. Hughey, Mississippi State University

- *English or Spanish? Characteristics of Latino Immigrant's English Proficiency and Migration Patterns*, Maggie Bohm, Mississippi State University (myb20@msstate.edu)
- *Access to Healthcare and Mortality: Does Income Inequality Matter?*, Jamie Boydston, Mississippi State University (jamie.boydstun@ssrc.msstate.edu)
- *Road Infrastructure and African Americans in the Post-Civil Rights Period: A Case Study of Milwaukee, Wisconsin*, Paul A. Gilbert, Mississippi State University (pag76@msstate.edu); Guangqing Chi, Mississippi State University
- *The Influence of Countries Median Income on Individual Quality of Life*, Sean Coleman, Virginia Tech / RTI International (cu\_sean@yahoo.com); Charles Walter, Virginia Polytechnic Institute and State University; Njeri Kershaw, Virginia Polytechnic Institute and State University

**Discussant:**

Matthew W. Hughey, Mississippi State University (mhughey@soc.msstate.edu)

### **30. Paper Session— Technology and Identity/Role (Grand Hall D)**

**Presider:** Jennifer R. Scroggins, University of Tennessee, Knoxville

- *Virtual Identities*, Sarah Ballard, University of Alabama at Birmingham (balsr@uab.edu)
- *Interaction Ritual: Social Cohesion and New Technology*, Meisha Wilkinson, Lee University (mwilki00@leeu.edu)
- *WoW: I Have No Friends*, Melanie L. Fryman, Middle Tennessee State University (melanie@frymanet.com)
- *Armed and Entertained: The Use of Technology among On-Duty Police Officers*, Jennifer R. Scroggins, University of Tennessee, Knoxville (jscroggi@utk.edu)

**Thursday, April 22, 3:30 PM—5:00 PM**

### **31. Paper Session— Discrimination, Disparities, and Social Reproduction (Hong Kong)**

**Presider:** K Jill Kiecolt, Virginia Polytechnic Institute and State University

- *The Darker Side of Discrimination: Exploring the Effects of Discrimination on African American Mental Health*, Sunshine Rote, Florida State University (srote@fsu.edu); Byron A. Miller, Florida State University; Verna M. Keith, Texas A&M University
- *The Hidden Injuries of Racial Employment Discrimination: A Qualitative Analysis of Depression and Psychological Distress*, Lisette M. Garcia, New York University (lisette.garcia@nyu.edu)
- *Where Are All the Black Male Students? African Americans' School Achievement, the Social Psychology of Denial, and Arts Education as a Mediating Influence*, Calvin W. Walton, UNC Charlotte (calvin.walton@cms.k12.nc.us); Greg Wiggan, UNC Charlotte
- *Does the Sense of Control Buffer or Exacerbate the Effects of Stressors on Distress?*, Michael Hughes, Virginia Polytechnic Institute and State University (mdh@vt.edu); K Jill Kiecolt, Virginia Polytechnic Institute and State University; Verna M. Keith, Texas A&M University
- *The Nature of Social Reproduction: Genes and Environments in Social Mobility*, Francois Nielsen, U. of North Carolina -- Chapel Hill (francois\_nielsen@unc.edu)

### **32. Paper Session— Expanding Disasters: Directions for the Sociology of Disaster (Grand Hall B)**

**Presider:** Daniel Harrison, Lander University

- *The Bridge to Somewhere: How Government Funding Mitigates the Cost of Disaster.*, Dustin Gourdin, Furman University (dustin.gourdin@furman.edu)
- *The Disaster at El Mozote*, Sally Morris, Furman University (sallymorris1141@furman.edu); Paul Kooistra, Furman University
- *Space, Sentiment, and Social Structure after Disasters: Toward a Theory of Recovery*, James Hawdon, Virginia Tech (hawdonj@vt.edu); John Ryan, Virginia Tech
- *A City at Risk: New Orleans Before and After Disaster*, Carl L. Bankston, Tulane University (cbankst@tulane.edu)

**Discussant:**

Daniel Harrison, Lander University (dharrison@lander.edu)

### **33. Paper Session— From Global Crisis to Global Alternatives? Part 1: Dominant and Challenging Ideologies (Grand Hall C)**

**Presider:** Jon D. Shefner, University of Tennessee

- *Whose World's at Risk? The Roles of New Class Intellectuals in Defining Alternatives to Globalization*, Meghan Conley, University of Tennessee (mconley2@utk.edu)
- *The Implications of Non-problems: The Framing of Coal*, Elizabeth East, University of Tennessee (east2@utk.edu)
- *Contested Globalizations*, Alex Stoner, University of Tennessee (astoner1@utk.edu)
- *Emerging Ideological Models of Alternative Globalization*, Tobin Walton, University of Tennessee (twalton1@utk.edu)

**Discussant:**

Jon D. Shefner, University of Tennessee (jshefner@utk.edu)

### **34. Paper Session— Gender Roles in Public and Private Spheres (Singapore)**

**Presider:** Gayle Kaufman, Davidson College

- *Bearing Children, Becoming Women: The Influence of Childbearing on Women's Gender Ideology*, Shannon N. Davis, George Mason University (sdavis@gmu.edu); Sara B. Moore, George Mason University
- *"I Am My Kids' Father": Transition to Fatherhood, Family Leave, and Changes in Men's Work-family Attitudes*, Gayle Kaufman, Davidson College (gakaufman@davidson.edu)
- *The Division of Domestic Work among Older couples in China*, Hanyao Qiu, University of Florida (hyqiu@ufl.edu)
- *Social Class, Gender Ideology, and Child Care Choices*, Rachel A. Sebastian, University of Cincinnati (sebastrl@mail.uc.edu)
- *The Determinants of Attitudes toward Family Leave Policy*, Caroline May, Samford University (cemay@samford.edu)

### **35. Paper Session— Health and Health Care: Professional and Lay Perspectives (Brussels)**

**Presider:** Erika L. Austin, University of Alabama at Birmingham

- *Right or Privilege? Health Care Reform In America*, Michael Ndofor, Kennesaw State University (mndofor@students.kennesaw.edu)
- *Does Virtue Vanish Among Medical Students Over Time?*, Catherine Harris, Wake Forest University (harris@wfu.edu); Michael Wise, Appalachian State University
- *Lesbian Womens Disclosure of Sexual Identity to Health Care Providers*, Erika L. Austin, University of Alabama at Birmingham (elaustin@uab.edu)
- *Lay Perspectives on Mental Health: Ghanaian Women talking about their Mental Health Status*, Joyce Y. Avotri Wuaku, Nova Southeastern University (ja840@nova.edu)
- *Impacts of Medical Error on Members of the Family*, Linda A. Treiber, Kennesaw State University (ltreiber@kennesaw.edu)

### **36. Paper Session— Identity and Emotion (Grand Hall A)**

**Presider:** James M. Thomas, University of Missouri

- *When Emotions Endure: In Search of Conditions for Moods in Affect Control Theory*, Long Doan, Indiana University (longdoan@indiana.edu)
- *Understanding the Experiences of Peer Health Workers: Identity, Role Conflict, and Emotions*, Brandy Farrar, North Carolina State University (bfarrar@schsr.unc.edu)
- *Identity Confirmation and Emotion among Nurses: A Test of Competing Predictions from Affect Control Theory and Identity Theory*, Tiffani Everett, University of Georgia (teverett@uga.edu)
- *Comedy, Affect, and the Politics of Emotion*, James M. Thomas, University of Missouri (jmt552@mail.mizzou.edu)

### **37. Paper Session— Network Context, Crime, and Fear of Crime (Vancouver)**

**Presider:** Shaun Thomas, University of Arkansas – Little Rock

- *Network Context and Fear of Crime*, Edward S. Shihadeh, Louisiana State University (edsoc@lsu.edu); Brett M. Lehman, Louisiana State University; John J. Beggs, Louisiana State University; Jeanne S. Hurlbert, Louisiana State University
- *Collective Efficacy and Informal Social Control: Their Effects of Domestic Violence*, Cathy Colwing, Campbell University (cowlingc@campbell.edu)
- *Arguments or Felonies: Analyzing the Role of Contextual Environments in Predicting Motivations to Commit Assault*, Shaun Thomas, University of Arkansas – Little Rock (sathomas@ualr.edu)
- *The Social Ecology of Sex Crimes*, Brittany Mays, Southern Wesleyan University (brittany.mays@mail.swu.edu)
- *Deviance within a Hotel Community*, Njeri Kershaw, Virginia Polytechnic Institute and State University (nkershaw@vt.edu)

### **38. Paper Session— Sexuality Research (Cairo)**

**Presider:** Ashley M. Volion, University of New Orleans

- *Researching Sex Work: Oppositional Paradigms and Suggestions for a More Complete Picture*, Summer Wisdom, East Carolina University (ssw1128@ecu.edu)
- *Sexual Scripts and Communication at Women's Sex Toy Parties*, Kaitlin M. Boyle, UNC Charlotte (kboyle4@uncc.edu)
- *Stained Leather and the Social Containment of Gender Diversity: A Response to Colleague Anxieties of Violence Between Kinky Subjects*, David J. Laporta, Georgia State University (laportad@gmail.com)
- *(De)Centering Sexuality: Narratives of the Physically Disabled Woman and Self-Identifying as a Sexual Being*, Ashley M. Volion, University of New Orleans (amvolion@uno.edu)

### **39. Paper Session— Social Construction of Race (Manila)**

**Presider:** Brigitte U. Neary, University of South Carolina Upstate

- *Race in Context: Navigating Contradictory Understandings of Race*, Naadiya Hasan, Guilford College (naahasan@yahoo.com)
- *The Privilege of Not Being German: Unpacking the Social Construct*, Brigitte U. Neary, University of South Carolina Upstate (bneary@uscupstate.edu)
- *Black Narratives and Narratives of Blacks: A Content Analysis of the Death of Michael Jackson*, Marshica Stanley, University of North Carolina at Greensboro (m\_stanle@uncg.edu)
- *Dilemmas of Black Manhood: Respect and Compensation among Black College Men*, Brandon A. Jackson, Florida State University (bajackson@fsu.edu)

### **40. Paper Session— Sociology of Religion (Grand Hall D)**

**Presider:** Donald A. Nielsen, College of Charleston

- *Social Sources of Church-based Social Support among Working-Age Adults*, Andrea Henderson, University of Texas at Austin (henda@mail.utexas.edu); Jennifer Storch, University of Texas-Austin; Christopher G. Ellison, University of Texas at Austin
- *Religious Switching and Ethnicity*, Darren E. Sherkat, Southern Illinois University (sherkat@siu.edu)
- *Religious Foundations of Society: A Russian View from the Work of Fyodor Dostoevsky*, Donald A. Nielsen, College of Charleston (niensend@cofc.edu)
- *Women's Perceptions of Leadership Roles within a Southern Baptist Congregation*, Tina C. Hook, Georgia Southern University (thook@georgiasouthern.edu)
- *Observations on Modern American Paganism*, Shannon K. Bailey, University of Central Florida (shannonkbailey@gmail.com)

### **41. Paper Session— Teaching Sociology Through Film (Montreal)**

**Presider:** Jean-Anne Sutherland, UNC Wilmington

- *Pleasantville: Power and the Social Construction of Reality*, Sarah Rusche, North Carolina State University (serusche@gw.ncsu.edu)
- *Movies: An Instructional Device for Teaching Childhood*, Ida H. Simpson, Duke University (isimp@soc.duke.edu)
- *Using Film to Teach Theories of Crime*, Rebecca Bach, Duke University (rbach@soc.duke.edu)
- *Teaching the Paradoxical Nature of Modern Society: The Matrix Trilogy, Cognitive Dissonance, and Societal Contradictions*, Harry F. Dahms, University of Tennessee, Knoxville (hdahms@utk.edu)

**Discussant:**

Jean-Anne Sutherland, UNC Wilmington (sutherlandj@uncw.edu)

**42. Panel Session— Center for the Study of Social Justice (Brussels)**

**Presider:** Stephanie A. Bohon, University of Tennessee, Knoxville

A session about the newly created interdisciplinary research center at the University of Tennessee, Knoxville, housed in the Department of Sociology: goals, purpose, composition, and agenda. Panel participants are directors of the Center.

**Discussants:**

- Stephanie A. Bohon, University of Tennessee, Knoxville (sbohon@utk.edu)  
Scott Frey, University of Tennessee, Knoxville (rfrey2@utk.edu)  
Harry F. Dahms, University of Tennessee, Knoxville (hdahms@utk.edu)

**43. Panel Session— The Pros and Cons of Working at a Community College (Singapore)**

Sponsored by the Committee on Sociology in Community and Small Colleges.

**Presider:** Denise L. Bissler, Randolph-Macon College

- *The Pleasures and Pains of Marrying into the “Family” of a Small College*, Casey Welch, Flagler College (welchsociology@yahoo.com)
- *Opportunities and Challenges for Faculty Teaching at Two-Year Institutions*, Leonda Keniston, John Tyler Community College (lkeniston@jtcc.edu)
- *Teaching at Junior and Senior Two-Year Colleges: A Comparison*, James H. Gadberry, Athens State University (james.gadberry@athens.edu)

**Discussant:**

Denise L. Bissler, Randolph-Macon College (dbissler@rmc.edu)

**44. Paper Session— Expanding Disasters: Directions for the Sociology of Disaster 2 (Grand Hall B)**

**Presider:** Lee Clarke, Rutgers University

- *Katrina Cassandras: Voices of Experts Who “Knew”*, Lee Clarke, Rutgers University (lbclarke@gmail.com); Harvey Molotch, NYU
- *The Impact of the Martin County Coal Waste Disaster after Nearly Ten Years: Local Perspectives*, Shaunna Scott, University of Kentucky (shaunna.scott@uky.edu); Stephanie McSpirit, Eastern Kentucky University
- *Tsunami, Women’s Movements and Syariah Law in Aceh: How Does Disaster affect Gender Relations?*, Siti Kusujarti, Warren Wilson College (skusujia@warren-wilson.edu)
- *Disaster and the Mixed-Blessings of Citizenship: San Francisco 1906 and New Orleans 2005*, Steve Kroll-Smith, UNC-Greensboro (s\_krolls@uncg.edu)
- *Long-Term Disinvestment in Social Reproduction and its Consequences for Front Line Workers in the Aftermath of Hurricane Katrina*, Lynn Weber, University of South Carolina (weberl@mailbox.sc.edu); Christina Griffin, University of South Carolina

#### **45. Paper Session— Frame Analysis and Social Movements (Cairo)**

**Presider:** Josh R. Adams, SUNY Fredonia

- *Conditions and Framing: The Case of the Contemporary Anti-Human Trafficking Movement*, Marguerite Hernandez, The Ohio State University (margueritehernandez@gmail.com)
- *Frame Disputes within the Autism Movement*, Caroline Jeanette Schierle, UNCC (schierlec@gmail.com); Scott FitzGerald, UNC Charlotte
- *Strategic Framing as Mobilizing Strategy: The Case of the Anti-witch Hunt Campaigns in the Tea Plantations of India*, Soma Chaudhuri, Michigan State University (chaudh30@msu.edu); Anuradha Chakravarty, University of South Carolina - Columbia
- *Tea Parties, Framing Processes, and Contemporary Conservative Movements*, Josh R. Adams, SUNY Fredonia (adamsj@fredonia.edu)

#### **46. Paper Session— From Global Crisis to Global Alternatives? Part 2: States, Place, and Policy (Grand Hall C)**

**Presider:** Jon D. Shefner, University of Tennessee

- *Gentrified Globalization: Neoliberal Impacts on the City*, Katherine Morris, University of Tennessee (kmmorris1@utk.edu)
- *New Developmentalism or Social Neoliberalism? The Changing Role of the State in Contemporary Latin America Political Economy*, Aaron Rowland, University of Tennessee (arowlan3@utk.edu)
- *U.S. Foreign Policy in Latin America: What do you do with a problem like Zelaya?*, William Taylor, University of Tennessee (wtaylor25@utk.edu)
- *Two Giants on the World Stage: A Look at the Emerging, Multifaceted Relationships Between The United States and China*, Shane M. Willson, University of Tennessee, Knoxville (swillson@utk.edu)

**Discussant:**

Jon D. Shefner, University of Tennessee (jshefner@utk.edu)

#### **47. Paper Session— Qualitative Research on Crime and the Criminal Justice System: Drugs, Courts and Jail (Grand Hall D)**

Sponsored by the Florida State University Qualitative Research Group.

**Presider:** Miriam R. Sessions, Florida State University

- *Relationality and Identity Migration Among Methamphetamine Users: An Exploratory Study*, Paul Frederick Boshears, The European Graduate School (paul.boshears@gmail.com)
- *The Social Construction of Methamphetamine in the Print Media: A Content Analysis of the Los Angeles Times and the Boston Globe, 2000-2002*, Teresa Roach, Florida State University (tar09c@fsu.edu)
- *The Work of Professional Staff in Drug Court*, Mitchell B. MacKinem, Claflin University (mmackinem@claflin.edu); Paul Higgins, University of South Carolina
- *Like Mother, Like Daughter: Insights into Family and Crime through Life Histories of a Mother and Daughter Sharing Jail Time*, Roma Stovall Hanks, University of South Alabama (rhanks@usouthal.edu); Nicole T. Carr, University of South Alabama

#### **48. Paper Session— Social Control: Multiple Forms and Contexts (Manila)**

**Presider:** Bradley Campbell, California State University, Los Angeles

- *On Aggressive Suicide in Modern Society*, Jason P. Manning, University of Virginia (jpm4y@virginia.edu)
- *False Reports of Crime*, Bradley Campbell, California State University, Los Angeles (bcampbe3@calstatela.edu)
- *Social Control in a Virtual Group: The Case of Wikinews*, Craig Spurrier, University of South Carolina Columbia (ctspurrier@usca.edu); Trudy Knicely Henson, University of South Carolina Aiken
- *The Police Shooting of Jeffrey Key: Why was there no race riot in Whitley, Georgia?*, Bonnie Semora, University of Georgia Athens (bsemora@gmail.com)
- *Homeland Security: Institutionalization and Police*, Darwin Ramsey, University of Tennessee Martin (dramsey@utm.edu)

#### **49. Paper Session— Social Psychology: Race and Identity (Hong Kong)**

**Presider:** Douglas L. Kuck, University of South Carolina Aiken

- *Happiness and Perceived Trust, Helpfulness, and Fairness in Others: Differences in Black and White*, Douglas L. Kuck, University of South Carolina Aiken (dougk@usca.edu); Danielle Dickenson, University of South Carolina Aiken
- *Examining Links between Discrimination and Depression among African Americans: The Moderating Influence of Racial Identity*, Ellen M. Granberg, Clemson University (granber@clemson.edu); Ronald L. Simons, University of Georgia
- *Race Status Beliefs*, Lisa Rashotte, UNC Charlotte (lrashott@uncc.edu); Tonya K. Frevert, UNC Charlotte
- *Beyond Buford Highway: Immigrants and Atlanta's Racial Geography*, Regine O. Jackson, Emory University (rojacks@emory.edu)

#### **50. Paper Session— Studies of Popular Culture (Grand Hall A)**

**Presider:** Deeb P. Kitchen, University of Florida

- *Towards a Modern Bohemian Movement: An Examination of Contemporary Bohemian Models through Webers Ideal Type*, Nathanael E. Dryden, Belmont University (drydenn@pop.belmont.edu)
- *Examining Race in the Marvel Comics Universe*, David F. Steele, Austin Peay State University (steeled@apsu.edu); Sherry Nowack, Austin Peay State University
- *Consuming Sexual Liberation in South Park*, Deeb P. Kitchen, University of Florida (deebp@ufl.edu)
- *Homosexuality in Religious and Secular Literature*, Mandi Nicole Barringer, University of Central Florida (m.barringer@knights.ucf.edu); Steve Knauss, SUNY Binghamton; Ryan T. Cragun, University of Tampa

### **51. Paper Session— Teaching Criminology and Criminal Justice: Special Issues (Vancouver)**

**Presider:** Michelle Emerson-Lewis, Metropolitan State College of Denver

- *Teaching Criminology with the News*, Brad Tripp, Winthrop University (trippb@winthrop.edu); Jeannae Richardson, Winthrop University
- *Critical Race Perspectives in Criminal Justice*, Bernadette J. Holmes, Norfolk State University (bjholmes@nsu.edu); Micheal Fischer, Norfolk State University; Doris Edmonds, Norfolk; Carla Miller-Ardila, VA Tech
- *Graduate Education in Criminal Justice: Student Perspectives on Race and Justice*, Antonio Brown, Norfolk State University (a.d.brown@nsu.edu); Mario Dacosta, Norfolk State University; Nathaniel Chisholm, Norfolk State University; Samuel Jefferson, Norfolk State University
- *Getting the Point Across: Why She Does Not Leave*, Michelle Emerson-Lewis, Metropolitan State College of Denver (memerson@kennesaw.edu)

### **52. Paper Session— The Intersections of Gender and Sexuality (Montreal)**

Sponsored by Sociologists for Women in Society – South.

**Presider:** Brandy L. Simula, Emory University

- *The Feminization of Sexuality Responsibility: Sexing Gender and Gendering Sex*, Amie Hess, Meredith College (hessamie@meredith.edu)
- *Boundaries, Identities and Layers of Belonging in One Latina Lesbian Social Group*, Katie L. Acosta, Tulane University (kacosta1@tulane.edu)
- *Gender, Norms, and Legitimacy: The Effect of Sexual Harassment Policy on Men's Gender Beliefs*, Justine Tinkler, Louisiana State University (jtinkler@lsu.edu)
- *To Catch a Curious Clicker: A Network Analysis of the Online Pornography Industry*, Jennifer A. Johnson, Virginia Commonwealth University (jajohnson3@vcu.edu)

## Friday, April 23

**ASA Chair's Breakfast (Geneva); 7:00 AM—8:00 AM**

**Committee Meeting— Executive Committee (Heritage); 8:00 AM—10:00 AM**

**Book Exhibit (Grand Hall East); 8:00 AM—5:00 PM**

**Registration (International Tower Lobby); 8:00 AM—5:00 PM**

## Friday, April 23, 9:00 AM—10:30 AM

### **53. Panel Session— Radical Sociology in a Time of Crisis and Ambiguity (Hong Kong)**

**Presider:** Linda L. Belgrave, University of Miami

This panel discussion highlights research, teaching, and activism by radical sociologists.

- *Capitalism's War on the American Middle Class: The Case of Kokomo, Indiana*, Wendi Kane, University of Central Florida (wkane@mial.ucf.edu)
- *Another World is Possible! Another U.S. is Necessary!*, Walda Katz-Fishman, Howard University (wkatzfishman@igc.org)
- *The Road from Atlanta to Detroit 2010: The US Social Forum and Local Struggles*, Jerome Scott, League of Revolutionaries for a New America (jerome@ssbuilt.com)
- *Conceptualizing Radical Sociology*, Christian Schlaerth, University of Miami (cschlaerth@miami.edu); John W. Murphy, University of Miami
- *The Struggle for Free Speech in the Classroom and in the Streets*, Linda L. Belgrave, University of Miami (l.belgrave@miami.edu)

### **54. Paper Session— Climate Change: How the Growth Machine and Big Coal Threaten Us All (Grand Hall B)**

**Presider:** Richard N. Hutchinson, Kennesaw State University

- *Fossil Fuels Forever! Anatomy of the Carbon Lobby*, Richard N. Hutchinson, Kennesaw State University (rhutch13@kennesaw.edu)
- *Political Ideology and Support for Modern Institutions as a Means for Solving Environmental Problems*, Geovanny Perez, University of Florida (geovanny.perez@gmail.com)
- *Hogs, Treadmills, and Ecological Rifts: The Environmental Contradictions of Swine Production in North Carolina*, Adam R. Driscoll, North Carolina State University (ardrisc@ncsu.edu); Brett Clark, North Carolina State University
- *Monkey Wrench Politics and Reform Agendas: Towards Challenging the Exploitation of the Treadmill*, Joshua Sbicca, University of Florida (jsbicca@ufl.edu)
- *Coal Combustion Waste in a Risk Society: The Capture of the Environmental Protection Agency*, Robert Todd Perdue, University of Florida (rtperdue@gmail.com)

### **55. Paper Session— Countries and Communities in Transition (Cairo)**

**Presider:** Mitchell B. MacKinem, Claflin University

- *Solidarity in South Africa: Self-Identity and Perceptions of the State*, Alecia D. Anderson, North Carolina State University (adanders@ncsu.edu); Kelly Austin, North Carolina State University
- *Nuremberg, 1945-2010: A City Dealing with its Nazi Past*, Raymond M. Weinstein, University of South Carolina (rayw@usca.edu)
- *A Tale of Two Cities: A Study of Community, Migration Narrative and Recovery Post-Hurricane Katrina in Two Gulf Coast Vietnamese Enclaves*, Vy Thuc Dao, Tulane University (vdao@tulane.edu)
- *The New Plantation Society: Gated Communities in the Coastal South*, William W. Falk, University of Maryland (wfalk@socy.umd.edu); Susan E. Webb, Coastal Carolina University
- *A Natural History of a Drug Neighborhood*, Mitchell B. MacKinem, Claflin University (mmackinem@claflin.edu); Wes Abercrombie, Midlands technical College

### **56. Paper Session— Gender and Education (Manila)**

**Presider:** Koji Ueno, Florida State University

- *Gender in the Classroom: The Mis-Education of Girls*, Chris Rahmings, Florida Gulf Coast University (crahmings@fgcu.edu); Shelby Gilbert, Florida Gulf Coast University
- *Gender and Postsecondary Education: Analyses of Recent Nationally Representative Data*, Melissa B. Cominole, RTI (mcominole@rti.org); Nicole M. Tate, RTI
- *Paving the Gendered Path to Prestige: Individual and School-Level Influences on Academic, Arts, and Service Club Participation*, Elizabeth Stearns, UNC-Charlotte (mestearn@uncc.edu); Elizabeth J. Glennie, RTI
- *Gender-Typed Behaviors and School Adjustment*, Koji Ueno, Florida State University (kueno@fsu.edu); Summer McWilliams, Florida State University
- *Educating Urban Teen Mothers to Succeed in a 21st Century Globalized Economy*, Christine M. Stroble, University of North Carolina at Charlotte (cmstrobl@uncc.edu); Greg Wiggan, UNC Charlotte

### **57. Paper Session— Immigration, Ethnic Segregation, Acculturation, and Crime (Singapore)**

**Presider:** William C. Watkins, University of Central Florida

- *Segregation and Homicide Among Latinos and African Americans. Does Class Matter?*, Michael G. Bisciglia, Southeastern Louisiana University (michael.bisciglia@selu.edu)
- *Immigration and Homicide: Religious Environment and the New Latino Migration*, Lisa J. Winters, Louisiana State University (lisa.winters@gmail.com); Edward S. Shihadeh, Louisiana State University
- *The Immigration-Crime Relationship: An Examination Of Evidence Over Three Decades*, Lesley Williams Reid, Georgia State University (lesleyreid@gsu.edu); Harald E. Weiss, Mississippi State University
- *Immigration Effects on Homicide Offending for Total and Race/Ethnicity-Disaggregated Populations (White, Black, and Latino)*, Ben Feldmeyer, University of Tennessee (bfeldmey@utk.edu); Darrell Steffensmeier, Penn State University
- *Prescription Drug Misuse among Asian Americans*, William C. Watkins, University of Central Florida (wcwatkins@gmail.com); Jason A. Ford, University of Central Florida

### **58. Paper Session— Issues of Gender and Sexuality in Deviance and Crime (Grand Hall D)**

Sponsored by Sociologists for Women in Society – South.

**Presider:** Julie B. Wiest, University of Tennessee

- *Female Roles in Criminal Networks: A Case Study*, Jennifer A. Johnson, Virginia Commonwealth University (jajohnson3@vcu.edu); John D. Reitzel, Virginia Commonwealth University; Nicholas Hauman, Virginia Commonwealth University
- *Moral Panics on the Micro-Level: Explaining the Motivations for Sexual-Orientation Based Hate Crimes*, Nick Guittar, University of Central Florida (nguittar@mail.ucf.edu)
- *Traditional Gender Roles and Court Case Outcomes of Mothers Who Kill Their Children*, Julie B. Wiest, University of Tennessee (jwiest@utk.edu)
- *Correlates of Girls' Involvement in the Juvenile Justice System*, Angela A. Robertson, Mississippi State University (angela.robertson@ssrc.msstate.edu)
- *Differences by Sex? Identifying the Factors Related to Domestic Violence Perpetration*, Janice Clifford, Auburn University (cliffje@auburn.edu)

### **59. Paper Session— Popular Culture/Media (Grand Hall A)**

**Presider:** Daniel Taylor Buffington, UNC-Wilmington

- *A South in the North: Emplacing the South in the American National Myth*, Daniel Taylor Buffington, UNC-Wilmington (buffingtond@uncw.edu)
- *Grappling with Mortality: The Presentation of Death in Professional Wrestling*, Cenate Pruitt, Georgia State University (cenate\_pruitt@comcast.net); Bryce J. McNeil, Georgia State University
- *Culture Work: Creating Meaning in Weddings and Commitment Ceremonies*, Emily Fairchild, New College of Florida (efairchild@ncf.edu)
- *How Money Buys Love: The Rise of Economic Legitimacy of American Daytime Soap Operas, 1930-2009*, Melissa C. Scardaville, Emory University (mcarda@emory.edu)
- *Economic Recession/Great Depression: Parallel Lines?*, Joey Brown, University of Mississippi (jdbrown4@olemiss.edu)

### **60. Paper Session— Qualitative Identity Research: Identity Conflicts and Constructing Collectives (Grand Hall C)**

Sponsored by the Florida State University Qualitative Research Group.

**Presider:** Miriam R. Sessions, Florida State University

- *They Forgot Where They Came From: The Treatment of the Currently Homeless by the Formerly Homeless*, Amy Donley, University of Central Florida (adonley@mail.ucf.edu); Rae Taylor, Loyola University New Orleans
- *The Homeless "Problem" and the Double Consciousness*, Jason Adam Wasserman, Texas Tech University (jason.wasserman@ttu.edu); Jeffrey M. Clair, University of Alabama at Birmingham; Chelsea Platt, Texas Tech University
- *Constructing the Florida Highwaymen: Complexities and Contradictions in African-American Media Representations*, Amanda Koontz, Florida State University (ajk07j@fsu.edu)
- *"Were all Rats!": Collective Identity Construction in a Local Theatre Group*, Erica L. Toothman, Florida State University (elt03c@fsu.edu)
- *Constructing Inclusive Congregational Identity in the MCC: An Interactionist Analysis*, J Edward Sumerau, Florida State University (jes08j@fsu.edu)

### **61. Paper Session— Social Class in the U.S. (Lenox)**

**Presider:** William J. Weston, Centre College

- *Managers, Professionals, Intellectuals: The Class Fractions of the College Class*, William J. Weston, Centre College (beau.weston@centre.edu)
- *How to Accurately Interpret a Peer's Social Class: Symbols of Class Status and Presentation of Self in College Students*, Alex Brown, Southwestern University (brown3@southwestern.edu)
- *Poverty in Central Appalachia: A Comparative Study*, Katie Lasalle, Louisiana State University (klasal3@tigers.lsu.edu); Joachim Singelmann, Louisiana State University
- *Social Class Sentiments: Changing Views of the Government and Corporations After an Economic Collapse*, Ted M. Brimeyer, Georgia Southern University (tbrimeyer@georgiasouthern.edu)
- *Bubbles, Busts, and Careers: Lessons from the Dotcom Era*, Amanda K. Damarin, Georgia Tech (amanda.damarin@hts.gatech.edu)

### **62. Paper Session— Solving Teaching Problems (Montreal)**

**Presider:** Dale W. Wimberley, Virginia Polytechnic Institute & State University

- *Shock Education: The Use of Documentaries as a Context for Teaching Theory and Concepts*, Howard Robboy, The College of New Jersey (robboy98@yahoo.com)
- *Successfully Teaching Undergraduate Statistics*, Ferris J. Ritchey, University of Alabama at Birmingham (fritchey@uab.edu)
- *Jumpstarting New Graduate Students Theses in the First Research Methods Course*, Dale W. Wimberley, Virginia Polytechnic Institute & State University (dale.wimberley@vt.edu)
- *Promoting Student Learning by Engaging College Students in an Online Environment*, Celia C. Lo, University of Alabama (clo@ua.edu); Ebony L. Johnson, University of Alabama; Kimberly A. Tenorio, University of Alabama
- *Testing Integrity in Online Sociology Courses: Does the Utilization of "Big Brother" Technology Pass Ethical Muster?*, Thomas P. Dunn, Troy University (tpdunn@troy.edu); Manfred F. Meine, Troy University

### **63. Paper Session— Violence, Poverty, and Loss: Mental Health Effects and Interventions (Vancouver)**

**Presider:** Anastasia S. Vogt Yuan, Virginia Tech

- *Is Mental Illness a Factor in Intimate Partner Abuse in Cohabitation?*, Anwesa Chatterjee, University of Miami (anwesa1985@gmail.com)
- *The Response of Administrators and Instructors in the Orange County, Florida Public High School System to Dating Violence Prevention Programs*, Denise N. Crisafi, University of Central Florida (dcrisafi@mail.ucf.edu)
- *Mental Health Consequences of Intimate Partner Violence among Married Women in Urban Thailand: The Role of Community Engagement*, Xiaohe Xu, University of Texas at San Antonio (xiaohe.xu@utsa.edu); Kent R. Kerley, University of Alabama at Birmingham; Bangon Sirisunyaluck, Maejo University; Zhi Zhang, University of Texas at San Antonio
- *Childhood Poverty and Adults' Mental Health: Exploring Factors of Risk and Resiliency*, Anastasia S. Vogt Yuan, Virginia Tech (avy@vt.edu)
- *To Say We End the Heartache and the Thousand Natural Shocks?: An Exploratory Study of Grief and Loss Among Peers of Suicide Victims*, Tanetta E. Andersson, Case Western Reserve University (tea@case.edu)

**64. Plenary Speaker: George Ritzer (Cairo)**

**Presider:** Angela M. O’Rand, SSS President, Duke University

- *Consuming America: What Have We Done to Ourselves? What Did They Do to Us?*, George Ritzer, University of Maryland

**65. Paper Session— Fighting HIV/AIDS in the African-American Community: A Peer Education Model (Vancouver)**

**Presider:** Maxine S. Thompson, North Carolina State University

- *Community Based Peer Education Model: Description and Obstacles of an HIV/AIDS Project in the African American Community*, Sara Brown, North Carolina State University (sjbrown2@ncsu.edu)
- *Relationship Dynamics and Attitudes towards Condom Use*, Brad Ray, North Carolina State University (brray@ncsu.edu); Julianne Payne, North Carolina State University
- *Know Your Status: Health Literacy, Attitudes, and Beliefs Among African Americans Towards HIV Testing*, Rv Rikard, N.C. State University & N.C. Rural Economic Develo (rvrikard@ncsu.edu)
- *Fear of HIV Testing: Gender and Medical Mistrust*, Maxine Seaborn Thompson, North Carolina State University (mst@ncsu.edu)

**66. Paper Session— From Cradle to Grave: Technology Usage Across the Life Course (Montreal)**

Sponsored by Sociologists for Women in Society – South.

**Presider:** Shelia R. Cotten, University of Alabama - Birmingham

- *XO Laptops, Minority Youth, and Technology Use: Decreasing the Digital Divide or Exacerbating Digital Inequality?*, Timothy Hale, University of Alabama - Birmingham (timhale@uab.edu); Latoya O’Neal, University of Alabama - Birmingham; Shelia R. Cotten, University of Alabama - Birmingham; Casey Borch, University of Alabama - Birmingham
- *The Separate Spheres of Online Health Information Searching: The Influence of Gender and Parenting on Behaviors and Feelings about Searching for Health Information on the Web*, Michael J. Stern, College of Charleston (sternm@cofc.edu); Shelia R. Cotten, University of Alabama - Birmingham; Patricia Drentea, University of Alabama - Birmingham
- *Technological and Engineering Advancements for Older Drivers with Sensory and Motor Impairments*, Shannon O’Connor, University of Maryland at Baltimore (soconnor@epi.umaryland.edu)
- *Connectedness in the Postmodern World: An Assessment of ICT Training with Senior Adults*, Vicki Winstead, University of Alabama - Birmingham (vickiwin@uab.edu); Elizabeth Yost, University of Alabama - Birmingham; Amanda Warr, University of Alabama - Birmingham; Ronald W. Berkowsky, University of Alabama - Birmingham; William Anderson, University of Alabama - Birmingham

**Discussant:**

Shelia R. Cotten, University of Alabama - Birmingham (cotten@uab.edu)

### **67. Paper Session— Gender, Work and Family (Singapore)**

**Presider:** Karen Bean, UNC Charlotte

- *Stay-at-home Parents Doing Gender*, Jamie Gutierrez Dodge, University of Central Florida (jamie@jdc.com)
- *Still a Stalled Revolution? Gender Differences and Determinants of Young Adults Plans for Work and Family*, Sarah Friedman, Emory University (sfried2@emory.edu)
- *Why Do Women Work? A Comparative and Multi-Level Analysis of Work Centrality*, Christy Flatt, Mississippi State University (cf54@msstate.edu)
- *Masculinity, Gendered Division of Labor, and Violence against Women*, Karen Bean, UNC Charlotte (kbbean@uncc.edu)

### **68. Paper Session— Great Raced and Gendered Expectations: The Reproduction of Inequality in the Unlikeliest of Places (Manila)**

**Presider:** Matthew W. Hughey, Mississippi State University

- *Higher Education: Does Educational Attainment Lead to Increased Marijuana Usage?*, Donovan C. Bowers, Santa Fe College (donavan@knights.ucf.edu); Holli Marshall, University of Central Florida
- *Juvenile Offenders in the Criminal Justice System: The Effects of Race on Case Outcomes*, Jacqueline Chavez, Mississippi State University (jacquelinec7@hotmail.com)
- *Access to and Receipt of Addiction Treatment in Mississippi*, Sheena Gardner, Mississippi State University (sheena.gardner@ssrc.msstate.edu)
- *Techniques of Neutralization and Gender: Variations in Frequency and Usage Among College Students*, Lauren Vasquez, Mississippi State University (laurenvasquez13@gmail.com)

**Discussant:**

Matthew W. Hughey, Mississippi State University (mhughey@soc.msstate.edu)

### **69. Paper Session— Identity Research: Gender, Power, and Self in College Communities (Grand Hall D)**

**Presider:** Benjamin D. Albers, Bridgewater College

- *Men and Masculinities: Hegemony and Structured Action Theory*, Jonathan D. Wiley, Bridgewater College (jondwiley@gmail.com)
- *Hooking Up and the College Social Scene: How Men Navigate Friendship, Identity, and the “Real College Experience”*, March A. Ryan, Bridgewater College (mar004@eagles.bridgewater.edu)
- *A Lens on Identity*, Parla Cline, Bridgewater College (pdc002@eagles.bridgewater.edu)
- *“Hi, My Name is Lifeguard”: A Study of Identity in the Workplace*, Sam Beatty, Bridgewater College (sgb003@eagles.bridgewater.edu)

**Discussant:**

Benjamin D. Albers, Bridgewater College (balbers@bridgewater.edu)

## 70. Paper Session— The Impact of Language on Social Identity (Grand Hall A)

**Presider:** Ted M. Brimeyer, Georgia Southern University

- *The Intersections of Political Sociology and Linguistic Theory: Sonia Sotomayor and the Language of Political Identity*, Jamie Steele, Georgia Southern University (jsteele26@gmail.com)
- *How Fox News Builds In-group Cohesion through Prejudiced Speech*, Emily Eisenhart, Georgia Southern University (eeehart@gmail.com)
- *In-group Discrimination Among Hispanic Migrant Workers and Its Effects on Worker Mobilization*, Zulema Ibarra, Georgia Southern University (zulema.ibarra@gmail.com)
- *Russian America: The Role of Transnationalism in Reconstructing and Maintaining Ethnic Tradition in Modern America*, Jessica Brush, Georgia Southern University (jessica\_brush36@hotmail.com)

**Discussant:**

Ted M. Brimeyer, Georgia Southern University (tbrimeyer@georgiasouthern.edu)

**Friday, April 23, 12:15 PM—1:45 PM**

## 71. Panel Session— Experiential Learning in Community College and Small College Sociology Classes (Vancouver)

Sponsored by the Committee on Sociology in Small and Community Colleges.

**Presider:** Caroline Parham, Craven Community College

- *Teaching “The Road to Justice”*, Susan H. Ambler, Maryville College (susan.ambler@maryvillecollege.edu)
- *Teaching about Globalization*, Christine A. Wernet, University of South Carolina Aiken (christinew@usca.edu)
- *Foxfire Methods in Sociology: Student Learning Through Local Ethnography*, Caroline Parham, Craven Community College (whitehec@cravencc.edu)
- *Foxfire Methods in Sociology: Student Learning Through Travel*, Bobbie Brannon, Catawba Valley Community College (bbrannon@cvcc.edu)

**Discussant:**

Caroline Parham, Craven Community College (whitehec@cravencc.edu)

## 72. Paper Session— Climate Change and Environmental Policy: Local, National, and International Contexts (Grand Hall B)

**Presider:** Shanhui Wu, Mississippi State University

- *Climate Change and Adaptation: Conflict and Cooperation in Rural Africa*, Joseph J. Molnar, Auburn University (molnajj@auburn.edu); Emily Stutzman, Auburn University
- *Social Consequences and Spatial Implications of Global Climate Change*, Ronald C. Wimberley, NC State University (wimberley@ncsu.edu)
- *The Intersection of Economy and Ecology: Examining the Link Between County-Level Income and CO2 Emissions*, Todd Matthews, University of West Georgia (tmatthew@westga.edu); Eric Cole, University of West Georgia
- *The Impact of Environmental Organizations on Sustainability*, John Munoz, University of North Carolina at Chapel Hill (jdmunoz@email.unc.edu)
- *Proenvironmental Attitudes and Activities: A Cross-National Analysis*, Shanhui Wu, Mississippi State University (shanhui.wu@gmail.com); Michael Taquino, Mississippi State University; Domenico Parisi, Mississippi State University

### **73. Paper Session— Community, Poverty, and Public Health (Grand Hall C)**

**Presider:** John J. Green, Delta State University

- *Social or Geography?: Explaining Health Disparities Between Rural/Non-rural Areas*, Andrew Miles, Duke University (andrew.miles@duke.edu); Rae Jean Proescholdbell, Duke University Global Health Institute; Eve S. Puffer, Duke University Global Health Institute
- *Crime, Community and Health: An Exploratory Study from the Mississippi Gulf Coast*, John J. Green, Delta State University (greenjj1@gmail.com); Page Logan, Delta State University; Tiffany Guidry, Delta State University; Carley Jefcoat, Delta State University; Anna Kleiner, Southeastern Louisiana University; Jolynn Montgomery, University of Michigan
- *Serving the Poor in a Global Context: A Comparative Case Study of an Urban and a Rural County in North Carolina*, Elizabeth Seale, North Carolina State University (ekseale@ncsu.edu)
- *In My Backyard: Community Crimes Reported by Local Law Enforcement Compared to Crimes Reported by Other Government Agencies*, Natasha M. Davenport, Georgia State University (nmdavenport@gmail.com)
- *Matters of Love and Survival: Romantic Ties and Economic Viability of Low-Income Latin-American Single Mothers*, Bo Hyeong Lee, Duke University (bl40@duke.edu)

### **74. Paper Session— Faces of Violence (Manila)**

**Presider:** Stephen C. Poulson, James Madison University

- *The Logic of Ethnic and Religious Violence in Iraq*, Stephen C. Poulson, James Madison University (poulsos@jmu.edu); Jayna Otonicar, James Madison University; Heather McFarland, James Madison University; Noelle Burgess, James Madison University
- *Terrorism and Religion in the Case Of Al Qaeda*, Mehmet Soyer, Mississippi State University (mehmedsoyer@gmail.com); Ali Can, University of North Texas
- *Toward a Theory of War and Society*, Eric Royal Lybeck, University of Tennessee - Knoxville (elybeck@utk.edu)
- *The Effects the Police Code of Silence has on Corruption*, Brian Middleton, University of Tennessee Martin (briamidd@ut.utm.edu)

### **75. Paper Session— Family Structure: Constraints and Choices (Singapore)**

**Presider:** Tanya Koropecykj-Cox, University of Florida

- *Attitudes about Childlessness and Infertility Treatments: A Comparison of Turkish and American University Students*, Tanya Koropecykj-Cox, University of Florida (tkcox@ufl.edu); Zeynep Copur, Hacettepe University, Ankara, Turkey
- *Divorce of Mom and the level of Children's Depression, Alcoholism, and Criminal Behaviors of Children*, Shyamal K. Das, Fayetteville State University (sdas@uncfsu.edu); Heather Lyons, Fayetteville State University
- *Probability Distribution of Parenting Styles among an African American Population*, Xiaoli Su, University of Georgia (xlyisu@uga.edu); Ronald L. Simons, University of Georgia
- *Left Behind: Deployment Experiences of Military Wives*, Beth A. Easterling, University of Tennessee (beasterl@utk.edu); David Knox, East Carolina University
- *From Stars Hollow to the Classroom: Teaching Marriage and the Family with the Gilmore Girls*, Marie Sheneman, University of South Alabama (mariesheneman@gmail.com)

## 76. Paper Session— New Research in Social Psychology (Lenox)

**Presider:** Matt Wilkinson, Coastal Carolina University

- *Is the Top Really on Top?: Negotiating Power and Consent in BDSM Interactions*, Brandy L. Simula, Emory University (bsimula@emory.edu)
- *Understanding Gender Differences in Self-Esteem among Middle School Students: Perceived Gender Discrimination and Gender Ideology*, Maxine S. Thompson, North Carolina State University (mst@gw.ncsu.edu); Rv Rikard, N.C. State University & N.C. Rural Economic Develo
- *Social Integration and Delinquency: The Buffering Hypothesis*, Matthew E. Wilkinson, Coastal Carolina University (wilkinson21@gmail.com)
- *The Mental and Behavioral Effects of Childhood Abuse*, Shelene Duffe, University of Tennessee Martin (sherduff@ut.utm.edu)
- *The Emotional Labor of Childbirth*, Shannon K. Carter, University of Central Florida (skcarter@mail.ucf.edu)

## 77. Paper Session— Race and Politics (Grand Hall A)

**Presider:** Jomills Henry Braddock, University of Miami

- *Black Population Density and White Voter Support for Barack Obama*, Jomills Henry Braddock, University of Miami (jomills2@bellsouth.net); Hilary Cook, University of Miami; Dana Grace, University of Miami; Paul Madden, University of Miami; Adrienne Milner, University of Miami; Aaron Puhmann, University of Miami
- *“I’m Black and I’m Proud”: A Study of Self-Esteem in African American Communities in the Obama Era*, Demario J. Brantley, Kennesaw State University (dbrant19@students.kennesaw.edu)
- *Taking the Temperature: Is Whites’ Opposition to Government Health Care a Matter of Race?*, Jerry Kaufman, University of Central Florida (jerry.kaufman@knights.ucf.edu)
- *Why Americans Still Hate Welfare: Racial Attitudes, Social Context and Support for the Welfare State*, Ryon J. Cobb, Florida State University (rjc08d@fsu.edu)
- *Popular Rap Music and the National Hip Hop Political Convention: Convergence and Divergence in Political Rhetoric*, Derek Evans, University of Missouri - Columbia (djedz2@mail.missouri.edu)

## 78. Paper Session— Spatial and Temporal Analysis of Crime (Montreal)

**Presider:** Marc Riedel, Southeastern Louisiana University

- *Examining the Elusive Influence of Age Structure on Homicide Rates in Cross Sectional Analyses*, Patty L. McCall, North Carolina State University (patty\_mccall@ncsu.edu); Kenneth C. Land, Duke University; Karen F. Parker, University of Delaware
- *A Macro-Level Analysis of Economic Crime: Institutional Anomie, Opportunity, and Region*, Richard Lee Rogers, Southern Wesleyan University (rrogers@swu.edu)
- *Family Homicides in California, 1987-2008*, Marc Riedel, Southeastern Louisiana University (marcriedel2@charter.net)
- *Changes in the Gender Ratio of DUI Offenders*, Hui Liew, Mississippi State University (hp113@msstate.edu); Angela A. Robertson, Mississippi State University; Sheena Gardner, Mississippi State University
- *The Sociology of Place: A New Understanding of Crime Prevention Through Environmental Design*, Sangmoon Kim, University of North Carolina Wilmington (kims@uncw.edu); Randy Lagrange, University of North Carolina Wilmington; Cecil Willis, University of North Carolina Wilmington

**79. Paper Session— The Uses of Music in the 21st Century: Social Movement, Work, Corporate Taste (Cairo)**

**Presider:** Matthew W. Irvin, Eastern Kentucky University

- *The Music Never Stopped: Subcultural Identity Production in the Jamband Community*, Nate Chapman, Virginia Tech (nchapman@vt.edu)
- *Muslim Punk Rock in the USA: Frustration, Community, and Resistance within Taqwacore*, Sarah S. Hosman, University of North Carolina-Greensboro (sshosman@gmail.com)
- *Work and Group Identity: The Case of Part-time Pop Musicians*, William Danaher, College of Charleston (danaherw@cofc.edu)
- *Pathways to Becoming a Church Musician*, Stephen B. Groce, Western Kentucky University (steve.groce@wku.edu); Lewis A. Groce, St. Timothy Lutheran Church; Rebecca Young, Western Kentucky University
- *Music as a Teaching Tool in Sociology*, Roxanne Gerbrandt, Austin Peay State University (gerbrandtr@apsu.edu)

**Discussants:**

William Danaher, College of Charleston (danaherw@cofc.edu)  
Paul B. Paolucci, Eastern Kentucky University (paul.paolucci@eku.edu)  
Matthew W. Irvin, Eastern Kentucky University (matthew.irvin@eku.edu)

**80. Paper Session— Theory: Bourdieu as a Social and Critical Theorist (Grand Hall D)**

**Presider:** Harry F. Dahms, University of Tennessee

- *Bourdieu and the Frankfurt School: Converging Theories of Culture and Inequality*, David Gartman, University of South Alabama- Mobile (dgartman@usouthal.edu)
- *Anti-Habitus and the Sketch for a Self-Analysis*, Dan Schubert, Dickinson College (schubert@dickinson.edu)
- *Beyond Bourdieu: Symbolic Capital and the Implications for a More Just Society*, Elena Delavega, University of Houston (elenadelavega65@gmail.com)
- *Analyzing Corporations Using Bourdieu's Theory of Capital*, Zachary P. Watne, University of Georgia (zac.sociology@gmail.com); Galen Ciscell, Colorado State University

**81. Paper Session— Workplace Experiences (Hong Kong)**

**Presider:** David Maume, University of Cincinnati

- *Power and the Control of Emotions in the Workplace*, Melissa Sloan, Drew University (msloan@drew.edu); Ashley B. Thompson, Lynchburg College
- *Both a Carrot and a Stick? Reconciling Empowerment, Panopticon and Conflict Approaches to Teamwork*, Julianne Payne, North Carolina State University (jcpayne@ncsu.edu); Martha Crowley, North Carolina State University
- *Shift Work and Negative Work-to-Family Spillover*, Michelle F. McLeese, Virginia Tech (mmcleeese@vt.edu); Kevin Stainback, Purdue University
- *Out of the Kitchen?: A Longitudinal Analysis of Attitudes toward Women in the Workplace*, Megan Smith, University of North Carolina Charlotte (ssmit392@uncc.edu)
- *Minorities in Management: Effects on Income Inequality and Subordinate Career Prospects*, David Maume, University of Cincinnati (david.maume@uc.edu)

**82. Author-Meets-Critics Session— “Doing Business with Beauty: Black Women, Hair Salons, and the Racial Enclave Economy” by Adia Harvey Wingfield (Hong Kong)**

**Presider:** Griff Tester, Georgia State University

This book is an important and unique contribution to research on ethnic entrepreneurship, race and ethnicity, gender, and work.

- Irene Browne, Emory University (ibrowne@emory.edu)
- Kirsten Dellinger, University of Mississippi (kdelling@olemiss.edu)
- Yvonne Newsome, Agnes Scott College (ynewsome@agnesscott.edu)
- *Author*, Adia Harvey Wingfield, Georgia State University (aharvey@gsu.edu)

**83. Panel Session— Navigating the Academic Job Market (Manila)**

Sponsored by Sociologists for Women in Society – South.

**Presider:** Julie B. Wiest, University of Tennessee

Strategies for finding available jobs, compiling applications, and phone and on-campus interviewing.

- Kate Slevin, College of William and Mary (keslev@wm.edu)
- Elisabeth Sheff, Georgia State University (soceasx@langate.gsu.edu)
- Katie L. Acosta, Tulane University (kacosta1@tulane.edu)
- Matt Wilkinson, Coastal Carolina University (mwilkins@coastal.edu)
- David L. Brunsmad, University of Missouri (brunsmad@missouri.edu)

**84. Panel Session— The Relevance of the Master’s Degree for All Graduate Departments (Montreal)**

**Presider:** Carole L. Seyfrit, Radford University

Findings from the ASA task force on the Master’s Degree in Sociology will be presented

- *The Relevance of the Master’s Degree for All Graduate Departments*, Carole L. Seyfrit, Radford University (clseyfrit@radford.edu); Roberta Spalter-Roth, American Sociological Association; Mellisa Holtzman, Ball State University; Robert Shelly, Ohio University; James Sherohman, St. Cloud University

**85. Paper Session— Culture, Institutions, and Meaning (Grand Hall C)**

**Presider:** Andreas Schneider, Texas Tech University

- *Processing Social Events in Arabic: Preliminary Results*, Lynn Smith-Lovin, Duke University (smithlov@soc.duke.edu); Kimberly B. Rogers, Duke University; Rob Freeland, Duke University; Muhammad Abdul-Mageed, Indiana University; Dawn T. Robinson, University of Georgia; David Heise, Indiana University
- *Social Position and Connectedness as Predictors of Systematic Variation in Affective Meaning*, Kimberly B. Rogers, Duke University (krogers@duke.edu)
- *The Anticipation of the Stigmatization of Managers: A Cross-Cultural Comparison*, Andreas Schneider, Texas Tech University (andreas.schneider@ttu.edu); Tobias Schröder, Freie Universität Berlin
- *Affect Control Theory Technology Dictionary*, Daniel Shank, University of Georgia (dbshank@uga.edu)

## **86. Paper Session— Immigration (Grand Hall A)**

**Presider:** Theresa C. Davidson, Samford University

- *Europeans' Views on Immigration: Economic, Cultural and Racial Determinants*, Thomas C. Wilson, Florida Atlantic University (wilson@fau.edu)
- *Deportation as a Process of Irreversible Transformation: The Case of Jamaican Immigrants*, O. Alexander Miller (nationmiller@bellsouth.net)
- *Building Support for Immigration Reform by Looking at Positive Attitudes*, Paul Kasun, University of Texas at Austin (frpaul@mail.utexas.edu)
- *Entitled or Excluded? Attitudes toward Access to Postsecondary Education for Undocumented Immigrants*, Courtney Palmer, Samford University (clpalmer@samford.edu); Theresa C. Davidson, Samford University

## **87. Paper Session— Intimate Relationships: Formation, Stability, and Quality (Lenox)**

**Presider:** Joe C. Ventimiglia, University of Memphis

- *Escalation of Mate-Selection Standards over the Life Course--Irrational or Explicable: Some Hypotheses*, Joe C. Ventimiglia, University of Memphis (jventmgl@memphis.edu)
- *The Role of Cohabitation in Remarriage: A Replication*, Xiaohe Xu, University of Texas at San Antonio (xiaohe.xu@utsa.edu); John P. Bartkowski, University of Texas at San Antonio; Kimberly Dalton, University of Texas at San Antonio
- *The Comparative and Relational Effects of Work and Education on Marriage Survivability*, Marianne D. Schild, Davidson College (maschild@davidson.edu)
- *What Makes a Successful Marriage? Determinants of Marital Instability in Three Asian Societies*, S. Lynne Rich, University of Central Arkansas (lrich@uca.edu)

## **88. Paper Session— Regionalizing the Sociology of Culture: Media, Institutions, and Disciplines (Singapore)**

**Presider:** Zandria F. Robinson, University of Mississippi

- *Prison Placement As Reputation Management*, John M. Eason, Duke University (je31@soc.duke.edu)
- *Are All Southerners Equally Southern? The Many Faces of Southern Identity*, William W. Falk, University of Maryland (wfalk@socy.umd.edu); Susan E. Webb, Coastal Carolina University; William A. Yagatich, University of Maryland
- *Joined at the Hip: Race, Region, and the Culture of American Sociology*, David M. Ferguson, University of Chicago (dferg@uchicago.edu)
- *Barbeque, Chicken Sandwiches, and Sweet Tea: Selling and Eating the Black South*, Zandria F. Robinson, University of Mississippi (zandria@olemiss.edu)

## **89. Paper Session— Sexuality Issues of College Students (Vancouver)**

**Presider:** Kris De Welde, Florida Gulf Coast University

- *Cheating Outside of the Classroom: Infidelity in Undergraduate Partnerships*, Maja F. Falcon, Duke University (maja.falcon@duke.edu)
- *Pity Dates and Redemptive Chastity: Student Interpretations of Casual Hookups and Formal Dates*, Julie Reid, University of Southern Mississippi (julie.reid@usm.edu); Gretchen Webber, Middle Tennessee State University; Sinikka Elliott, North Carolina State University
- *"I'm Still a Good Christian": Identity Salience, Emotion Management, and Loss of Virginity*, Lanier F. Basenberg, Georgia State University (lanierbasenberg@gmail.com)
- *When Politics become Personal: Coping in Post Amendment 2 Florida*, Sara L. Afflerback, Florida Gulf Coast University (slaffler@eagle.fgcu.edu); Kris De Welde, Florida Gulf Coast University

## **90. Paper Session— Social Movement Dynamics (Cairo)**

**Presider:** Kimberly Kelly, Mississippi State University

- *Mobilizing in Response to Threat: The Case of the Ex-Gay Movement*, Jason Lee Crockett, University of Arizona (jlc76@email.arizona.edu); Melinda D. Kane, East Carolina University
- *Political Activism: Who is Willing to Risk?*, Meredith A. Katz, Virginia Tech (meredith.a.katz@gmail.com)
- *The Relative Importance of Expressive Actions versus Outcomes for Religious Subcultural Identity: Evangelicals and Anti-Abortion Activism*, Kimberly Kelly, Mississippi State University (kkelly@soc.msstate.edu)
- *Rebellious Conservatives: An Analysis of the Pro-Choice/Anti-Abortion Movement*, David R. Dietrich, Duke University (david.dietrich@duke.edu)

## **91. Paper Session— Theory: Gouldner, Mills, Marcuse, and Critical Theory in America (Grand Hall D)**

**Presider:** Edward A. Tiryakian, Professor Emeritus

- *After Gouldner: The Coming Demise of Rational Choice Theory?*, Edward A. Tiryakian, Professor Emeritus (durkham@soc.duke.edu)
- *Social Criticism, Social Theory and Personal Milieu: Making Sense of the Link between Alvin Ward Gouldner and C. Wright Mills*, Timothy M. Gill, University of Georgia (timgill1984@gmail.com)
- *Rethinking C. Wright Mills, Herbert Marcuse, and Alvin Gouldners Contribution to a Social Justice-themed Sociology*, George C. Gondo, University of Tennessee, Knoxville (ggondo@utk.edu)
- *Alvin Gouldner as an American Critical Theorist*, Harry F. Dahms, University of Tennessee, Knoxville (hdahms@utk.edu)

## **92. Paper Session— Undergraduate Teaching: Gathering of New Research (Grand Hall B)**

**Presider:** Nancy Sonleitner, University of Tennessee Martin

- *NCAA Athletes, Sleep, and Academic Performance*, Nancy Sonleitner, University of Tennessee Martin (nsonleitner@utm.edu)
- *Living with Students 24/7: Retaining Minority Faculty and Students on Campus: A Different Approach*, Tiffany G. Chenault, Salem State College (tchenault@salemstate.edu)
- *How Student Satisfaction Factors Affect Perceived Learning*, Celia C. Lo, University of Alabama (clo@ua.edu)
- *The Effects of the Attitudes and Beliefs Students Hold towards Others with Learning Disabilities*, Randall Boen, Austin Peay State University (randallboen@gmail.com); Nicole Knickmeyer, Austin Peay State University

**93. Panel Session— Experiential Learning in Community College and Small College Sociology Classes Session II (Manila)**

Sponsored by the Committee on Sociology in Small and Community Colleges.

**Presider:** Denise L. Bissler, Randolph-Macon College

This session will explore experiential teaching techniques such as service learning, travel, participant observation, and open-ended interviews.

- *Group and Individual Projects in Service Classes in Sociology: Guidelines and Rubrics for Peer Review*, Chandrouti R. Persaud, Mississippi Valley State University (persaudmvsu@yahoo.com)
- *Experiential Learning in the Community and Small College Sociology Classes*, Amy K. Willis, North Carolina Wesleyan College (akarnehm@ncwc.edu)
- *Service-Learning, Values and Social Justice: An Online Survey of Milligan College Alumni*, Rubye W. Beck, Milligan College (rbeck@milligan.edu)

**Discussant:**

Denise L. Bissler, Randolph-Macon College (dbissler@rmc.edu)

**94. Panel Session— Session Honoring Irene Padavic as Recipient of the Katherine Jocher-Belle Boone Beard Award for Gender Scholarship (Cairo)**

**Presider:** Patricia Y. Martin, Florida State University

- Kirsten Dellinger, University of Mississippi (kdelling@olemiss.edu)
- David Maume, University of Cincinnati (david.maume@uc.edu)
- Anastasia Prokos, Iowa State University (aprokos@iastate.edu)
- Vincent Roscigno, Ohio State University (roscigno.1@sociology.osu.edu)
- Mindy Stompler, Georgia State University (socmas@langate.gsu.edu)
- Donald Tomaskovic-Devey, University of Massachusetts (tomaskovic-devey@soc.umass.edu)

**95. Paper Session— Applied Sociology with a “Southern Face” (Montreal)**

**Presider:** Ronald C. Wimberley, NC State University

- *From Sociology with a Southern Face: A New Federal Regional Commission for the Black Belt South*, Ronald C. Wimberley, NC State University (wimberley@ncsu.edu); Libby V. Morris, University of Georgia; Rosalind Harris, University of Kentucky
- *Collaborative Marketing Enterprises: Local Food Exchanges and the Promise of Sustainability*, Mecca J. Lowe, Auburn University (mjl0006@auburn.edu)
- *Using and Improving Irrigation: Producer Perceptions and Possibilities*, Emily Sydnor, Auburn University (ets0002@auburn.edu); Joseph J. Molnar, Auburn University
- *Resident Vulnerability, Preparedness, and Response to Tornado Disasters*, Philip L. Chaney, Auburn University (chanep1@auburn.edu); Greg S. Weaver, Auburn University
- *Unanticipated School Closings: Perpetuation of Social Inequality*, Abigail B. Reiter, George Mason University (areiter12@gmail.com); Elizabeth M. Reiter, Utah State University

## 96. Paper Session— Challenges in Qualitative Research: Dilemmas in Ethics, Funding and Fieldwork (Lenox)

Sponsored by the Florida State University Qualitative Research Group.

**Presider:** Brandon A. Jackson, Florida State University

- *Using Online Materials to Supplement Ethnographic Research*, Christian Vaccaro, Florida State University (cvaccaro@fsu.edu)
- *Dollar Dilemma: Thinking Reflexively About Funding Feminist Qualitative Research*, Meggan M. Jordan, University of Florida (megganj@ufl.edu)
- *Studying Secret Deviance: Issues in Methodology and Reporting*, Craig Alan Boylstein, Coastal Carolina University (cboylstein@gmail.com)
- *What If I'm On The Street Where I Live? Doing Qualitative Research in One's Own Neighborhood*, Carol Wharton, University of Richmond (cwharton@richmond.edu)
- *Doing Qualitative Research in Post-Katrina New Orleans: Challenges in Conducting Ethnographic Research on Volunteerism in the Lower Ninth Ward*, Edwin López, University of California, Santa Barbara (edwinl@umail.ucsb.edu)

## 97. Paper Session— Migration Research and Immigrant Outcomes (Vancouver)

**Presider:** Mariano Sana, Vanderbilt University

- *Surveys, Ethnosurveys, and New Developments in Survey Data Collection in Migration Research*, Mariano Sana, Vanderbilt University (mariano.sana@vanderbilt.edu)
- *Five Stories, Five Years after Hurricane Katrina, Five Lessons about Disasters and Immigration*, Jeannie Haubert Weil, Winthrop University (weiljh@winthrop.edu)
- *The Effects of Native and Foreign-Born Parentage on Educational Transitions of Mexican and Asian Youth*, Roger A. Wojtkiewicz, Ball State University (rwojtkie@bsu.edu)
- *The Effect of Language and Maternal Education on Latinas' Higher Educational Attainment*, Alessandra Maria Bazo, Salem College (alessandra.bazo@salem.edu)
- *Immigrant Educational Experiences: A Survey of Central Georgia*, William M. Bridges, Georgia College & State University (william\_bridges@ecats.gcsu.edu)

## 98. Poster Session (International Ballroom North)

**Presider:** Rebecca Bach, Duke University

- *On Your Knees: Prayer in Romantic Relationships*, Sarah R. Tyson, East Carolina University (srt0726@ecu.edu); David Knox, East Carolina University
- *Secrets in Romantic Relationships*, Alora A. Brackett, East Carolina University (aab0208@ecu.edu); Beth A. Easterling, University of Tennessee
- *Contributing Factors to Infidelity: A Trend among African American Males*, Hideki Morooka, Fayetteville State University (hmorooka@uncfsu.edu); Sonya Y. Worthington, Fayetteville State University
- *"I Kissed a Girl": Heterosexual Women who Report Same-Sex Kissing (and more)*, Tiffany A. Beaver, East Carolina University (tab0509@ecu.edu); Vaiva Kiskute, East Carolina University
- *Where Are the Boys? The Decline of Males in Higher Education and Sociology*, Rebecca D. Petersen, Kennesaw State University (rpeterse@kennesaw.edu)
- *Just Throw It In the Bag: A Qualitative Analysis of Mainstream Rap Music*, Andrew Krause, Randolph-Macon College (andrewkrause@students.rmc.edu)
- *The Homogeneity of Women's Abortion Attitudes Over Time*, John Lynxwiler, University of Central Florida (jlynxwil@mail.ucf.edu); David Gay, University of Central Florida
- *Gender, Make Up, and the Measurement of Emotion During Social Interaction*, Evander G. Baker, University of Georgia (evanderbaker@gmail.com); Stephanie Tucker, University of Georgia; Stephanie Friedrich, University of Georgia; Paige Jann, University of Georgia

- *Sexism and Technology*, Amber B. Trueblood, Saint Edward's University (atruebl@stedwards.edu)
- *Type of University, Social Distance, and Students' E-Based Social Networks: A Test of the Contact Hypothesis*, Nancy Horak Randall, Wingate University (nrandall@wingate.edu); Emily K. Saunders, Wingate University
- *Content Analysis of Gender Dominance in Magazine Advertisements*, Nicholas Holladay, Western Kentucky University (nicholas.holladay@wku.edu)
- *Protected Areas: When Does "Everyday Forms of Resistance" Change to Organized and Public Acts of Resistance?*, Carol Jo Evans, University of Kentucky (cjevans@mail.ecsu.edu)
- *Environmental Protest in the United States: The Movement, Strategy and Success*, Jillian B. Allender, East Carolina University (jba0829@ecu.edu)
- *PR or Pornography? The Feminist Backlash of a PETA Campaign*, Jaime D. Hecht, University of Central Florida (jaimedhecht@gmail.com)
- *The Use of Self-Protective Behaviors in Stalking Incidents: Findings from the National Crime Victimization Survey*, Shannon A. Santana, University of North Carolina Wilmington (santanas@uncw.edu)
- *The Presence of Big Corporations and Community Foundations in the Black Belt*, Alisha Janette Curry, North Carolina State University (ajcurry2@ncsu.edu)
- *IUD Use in Turkey*, Deanna L. Gore, University of South Carolina - Aiken (deannag@usca.edu)
- *How Social Economic Status Leads to Poor Health Conditions in Underprivileged Urban Communities*, Robert L. Cavazos, University of Florida (robcev22@ufl.edu)
- *Cohort Differences in Health Inequalities*, Jenifer Hamil-Luker, University of North Carolina at Greensboro (jlhamill@uncg.edu)
- *Missing Voices: Benefits and Burdens of Fathering Children with Disabilities*, Sara E. Green, University of South Florida (sgreen@cas.usf.edu)
- *Pet Nation: Demographic Correlates of the Human-Companion Animal Bond*, Linda Mooney, East Carolina University (mooneyl@ecu.edu); Christa Reiser, East Carolina University; Kenneth R. Wilson, East Carolina University
- *Diamonds in the Rough: High School Students Researching Society*, Karen Glumm, North Carolina School of Science and Mathematics (glumm@ncssm.edu)
- *Art High School: The Student Experience*, Maggie Yoder, Randolph-Macon College (maggieyoder@students.rmc.edu)

## **99. Paper Session— Racial-ethnic Identity (Hong Kong)**

**Presider:** Von Bakanic, College of Charleston

- *Toward a Cognitive Sociology of Whiteness*, David L. Brunnsma, University of Missouri (brunsmad@missouri.edu); Wayne Brekhus, University of Missouri; Crystal Kroner, University of Missouri; Todd Platts, University of Missouri
- *Multi-Racial Identity: Tensions between Individual and Social Perspectives*, Von Bakanic, College of Charleston (bakanicv@cofc.edu); Karen Stewart-Cain, Trident Technical College
- *Ethnic Churches in America: Understanding Ethnic Identity Work amidst Perceived Racial and Ethnic Discrimination*, Christine McVay, University of Miami (christinemcvay1@aol.com)
- *Hungarian Pride and European Sophistication: Ethnic Identity Construction Among Hungarians in the United States*, Orsolya Kolozsvari-Wright, Georgia State University (kolozsvario@freemail.hu)

**100. Paper Session— Risk and Disease: Medical and Community Perspectives (Singapore)**

**Presider:** Christopher R. Freed, University of South Alabama

- *Hot Spots for Swine Flu: Preparing for the New Influenza A(H1N1) Pandemic in London Schools*, Lauren E. Hamlett, Southwestern University (hamlettl@southwestern.edu)
- *Perceptions of Risk and Sexual Behavior Change following Adult Male Circumcision in Urban Swaziland*, Jonathan M. Grund, Emory University, Rollins School of Public Health (jgrund@sph.emory.edu); Monique Hennink, Emory University, Rollins School of Public Health
- *Attitudes towards Sexual Behaviors in Contemporary China*, Jun Xu, Clemson University (junx@clemson.edu); Ye Luo, Clemson University
- *Community Support, Disclosure and Treatment Outcomes in Public-sector ART in the Free State Province, South Africa*, Francis Van Loon, University of Antwerp (francis.vanloon@ua.ac.be); Edwin Wouters, University of Antwerp
- *The Professional Value of Formal Medical Training in Addiction*, Christopher R. Freed, University of South Alabama (cfreed@usouthal.edu)

**101. Paper Session— Teaching Sociology Through Film, Session 2 (Grand Hall A)**

**Presider:** Jean-Anne Sutherland, UNC Wilmington

- *Film in Sociology Classes: Yesterday, Today and Tomorrow*, Adrian F. Aveni, Jacksonville State University (aaveni@jsu.edu)
- *Teaching Through Film: Using Films and Documentaries in Undergraduate Sociology Courses*, Stephen B. Groce, Western Kentucky University (steve.groce@wku.edu)
- *Hook, Line and Sinker: Using “Crash” and “Sicko” to Teach Introductory Sociology*, Laura Jennings, University of South Carolina Upstate (ljennings@uscupstate.edu)
- *“I’m Showing a Movie Today”: Integrating Film into the Classroom*, Jean-Anne Sutherland, UNC Wilmington (sutherlandj@uncw.edu)

**Discussant:**

Jean-Anne Sutherland, UNC Wilmington (sutherlandj@uncw.edu)

**102. Paper Session— Theory: Ethnography, Grounded Theory, and Social Critique (Grand Hall D)**

**Presider:** Michael Spivey, University of North Carolina at Pembroke

- *Contemplative Practice as a Strategy for Social Change: Towards a Theory of Contemplative Social Action*, Elizabeth A. Gill, Randolph-Macon College (bgill@rmc.edu)
- *The Commodification of Victimization and Concomitant Glorification of Mediocrity*, Nikitah Okembe-Ra Imani, James Madison University (imanino@jmu.edu)
- *When Engaged Ethnography Succeeds: The Role of Critical Theory in Negotiating State Recognition of a Southern Tribe*, Michael Spivey, University of North Carolina at Pembroke (michael.spivey@uncp.edu)
- *Heidegger’s Profound Boredom and Addiction*, Paul Frederick Boshears, The European Graduate School (paul.boshears@gmail.com)

### **103. Paper Session— Work and Labor (Grand Hall C)**

**Presider:** Casey Welch, Flagler College

- *Talking Union: The Use of Storytelling in the Graduate Laborer Movement*, Deeb P. Kitchen, University of Florida (deebp@ufl.edu)
- *Republicans Need not Apply?: An Attempt to Locate Potential Political Bias among Academics*, George A. Yancey, University of North Texas (george.yancey@unt.edu)
- *Testing Notions of Mismatch and Marginalization: How do Students Perceptions of Political Ideological Distance from Their Instructors Affect the Classroom Experience?*, Jeremiah B. Wills, Queens University of Charlotte (willsj@queens.edu); Jonathan R. Brauer, NC State University; Brad Ray, North Carolina State University
- *A Study of the Corporate Culture of Starbucks*, Guillaume R. Bagal, East Carolina University (grb0126@mail.ecu.edu)
- *Body and Power*, Casey Welch, Flagler College (welchsociology@yahoo.com)

### **104. Paper Session— Youth Crime and Violence (Grand Hall B)**

**Presider:** Todd Matthews, University of West Georgia

- *Law in Action: Trends in School Ticketing*, Elyshia D. Aseltine, University of Texas at Austin (elyshia@mail.utexas.edu)
- *Effect of Gang Presence in Schools on Individual Attitudes towards School and Behavior in School*, Sarah Rabiner, Duke University (sarah.rabiner@duke.edu)
- *Adolescent Gang Involvement in Medellin, Colombia*, Sarah L. Arnold, Western Kentucky University (sarah.arnold@wku.edu); Holli R. Drummond, Western Kentucky University
- *Predictors of Illicit Adolescent Gun Ownership*, Todd Matthews, University of West Georgia (tmatthew@westga.edu); Lee M. Johnson, University of West Georgia; David Jenks, University of West Georgia
- *Youth Violence and Young Adult Outcomes*, Patricia Bamwine, Western Kentucky University (patricia.bamwine269@wku.edu)

**Friday, April 23, 5:00 PM—8:00 PM**

### **105. Presidential Honors & Convocation Plenary (International Ballroom South); 5:00—6:30 PM**

**Presider:** Christopher G. Ellison, University of Texas at Austin

**Presentation of Honors and Awards:** Toni Calasanti, Virginia Tech

**Introduction of President:** Kenneth Spenner, Duke University

**Presidential Address:** *The Devolution of Risk and the Changing Life Course*, Angela M. O’Rand, SSS President, Duke University

**Presidential & Awards Reception (International Ballroom North); 6:30 PM—8:00 PM**

## Saturday, April 24

**Committee Meeting— SSS Business Meeting (International Ballroom South); 7:30 AM—8:30 AM**

**Registration (International Tower Lobby); 8:00 AM—12:00 PM**

**Committee Meeting— Executive Committee (Saturday) (Heritage); 8:30 AM—11:00 AM**

**Committee Meeting— Site Selection Committee (Heritage); 12:00 PM—1:00 PM**

## Saturday, April 24, 9:00 AM—10:30 AM

### **106. Panel Session— Academic Workshop on “Preparing for a Program Review” (Montreal)**

**Presider:** Edward L. Kain, Southwestern University

This workshop helps departments prepare for a program review. It covers: national guidelines for the major; ASA resources that can assist in the review; pre-visit activities; information a reviewer will need; and what to include during the visit.

- Edward L. Kain, Southwestern University (kaine@southwestern.edu)
- Gregory Weiss, Roanoke College (weiss@roanoke.edu)

### **107. Panel Session— Sociology and...: Team-Teaching across Disciplines (Manila)**

**Presider:** Maria Vandergriff-Avery, Catawba College

A panel of sociologists who have had successful and rewarding experiences with interdisciplinary team-teaching will discuss: choosing a topic and teaching partner, developing a syllabus and assignments, practical issues like using class time and dividing the workload, challenges of working across different ways of knowing, course assessment, and proposing interdisciplinary team-teaching if your institution doesn't have it now.

- Maria Vandergriff-Avery, Catawba College (mvanderg@catawba.edu)
- Carla M. Eastis, Catawba College (cmeastis@catawba.edu)
- Beth P. Skott, University of Bridgeport (bskott@bridgeport.edu)
- Tracy Burkett, College of Charleston (burkett@cofc.edu)
- Roger J. Reitman, Hood College (reitman@hood.edu)
- Ken Spring, Belmont University (ken.spring@belmont.edu)

### **108. Panel Session— Writing a Grant for NSF (Lenox)**

**Presider:** Jan E. Stets, National Science Foundation

Representatives from the National Science Foundation will discuss the proposal process, elements of a competitive proposal, proposal submission and review, and funding opportunities at the NSF.

- Jan E. Stets, National Science Foundation (jstets@nsf.gov)
- Patricia E. White, National Science Foundation (pwhite@nsf.gov)

**109. Paper Session— Caring for Elders: Places, Policies, and Practices (Grand Hall B)**

**Presider:** Donielle L. Boop, University of Cincinnati

- *Research in the Community*, Maria Trull McDonald, East Carolina University (mtm0806@ecu.edu); Jim Mitchell, East Carolina University
- *Racial Differences in Elder Care Work*, Donielle L. Boop, University of Cincinnati (boopdl@uc.edu)
- *Old Age Care Policy Reforms in Lithuania*, Arunas Juska, East Carolina University (juskaa@ecu.edu); Gabriele Ciciurkaite, East Carolina University
- *Growing Eden: Barriers to Culture Change in Long-term care facilities*, Sarah K. Summers, University of North Carolina at Chapel Hill (sksummer@email.unc.edu)
- *Nursing Homes? More Like Neglect Houses*, Joanne E. Hall, Salem College (halljoe2@salem.edu)

**110. Paper Session— Help-Seeking, Social Networks, and Stress (Vancouver)**

**Presider:** Claire M. Norris, Xavier University

- *Regional Differences in Seeking Help for Mental Distress in the U.S.*, Sean Coleman, Virginia Tech / RTI International (cu\_sean@yahoo.com); Michael Hughes, Virginia Polytechnic Institute and State University; Charles Walter, Virginia Polytechnic Institute and State University
- *Here's to Your (Social) Health: The Effects of Social Networks on Physical and Psychological Health*, Lacie Michel Bogen, Louisiana Tech University (lmichel@latech.edu)
- *Class Differences in Social Support and Mental Health*, Claire M. Norris, Xavier University (cnorris@xula.edu)
- *Stress Exposure and Depression: Are the Lonely More Vulnerable?*, Ashley M. Daily, Florida State University (adaily@fsu.edu); R Jay Turner, Vanderbilt University
- *The Stress Process and Control Issues in Caregiving*, Steven Litsey, Florida State University (scl06@fsu.edu); Teresa Roach, Florida State University

**111. Paper Session— Interactionist Studies in Masculinity (Hong Kong)**

**Presider:** Kenneth H. Kolb, Furman University

- *“That Sounds like a Proposition to Me”: Men’s Interpretation of Women’s Identity Work*, Matthew B. Ezzell, James Madison University (matt.ezzell@gmail.com)
- *Masculinity and Technical Theatre: Performing Gender Backstage*, Allie Pinkerton, Furman University (allie.pinkerton@furman.edu)
- *Masculinity and Manhood Acts in Fathers’ Accounts of Family Sexual Communication*, Nicholas P. Solebello, North Carolina State University (npsoblebe@ncsu.edu); Sinikka Elliott, North Carolina State Univ
- *Bloodsport: Dogfighting as an Expression of Working-class Southern Masculinity*, Wil Massey, East Tennessee State University (masseyw@goldmail.etsu.edu)

### **112. Paper Session— Intersecting Inequalities: Race-ethnicity, Class, and Gender (Grand Hall A)**

**Presider:** Matthew W. Hughey, Mississippi State University

- *The Gendered and Classed Schemas of Whiteness: Shared Ideals of White Nationalists and White Antiracists*, Matthew W. Hughey, Mississippi State University (mhughey@soc.msstate.edu)
- *The Multiple Dimensions of Diversity: A Qualitative Analysis of Police Training*, Allison T. Chappell, Old Dominion University (achappel@odu.edu); Lonan Lanza-Kaduce, University of Florida
- *An Analysis of the “Triple Glass Ceiling” Faced By Black, Afro-Latin, and Indigenous Women in Latin America*, Kelsey Riley, Xavier University of Louisiana (kelseydr@gmail.com)
- *Contraceptive Use as a Racial Marker: Differences in Contraceptive Use between Racial Groups*, Joanna C. McGrath, Emory & Henry College (jmcgrath06@ehc.edu)

### **113. Paper Session— Intimate Partner Violence (Grand Hall C)**

**Presider:** Carolyn Sloane Sawtell, University of West Georgia

- *An Exploration of the Influences of Race, Class and Gender Identity on the Help-Seeking Behavior of LGBTQ Survivors of Violence*, Xavier L. Guadalupe, Virginia Commonwealth University (guadalupe1@vcu.edu)
- *She’s Not The Man: Domestic Violence Shelters and Lesbian Perpetrators of Intimate Partner Violence*, Mikel Walters, George State University (mwalters1@gsu.edu)
- *The Theoretical Links between Social Environments and Perceptions toward Rape and Rape Victims*, Bianca Guinn, University of North Carolina, Charlotte (biguinn@gmail.com)
- *The Victim-Perpetrator Relationship and Women’s Risk of Rape*, Carolyn Sloane Sawtell, University of West Georgia (csawtell@westga.edu)
- *Breaking the Cycle of Abuse: Why Advocates Work to End Domestic Violence and Sexual Assault*, Laura Burrow, Southwestern University (burrowl@southwestern.edu)

### **114. Paper Session— Macro-structuring of Religion (Singapore)**

**Presider:** M. G. Dunn, Roanoke College

- *Association between Country of Residence and Religious Practices: Jews as a Case Study*, Judith L. Bragger, University of Florida (jbragger@ufl.edu)
- *Niches of Protestantism in Mexico: The Result of Vacant Political and Religious Centralized Systems*, Maria G. Davis, University of Texas at Austin (maria\_g\_davis@mail.utexas.edu); Kristen G. Miller, University of Texas at Austin
- *Religiosity Differences Between Eastern and Western Germans*, P.J. Graham, Louisiana State University (pgraha6@lsu.edu); Joachim Singelmann, Louisiana State University
- *Symbolism in Cosmic War: A Semiotic Interpretation of Ethnoreligious Violence in the Balkans*, M. G. Dunn, Roanoke College (dunn@roanoke.edu); M. G. Bonney, Roanoke College

### 115. Paper Session— Service Workers and Professionals (Cairo)

**Presider:** Sarah Winslow-Bowe, Clemson University

- *Social Relations and The Economic Experiences of Female Sex Workers in India*, David Brady, Duke University (brady@soc.duke.edu); Kim Blankenship, Duke University
- *Linguistic Discourse as Evidence of Group Dynamics in Vietnamese-language Manicurist Ads*, Heather L. Mello, University of Georgia (hlmello@uga.edu)
- *Trends and Variation in Faculty Working Time and Time Allocation*, Sarah Winslow-Bowe, Clemson University (swinslo@clemson.edu)
- *Should I Stay or Should I Go? Career Change and Labor Force Separation among Registered Nurses in the U.S.*, Jennifer G. Nooney, University of Central Florida (jnooney@mail.ucf.edu); Lynn Unruh, University of Central Florida; Michelle Yore, University of Central Florida
- *“Where God Guides, He Provides”: The (Non-) Value Of Educational Credentialing For Contemporary Clergy*, Richard N. Pitt, Vanderbilt University (r.pitt@vanderbilt.edu)

### 116. Paper Session— Sociological Theory: Classical and Contemporary Perspectives (Grand Hall D)

**Presider:** Nikitah Okembe-Ra Imani, James Madison University

- *Social Facts and Unintended Injuries*, Peter Lodge, Belmont Abbey College (peterlodge@bac.edu)
- *Structures of “Experience” in Karl Marx’s Social Theory*, Donald A. Nielsen, College of Charleston (nielsend@cofc.edu)
- *Quantitative Theorizing: Limitations of Paradigmatically-Bound Philosophical Meta-Assumptions*, Nikitah Okembe-Ra Imani, James Madison University (imanino@jmu.edu)
- *Betwixt Entities and Events: The Process of Theogenesis*, Douglas A. Marshall, University of South Alabama (dougmarshall@jaguar1.usouthal.edu)

**Saturday, April 24, 10:45 AM—12:15 PM**

### 117. Panel Session— What Else Can I Do With My Advanced Degree in Sociology? Alternatives to Academia (Grand Hall B)

Sponsored by Sociologists for Women in Society – South.

**Presider:** Julie B. Wiest, University of Tennessee

Sociologists who have chosen (because of desire or necessity) other occupational paths besides academia will share their experiences and/or offer advice.

- Sally Hillsman, American Sociological Association (hillsman@asanet.org)
- Mikel Walters, Center for Disease Control and Prevention (wai6@cdc.gov)
- Kathleen Basile, Centers for Disease Control and Prevention (kbasile@cdc.gov)
- Dallas Owens, U.S. Army War College (dallas.owens@us.army.mil)

**118. Paper Session— Applying Qualitative Methods to Sex and Gender Research: Rodeos, Drag Shows, Nurses and Bears (Grand Hall C)**

Sponsored by the Florida State University Qualitative Research Group.

**Presider:** Brandon A. Jackson, Florida State University

- *Ethnographic Field Work in a Sexualized Research Setting*, Elisabeth Sheff, Georgia State University (soceasx@langate.gsu.edu)
- *Queer Eye on the Gay Rodeo*, D’Lane R. Compton, University of New Orleans (dcompton@uno.edu)
- *Gender Performances and Tipping: A Qualitative Study of Drag Shows*, Leslie M. Abell, Western Kentucky University (leslie.abell@wku.edu)
- *“W”-Men: Male Nurses’ Negotiation of Masculinity in a Predominantly Female Profession*, Deb Yoder Miranda, Mississippi University for Women (dmiranda@nsgslp.muw.edu)
- *The Construction of Bear Identity and Masculinity in Bear Media*, Patrick B. McGrady, Florida State University (pmcgrady@fsu.edu)

**119. Paper Session— Education Policies and Programs: Effectiveness and Outcomes (Cairo)**

**Presider:** Solveig A. Cunningham, Emory University

- *Attitudes on Policy Implication in Organizational Bureaucracies: Views on No Child Left Behind Effectiveness in the Public Education System*, John E. Meador, Delta State University (jelliotm84@aol.com); Albert Nylander, Delta State University
- *“Summer Learning, Some Are Not”*: *Characteristics of Low SES Students with High Summer Learning Gains During Elementary School*, Stephanie L. Slates, Johns Hopkins University (sslates1@jhu.edu); Karl L. Alexander, Johns Hopkins University; Doris R. Entwisle, Johns Hopkins University; Linda S. Olson, Johns Hopkins University
- *Learning to Read at Hillcrest: Sociology in the Community*, John S. Rice, University of North Carolina Wilmington (ricej@uncw.edu); Jessica Lee MacDonald, UNC Wilmington
- *Access to Sweetened Beverages and Weight in Elementary School Children*, Solveig A. Cunningham, Emory University (sargese@sph.emory.edu); Madeline Zavodny, Agnes Scott College

**120. Paper Session— Emotions, Identity and Politics in the Battle over Terri Schiavo (Singapore)**

**Presider:** Deana A. Rohlinger, Florida State University

- *Emotional Resonance and Political Activism: A Social Psychological Analysis of the Terri Schiavo Case*, Christian Vaccaro, Florida State University (cvaccaro@fsu.edu); Serkan Erdemli, Florida State University; Kyle Rogers, Florida State University
- *“Dear Governor Bush”*: *Framing and Role-Identities in E-Mail about Terri Schiavo*, Miriam R. Sessions, Florida State University (msessions@fsu.edu); Heather Mauney, Florida State University
- *Terri’s Fate: Regional and Political Differences in the Discussion of the End of Life Outcomes*, Joellen Pederson, Florida State University (jgp08f@fsu.edu); Katy Schindler, Florida State University; Giuseppina Valle, Florida State University
- *Framing Life and Death: The Role of Emotions in Politics, Policy and Public Debate*, Deana A. Rohlinger, Florida State University (drohling@fsu.edu)

**121. Paper Session— Expectations and Perceptions in Education: Social Class, Cultural Capital, and Gender (Lenox)**

**Presider:** Elizabeth Stearns, UNC-Charlotte

- *Expectations as Cultural Capital*, Daniel J. Potter, University of Virginia (djp3r@virginia.edu)
- *Parents Educational Expectations for Their Young Children: SES, Race/Ethnicity and School Feedback*, Lisa Munson Weinberg, Florida State University (lweinberg@fsu.edu); John R. Reynolds, Florida State University
- *The Effects of Masculine Culture on the Academic Expectations of High School Students*, Melissa J. Bamford, Florida State University (mjb08d@fsu.edu)
- *The Contribution of Professional Climate and Curricula to Early Mathematics Gaps Across Schools*, Stephanie Moller, UNC-Charlotte (smoller@uncc.edu); Elizabeth Stearns, UNC-Charlotte; Roslyn Mickelson, UNC-Charlotte
- *Has Chinas Market Transition Influenced the Well-Being of Women: A Measure of Difference Between Two Cohorts*, Margaret E. Gaines, Virginia Tech (gainesme@vt.edu)

**122. Paper Session— Group Identity and Collective Memory (Montreal)**

**Presider:** Sandra K. Gill, Gettysburg College

- *Colonialism and the African Identity: As Told by the Literature Voices of the Nation*, Lachae Ann Stull, University of North Carolina at Chapel Hill (lachaestull@gmail.com)
- *The Origins of Racial Violence Memory Movements*, Raj A. Ghoshal, UNC-Chapel Hill (rajesh@unc.edu)
- *Street Credibility: The “Badder,” the Better*, Randi L. Hunton, University of South Carolina Upstate (randihunton@yahoo.com)
- *Movements and Commemoration: A Spatial Analysis of the Civil Rights Movement and Memorial Projects in the American South*, April L. Dove, University of South Carolina (dovea@mailbox.sc.edu); Naomi R. Kolberg, University of South Carolina
- *Constructing and Rewriting Memories of the Civil Rights Movement in Birmingham*, Sandra K. Gill, Gettysburg College (sgill@gettysburg.edu)

**123. Paper Session— Health Disparities, Social Capital, and Vulnerability (Manila)**

**Presider:** La Fleur F. Small, Wright State University

- *Behavioral Model for Vulnerable Populations: Determinants of Physician Utilization, Emergency Room Use, and Hospitalizations among Populations with Multiple Health Vulnerabilities*, La Fleur F. Small, Wright State University (lafleur.small@wright.edu)
- *State of Being: An Analysis of Risk and Capital Among Arkansas Youth*, Hanna M. Jokinen-Gordon, Florida State University (hmj09e@fsu.edu)
- *Race/Ethnicity, Nativity and Morbidity Trajectories*, Tyson Brown, Duke University (tyson.brown@duke.edu)
- *Dying to Live: Examining Health Care Disparities among African American Women*, Zinobia Bennefield, Salem College (zbambi89@gmail.com)
- *Birth Cohorts and Social Change: Examining Relative Mortality Risk by Race*, Kristen G. Miller, University of Texas at Austin (kgmiller17@gmail.com); Maria G. Davis, University of Texas at Austin

#### **124. Paper Session— Impacts of Social Policy on Economic and Racial Inequality (Grand Hall A)**

**Presider:** Rebecca S. Powers, East Carolina University

- *State Reform and Workforce Reduction During Chinas Market Transition*, Wei Zhao, University of North Carolina at Charlotte (wzhao1@uncc.edu)
- *The Impact of Public Sector Reform on African American Mobility*, George Wilson, University of Miami (gwilson1@miami.edu)
- *Social Support and Community Services in a Neighborhood Undergoing Revitalization: Feasible or Not?*, Rebecca S. Powers, East Carolina University (powersr@ecu.edu); Michelle M. Livermore, Louisiana State University; Kacee Gore, East Carolina University
- *Socioeconomic Barriers and Social Mobility in Frontline Healthcare: A Case for a Cumulative and Multiple Disadvantage Approach*, Kendra J. Jason, North Carolina State University (kjjason@ncsu.edu); Brandy Farrar, North Carolina State University

#### **125. Paper Session— Interactionist Studies in Symbolic Boundaries (Hong Kong)**

**Presider:** Matthew B. Ezzell, James Madison University

- *Interdependent Emotion Management Strategies in an Agency that Assists Victims of Domestic Violence and Sexual Assault*, Kenneth H. Kolb, Furman University (ken.kolb@furman.edu)
- *Cultivating Authenticity: Identity Management among Spoken Word Poets*, Jeffrey Paulk, Furman University (daniel.paulk@furman.edu)
- *Wounded By the Church: Emotions, Intersectionality, and Symbolic Boundaries in Lesbian- and Gay-Affirming Protestant Congregations*, Krista McQueeney, Salem College (krista.mcqueeney@salem.edu)
- *“It All Seems So Simple Now” : The Use of Complementary and Alternative Medicine for Sense-Making*, Joslyn J. Brenton, North Carolina State University (jjbrento@unity.ncsu.edu)
- *“I Feel Like I’m Going to Hell, but I Had a Great Time” : Absurd Humor in an Alternative Theater Group*, Jennifer Lynne Caputo, Florida State University (jcaputo@fsu.edu)

#### **126. Paper Session— Interracial Relationships and Identities (Vancouver)**

**Presider:** Suzanne T. Sutphin, University of South Carolina

- *Miscegenation Nation: Recast(e)ing National Identity in American History*, Anthony Kwame Harrison, Virginia Tech (kwame@vt.edu)
- *The ‘New Mestiza,’ the Old Mestizos: Contrasting Discourses on Mestizaje*, Maria Luisa Amado, Guilford College (mamado@guilford.edu)
- *Racial Preferences of Men Who Date Men*, Suzanne T. Sutphin, University of South Carolina (sutphist@mailbox.sc.edu); Shannon M. McDonough, University of South Carolina
- ODUM GRADUATE STUDENT PAPER AWARD—*What’s in a Relationship? Examining Race, Class, and Contact Time as Determinants of Social Capital in Mentoring Relationships*, S. Michael Gaddis, University of North Carolina at Chapel Hill (mgaddis@email.unc.edu)
- *Interracial Couples: A Look at Discrimination and Coping Strategies*, Keshia M. Reid, Florida State University (kmreid@fsu.edu); Byron A. Miller, Florida State University; Amanda Poling, Florida State University

### **127. Paper Session— Theory between Politics, Policy, and Culture (Grand Hall D)**

**Presider:** Joseph Francis McCahill, University of Tennessee

- *Elite Theory, Game Theory, and Cabinet Secretaries' Political Survival: A Social Networking Approach*, Charles Gibson, University of Alabama at Birmingham (cbgibson@uab.edu); Casey Borch, University of Alabama - Birmingham
- *U.S. Health Care as Reflexive Modernization: Looking Forward in Policy and Practice*, Brian P. Hinote, Middle Tennessee State University (bhinote@mtsu.edu); Jason Adam Wasserman, Texas Tech University
- *Rejection-Identification Model and Muslims Post-9/11*, Jean S. Humphreys, Dallas Baptist University (jean@dbu.edu)
- *The Transcendence of Self-Estrangement: Filtered Through Media Technologies*, Joseph Francis McCahill, University of Tennessee (mccahill@utk.edu)
- *The Internalization of the Cultural Apparatus through the Movement of Agent and Generalized Other*, Jacob Alden Miller, UAB (jaldenm@uab.edu)

**Saturday, April 24, 12:30 PM—1:45 PM**

### **128. Panel Session— Teaching Critical Sociological Thinking: A Teaching Workshop (Manila)**

Sponsored by Sociologists for Women in Society – South.

**Presider:** Maxine P. Atkinson, North Carolina State University

Participants will be introduced to a general framework of critical thinking and use this to conceptualize critical sociological thinking. Participants will practice class activities that promote critical sociological thinking in our students.

- Maxine P. Atkinson, North Carolina State University (maxine\_atkinson@ncsu.edu)
- Andrea N. Hunt, North Carolina State University (anhunt@ncsu.edu)

### **129. Paper Session— Gender and Aging: Representations and Realities (Singapore)**

**Presider:** Anne Barrett, Florida State University

- *Online Dating in Middle and Later Life: Gendered Expectations and Experiences*, Summer McWilliams, Florida State University (smcwilliams@fsu.edu); Anne Barrett, Florida State University
- *The Portrayal of Aging Women on Prime-time Television*, N. Jane McCandless, University of West Georgia (jmccandl@westga.edu); Tiffany Parsons, University of West Georgia
- *Gender Differences in Social Security Contributions and Benefits*, Heather Mauney, Florida State University (htm8387@fsu.edu)
- *Trends in Sex and Race Inequality in the Older Work Force: 1994-2008*, Arthur S. Wilke, Auburn University (wilkeas@auburn.edu)

### **130. Paper Session— Gender Issues in Higher Education (Grand Hall A)**

**Presider:** Jason Milne, Longwood University

- *Toward Underlying Reasons for Gender Stratification in the Sciences: Preliminary Findings from the Perceptions of Women in Science Study*, Elaine Howard Ecklund, Rice University (ehe@rice.edu); Anne Lincoln, Southern Methodist University
- *We've Met the Enemy and We Is Us: Sociologists Self-Reporting Personal Experiences of Gender Disadvantage*, Emory Morrison, Mississippi State University (morrison@soc.msstate.edu)
- *Genders Role: A Content Analysis of University Syllabi*, Marie Sheneman, University of South Alabama (mariesheneman@gmail.com)
- *The Gendered Structure of Higher Education*, Jason Milne, Longwood University (milnejs@longwood.edu); Alyssa Engiles, Longwood University; Nasim Moadab, Longwood University; Kelsey Odom, Longwood University

### **131. Paper Session— Industrial Relations & Global and Local Markets (Montreal)**

**Presider:** David Jaffee, University of North Florida

- *Informal Job Matching and Labor Market Institutions: Non-Searching for Jobs in the United States and Germany*, Steve McDonald, North Carolina State University (steve\_mcdonald@ncsu.edu); David F. Warner, Case Western Reserve University; Richard A. Benton, North Carolina State University
- *Effects of Globalization and Public Policies on the Industrial Relations in the Port of Rotterdam, 1990-2008*, Lei Lei, University of Central Florida (kathylei7@gmail.com)
- *Hauling Containers: Port Drayage Drivers in the Logistics Supply Chain*, David Jaffee, University of North Florida (djaffee@unf.edu); Adam Rowley, University of North Florida
- *The United Nation's Global Compact Within the U.S.: Comparing Signees to Non-Signees*, Zachary P. Watne, University of Georgia (zac.sociology@gmail.com)
- *A Shift Share Analysis of Changes in Occupations in Three Deindustrialized and Restructuring Cities, 1990 to 2000*, Colby R. King, University of South Carolina (colby.r.king@gmail.com); Shelley A. Smith, University of South Carolina

### **132. Paper Session— Issues in Identity (Grand Hall C)**

- *Drug User Identity: The Sick Role and Beyond*, Katelyn J. Rozenbroek, University of Miami (kjrozenbroek@comcast.net)
- *Environmental Identity and Social Networks as Predictors of Environmentally-Friendly Behaviors*, Lesley Watson, Emory University (lwatson4@emory.edu)
- *Not Just a "Place for Friends": Teenagers, Social Networks, and Identity Vulnerability*, Cenate Pruitt, Georgia State University (cenate\_pruitt@comcast.net)
- *"I'm a Self-Motivated Person": Identity Meanings of Homeless People*, Josie Parker, Georgia State University (josieparker@hotmail.com)

### 133. Paper Session— Law & Society: Judicial and Regulatory Enforcement (Vancouver)

**Presider:** Allison L. Hurst, Furman University

- *The Effects of Political and Social Factors on Judicial Decision Making: A Random Coefficient and Longitudinal Growth Modeling Approach*, Lisa M. Dilks, Claflin University (ldilks@claflin.edu)
- *Political Influence at Different Stages of the Regulatory Enforcement Process*, Peter Shrock, Southeastern Louisiana University (peter.shrock@selu.edu)
- *Judging Debtors: Finding “Undue Hardship” in the Lives of Student Loan Borrowers*, Allison L. Hurst, Furman University (allison.hurst@furman.edu)
- *An Appeal To Fairness*, Andrew V. Krebs, University of Alabama at Birmingham (krebs87@uab.edu)
- *Race Neutral?: The Impact of Florida’s Risk Assessment Tool on Disposition Disparities among Black, Hispanic, and White Male Juvenile Offenders*, Lori D. Moore, Florida State University (ldm2624@fsu.edu); Irene Padavic, Florida State University

### 134. Paper Session— Perceptions of Crime, Crime Avoidance, and Crime Coping (Lenox)

**Presider:** Meredith Huey Dye, Middle Tennessee State University

- *Place of Origin and Reactions to Crime among Women at College*, Adam J. Pritchard, University of Kentucky (adam.pritchard@uky.edu); Carol E. Jordan, University of Kentucky; Pamela Wilcox, University of Cincinnati
- *Reasons for Committing and Avoiding Crime Among Incarcerated Offenders*, Peter B. Wood, Eastern Michigan University (peter.wood@emich.edu); David C. May, Eastern Kentucky University
- *Types and Frequencies of Abuse and Help-Seeking Decisions of Incarcerated Females*, Geri D. Lamb, Middle Tennessee State University (gdl2g@mtsu.edu); Meredith Huey Dye, Middle Tennessee State University; Ron Aday, Middle Tennessee State University
- *The Genesis and Development of the Wilmington Gang Task Force: A Case Study*, Nick Chagnon, University of North Carolina Wilmington (njc3192@uncw.edu); Alicia Larkins, UNC-Wilmington; Lindsey Erin Martin, University of North Carolina Wilmington; Cecil Willis, University of North Carolina Wilmington
- *Comparatively Tracing the Hopelessness and Disadvantaged Community Link*, Colleen E. Wynn, Western Kentucky University (colleen.wynn570@wku.edu); Holli R. Drummond, Western Kentucky University

### 135. Paper Session— Political and Environmental Knowledges (Grand Hall B)

**Presider:** Sara E. Malley, University of Tennessee - Knoxville

- *The Trust Machine: America’s Infatuation with Political Media*, Carlie E. Fogleman, Emory & Henry College (cfogleman07@ehc.edu)
- *Environmental Awareness Among Faculty, Students & Staff at a Mid-sized University in the South*, Aysha A. Bodenhamer, Radford University (abodenham3@radford.edu)
- *A Culture of Sustainability on College Campuses: Assessing the Environmental Impact of Greenhouse Gas Emissions*, Sara E. Malley, University of Tennessee - Knoxville (smalley2@utk.edu); Carmel E. Price, University of Tennessee - Knoxville

### **136. Paper Session— Race, Inequality, and Justice (Cairo)**

**Presider:** Dawn T. Robinson, University of Georgia

- *Emotional Consequences of Being Treated Better than You Deserve: New Tests of Competing Predictions from Identity Control Theory and Affect Control Theory*, Dawn T. Robinson, University of Georgia (sodawn@uga.edu); Jody Clay-Warner, University of Georgia; Lynn Smith-Lovin, Duke University
- *Black Men in the Media: Shaping Perception, Impression, and Affect Control*, Zoe Spencer, Virginia State University (zspencer@vsu.edu)
- *Colorism in Virtual Dating Markets*, Victor Ray, Duke University (ver5@soc.duke.edu)
- *Race Effects on the Experience and Measurement of Emotion*, Tré Myers, University of Georgia (3phoenix@uga.edu); Trent Mize, University of Georgia

### **137. Paper Session— The Sound of Music (Hong Kong)**

**Presider:** Suzanne B. Kurth, University of Tennessee

- *“Rapping About Authenticity”: Rap Aficionados’ Perceptions of Authenticity*, James L. Wright, Chattanooga State Community College (jwright12@utk.edu); Suzanne B. Kurth, University of Tennessee
- *Barriers to Cultural Participation Among Older Adults*, Jill Harrison, Brown University (jill\_harrison@brown.edu); John Ryan, Virginia Tech
- *“The Times They are A-Changin’”: A Life Course Explanation for Folk Music’s Resurgence*, Andrew Ritchey, UNC-CH (ritcheya@email.unc.edu)
- *Christian Music in the Lives of American Teenagers*, Anne K. Hunter, University of North Carolina - Chapel Hill (annekhunter@yahoo.com); Emily E. McKendry-Smith, University of North Carolina

### **138. Paper Session— Theory: Symbolic Interactionism and Identity (Grand Hall D)**

**Presider:** Thomas C. Hood, University of Tennessee

- *Emotion and Social Order*, Thomas S. Henricks, Elon University (henricks@elon.edu)
- *The Merit of Seeing Ourselves as Others See Us*, Thomas C. Hood, University of Tennessee (tomhood@utk.edu)
- *Beyond Good and Bad Whites: Ugly Couplings of Racism and White Identity*, Matthew W. Hughey, Mississippi State University (mhughey@soc.msstate.edu)
- *Ignorant Othering: Cognition, Self-Comparisons, and the Reinforcement of Social Realities*, Stephen F. Ostertag, Tulane University (sosterta@tulane.edu)

**Saturday, April 24, 2:00 PM—3:30 PM**

### **139. Panel Session— How to Participate in Assessment Without Really Trying (Lenox)**

**Presiders:** Lorraine Evans, University of Tennessee Chattanooga; Stephanie McClure, Georgia College and State University

- *Been There, Done That: The Challenges and Rewards of Program Assessment*, Stephanie M. McClure, Georgia College and State University (stephanie.mcclure@gcsu.edu)
- *Actually Using Assessment Data: If We Don’t Care About the Answers, We Have Asked the Wrong Questions*, Gregory Weiss, Roanoke College (weiss@roanoke.edu)
- *“That’s not my Job!”: Assessing the Liberal Arts and Workplace Preparation Discussion*, Lorraine Evans, University of Tennessee Chattanooga (lorraine-evans@utc.edu)

#### **140. Paper Session— Applied Sociology and Evaluation Research (Grand Hall C)**

**Presider:** Nick Guittar, University of Central Florida

- *“You Have Not Come this Way Before”*: *OBSA and the Transformation of Township Youth in the Wilds of South Africa*, Karen C. Mundy, Lee University (kmundy@leeuniversity.edu); Bennett M. Judkins, Emory and Henry College
- *I Want Privileges: Experiences of Women Living in Transitional Housing in Central Florida*, Nick Guittar, University of Central Florida (nguittar@mail.ucf.edu); Rachel L. Rayburn, University of Central Florida; Sara Neuenschwander, University of Central Florida; Stephanie Guittar, University of Central Florida; James D. Wright, University of Central Florida
- *Online Health Information-Seeking Behaviors Among College Undergraduates*, Marni Zuckerman, University of Maryland Baltimore County (marni.zuckerman@gmail.com)
- *Bullying: A Fight for Change*, Melissa Henson, University Central Florida (melissah@knights.ucf.edu); Ida Cook, University of Central Florida

#### **141. Paper Session— Community Research Partnerships: Revisiting the City as a Social Laboratory (Cairo)**

**Presider:** Donald C. Reitzes, Georgia State University

- *Studying Public Housing Relocation: The Importance of Grassroots Partnerships*, Deirdre Oakley, Georgia State University (socdao@langate.gsu.edu); Erin Ruel, Georgia State University
- *Studying Urban Homelessness for and in a Tri-Jurisdictional Collaboration*, Josie Parker, Georgia State University (josieparker@hotmail.com)
- *Community Groups Promoting African American-Latino Collaborations*, Charles Jaret, Georgia State University (cjaret@gsu.edu)
- *Community Engagement among Rural Women: A Cross Border Comparative Analysis*, Paulette A. Meikle, Delta State University (pmeikleyaw@deltastate.edu); Lei Chen, University at Albany, State University of New York; Zachary Tatum, Delta State University

**Discussant:**

Donald C. Reitzes, Georgia State University (socdcr@langate.gsu.edu)

#### **142. Paper Session— Effects of Religion and Spirituality (Singapore)**

**Presider:** Jennifer Storch, University of Texas-Austin

- *The Effects of Satanism on Subjective Well-being*, Chris P. McDaniel, University of Central Florida (lancecannun@yahoo.com)
- *Life Stressors, Religious Involvement and Relationship Quality Among Black Americans*, Andrea Henderson, University of Texas at Austin (henda@mail.utexas.edu)
- *Government Support for Science in an Era of Resource Constraints: Exploring the Role of Religion*, Jennifer Storch, University of Texas-Austin (jenniferstorch@hotmail.com)
- *Does Spirituality Predict Marijuana Use?*, Timothy Colyer, University of Central Florida (tipaco@aol.com); Donovan C. Bowers, Santa Fe College
- *Three Dimensions of Religiosity as Indicators of Conservative Gender Attitudes*, Kelli K. Smith, Emory and Henry College (ksmith07@ehc.edu)

### **143. Paper Session— Higher Education: Organization, Control, and Social Capital (Grand Hall A)**

**Presider:** Diane D. Everett, Stetson University

- *Higher Education at Risk: The Corporate take-over of American Colleges and Universities*, Terrell A. Hayes, High Point University (thayes@highpoint.edu)
- *The Expansion of American Higher Education Re-examined*, Evangeleen F. Pattison, CUNY-City College of New York (epattis00@ccny.cuny.edu)
- *Challenging the Dichotomy of College vs. Work: How High School Graduates Navigate Educational and Labor Market Transitions*, Josipa Roksa, University of Virginia (jroksa@virginia.edu)
- *Resident Assistants, Bureaucracy, and Negotiated Order*, Diane D. Everett, Stetson University (ddeveret@stetson.edu); Zachary Loftus, Stetson University
- *Capital Matters: The Familial Effect on the College-Bound Student*, Callie R. Paige, Southwestern University (paigec@southwestern.edu)

### **144. Paper Session— Investigations into the Social Construction of Knowledge (Grand Hall D)**

**Presider:** Nancy L. Malcom, Georgia Southern University

- *Writing from Experience: How Authors of Picture Books Make Claims About Expertise, Helping Children, and Contributing to the Social Good*, Nancy L. Malcom, Georgia Southern University (nmalcom@georgiasouthern.edu); Carrie L. Smith, Millersville University of Pennsylvania
- *Struggle Over Definition: The Case of ‘Mad Cow’ Disease in Korea*, Seungbong Jeon, University of Virginia (sbj9d@virginia.edu)
- *Twenty-First Century ICT Diffusion in Ghana, Kenya, and India: Consequences for Female Researchers Professional Network Structure*, Beverly Paige Miller, University of Wisconsin, River Falls (paige.miller@uwrf.edu); Wesley M. Shrum, Louisiana State University; Ricardo Duque, University of Vienna
- *The Regenerative Aspect of Negative Thinking*, Jarrett A. Thibodeaux, Vanderbilt University (jarrett.a.thibodeaux@vanderbilt.edu)

### **145. Paper Session— Motivations and Mechanisms for Making the World a Better Place (Montreal)**

**Presider:** David M. Burley, Southeastern Louisiana University

- *Where’s the Food?: Building Community and Health Through a Local Food Growing Map in New Orleans*, David M. Burley, Southeastern Louisiana University (david.burley@selu.edu); Darlene Wolnik
- *Political Consumerism: A New Form of Engagement*, Meredith A. Katz, Virginia Tech (meredith.a.katz@gmail.com)
- *(Masked) Individualism: A Marxist Critique of the ‘New Anarchism’*, John O’Connor, Central Connecticut State University (oconnorjohn@ccsu.edu); Kevin Sullivan, CCSU
- *Relieving Oppression Through Knowledge and Community-Based Research*, Rachel E. Ponder, Belmont University (ponderr@pop.belmont.edu)
- *Benefits and Barriers of Philanthropy in Rural America*, Cindy Bond-Zielinski, The Ohio State University (bond-zielinski.1@osu.edu)

#### **146. Paper Session— Racial-ethnic Prejudice and Discrimination (Hong Kong)**

**Presider:** Brian P. Hinote, Middle Tennessee State University

- *The Southern Explanation: Change in Factors Impacting Explanations of Racial Inequality, 1972-2008*, J. Scott Carter, University of Central Florida (carter@mail.ucf.edu); Mamadi Corra, East Carolina University
- *Contact Theory in Context: Community Composition, Characteristics of Residential Segregation, and Racial/Ethnic Prejudice in the U.S.*, Amanda Watson, Middle Tennessee State University (alw5x@mtsu.edu); Meredith Huey Dye, Middle Tennessee State University; Brian P. Hinote, Middle Tennessee State University; Foster Amey, Middle Tennessee State University
- *Racialized Customer Service in Restaurants: A Quantitative Assessment of the Statistical Discrimination Explanatory Framework*, Zachary W. Brewster, West Virginia State University (zbrewster@wvstateu.edu)
- *“Only if They Dream in English”: Models of American Ethnoracial Relations and Civic Disengagement*, Frank Samson, University of Miami (flsamson@miami.edu)

#### **147. Paper Session— Religious and Cultural Divides (Grand Hall B)**

**Presider:** Richard Lee Rogers, Southern Wesleyan University

- *Cinematic Homogeneity: Heroes and Villains in Post-9/11 Films*, John Markert, Cumberland University (john\_markert@comcast.net)
- *Muslims in the Media: The New York Times, 2000-2008*, Autumn M. Bishop, University of Central Florida (autumn.m.bishop@knights.ucf.edu)
- *Is Immigration Bad?: Effects of Socio-Economic and Demographic Determinants as well as Prejudice on Peoples’ Perceptions about Immigration*, Shyamal K. Das, Fayetteville State University (sdas@uncfsu.edu); Solymer Castellon, Fayetteville State University
- *Pornography and Religiosity*, Melissa Bolt, Southern Wesleyan University (melissa.bolt@mail.swu.edu)

#### **148. Paper Session— Stratification of Buying and Borrowing, Living and Dying (Vancouver)**

**Presider:** Rachel Kannady, University of Memphis

- *Single Industry Employment Concentrations (SIECs) and Infant Mortality*, James N. Maples, University of Tennessee (jmaple11@utk.edu); Joongbaeck Kim, University of Tennessee
- *College Students’ Musical Purchase Decisions*, Kendra Berry, Furman University (kendra.berry1428@furman.edu); Rob MacDonald, Furman University
- *The Racial Wealth Gap, Public Policy and the Post-Millennial College Students Education Debt Repayment Options*, Karla M. McLucas, Bennett College for Women (kmm56q@earthlink.net)

#### **149. Paper Session— Well-being in Later Life: Transitions, Trajectories, and Timing (Manila)**

**Presider:** Hui Liew, Mississippi State University

- *Income Dynamics and Health: A Test of Competing Hypotheses*, Hui Liew, Mississippi State University (hpl13@msstate.edu)
- *Integrating Older Adults into the Study of Migration: Research Trends and Theoretical Considerations*, Melanie Sereny, Duke University (ms51@duke.edu)
- *Clarifying the Association between Marital Status and Mental Health: A Longitudinal Study on Marital Transitions*, Tzeli Hsu, Florida State University (th08@fsu.edu)
- *Food, Religion, and Older Adults: Caloric Intake on Weekends versus Weekdays*, David R. Buys, University of Alabama at Birmingham (dbuys@uab.edu); Laura Hartin, University of Alabama at Birmingham; Julie L. Locher, University of Alabama at Birmingham

## Index to Participants

- Abdul-Mageed, Muhammad: 85  
Abell, Leslie M.: 118  
Abercrombie, Wes: 55  
Acosta, Katie L.: 52, 83  
Adams, Alison E.: 2  
Adams, Josh R.: 45  
Adams, Randall: 9  
Aday, Ron: 134  
Afflerback, Sara L.: 89  
Ahmed, Ghyasuddin: 20  
Akapnitis, Leni: 17  
Albers, Benjamin D.: 69  
Aldredge, Marcus: 19  
Alexander, Karl L.: 119  
Allender, Jillian B.: 98  
Amado, Maria Luisa: 126  
Ambler, Susan H.: 71  
Amey, Foster: 146  
Anderson, Alecia D.: 55  
Anderson, William: 66  
Andersson, Tanetta E.: 63  
Armstrong-Hough, Mari: 2  
Arnold, Sarah L.: 104  
Arrieta, Martha: 6  
Aseltine, Elyshia D.: 104  
Atkinson, Maxine P.: 128  
Austin, Erika L.: 35  
Austin, Kelly: 55  
Austin, Mark: 4  
Aveni, Adrian F.: 101  
Avotri Wuaku, Joyce Y.: 35  
Bach, Rebecca: 41, 98  
Bagal, Guillaume R.: 103  
Bailey, Shannon K.: 40  
Bakanic, Von: 99  
Baker, Evander G.: 98  
Ballard, Sarah: 30  
Bamford, Melissa J.: 121  
Bamwine, Patricia: 104  
Bankston, Carl L.: 32  
Barrett, Anne: 129  
Barringer, Mandi Nicole: 50  
Bartkowski, John P.: 87  
Basenberg, Lanier F.: 89  
Basile, Kathleen: 117  
Bazo, Alessandra Maria: 97  
Bean, Anderson M.: 7  
Bean, Karen: 67  
Beatty, Sam: 69  
Beaver, Tiffany A.: 98  
Beck, Rubye W.: 93  
Becker, Sarah: 22  
Beggs, John J.: 37  
Belgrave, Linda L.: 20, 53  
Bennefield, Zinobia: 123  
Benton, Richard A.: 131  
Berkowsky, Ronald W.: 66  
Berry, Kendra: 148  
Bisciglia, Michael G.: 57  
Bishop, Autumn M.: 147  
Bissler, Denise L.: 13, 43, 93  
Blankenship, Kim: 115  
Bodenhamer, Aysha A.: 135  
Boen, Randall: 92  
Bogen, Lacie Michel: 110  
Bohm, Maggie: 29  
Bohon, Stephanie A.: 42  
Bolt, Melissa: 147  
Bond-Zielinski, Cindy: 145  
Bonney, M. G.: 114  
Boop, Donielle L.: 109  
Borch, Casey: 66, 127  
Boshears, Paul Frederick: 47, 102  
Bowers, Donovan C.: 68, 142  
Boydston, Jamie: 29  
Boyle, Kaitlin M.: 38  
Boylstein, Craig Alan: 96  
Brackett, Alora A.: 98  
Braddock, Jomills Henry: 77  
Brady, David: 115  
Bragger, Judith L.: 114  
Brannon, Bobbie: 71  
Brantley, Demario J.: 77  
Braucher, Jonathan R.: 103  
Brekhus, Wayne: 99  
Brenton, Joslyn J.: 125  
Brewster, Zachary W.: 146  
Bridges, William M.: 97  
Brimeyer, Ted M.: 61, 70  
Brown, Alex: 61  
Brown, Antonio: 51  
Brown, Joey: 59  
Brown, Sara: 65  
Brown, Tucker: 23  
Brown, Tyson: 123  
Browne, Irene: 82  
Brunsma, David L.: 83, 99  
Brush, Jessica: 70  
Buffington, Daniel Taylor: 59  
Burdette, Amy: 14  
Burgess, Noelle: 74  
Burkett, Tracy: 107  
Burley, David M.: 145  
Burrow, Laura: 113  
Buys, David R.: 149  
Cain, Leia K.: 5  
Caldwell, Ryan: 19  
Campbell, Bradley: 48  
Can, Ali: 74  
Caputo, Jennifer Lynne: 125  
Carr, Nicole T.: 47  
Carter, Eric M.: 23  
Carter, J. Scott: 146  
Carter, Shannon K.: 76  
Castellon, Solymar: 147  
Cavazos, Robert L.: 98  
Chagnon, Nick: 134  
Chakravarty, Anuradha: 45  
Chambers, Cheryl: 22  
Chaney, Philip L.: 95  
Chang, Tian-Yun: 21  
Chapman, Nate: 79  
Chappell, Allison T.: 112  
Chatterjee, Anwesa: 63  
Chaudhuri, Soma: 45  
Chavez, Jacqueline: 68  
Chen, Lei: 141  
Chenault, Tiffany G.: 92  
Cheney, Tim: 17  
Chi, Guangqing: 29  
Chisholm, Nathaniel: 51  
Ciciurkaite, Gabriele: 109  
Ciscell, Galen: 80  
Citeroni, Tracy: 25  
Clair, Jeffrey M.: 60  
Clark, Brett: 54  
Clarke, Lee: 44  
Clay-Warner, Jody: 136  
Clemons, Jerome R.: 23  
Clifford, Janice: 58  
Cline, Parla: 69  
Cobb, Ryon J.: 77  
Coffey, Glenn S.: 11  
Cole, Eric: 72  
Coleman, Sean: 29, 110  
Colwing, Cathy: 37  
Colyer, Timothy: 142  
Combs, Barbara Harris: 15  
Cominole, Melissa B.: 56  
Compton, D'Lane R.: 118  
Conley, Meghan: 33  
Cook, Hilary: 77  
Cook, Ida: 140  
Coonce, Rachel J.: 4  
Copur, Zeynep: 75  
Corra, Mamadi: 146  
Cotten, Shelia R.: 66  
Coverdill, James: 3  
Cragun, Ryan T.: 50  
Crisafi, Denise N.: 63  
Crockett, Jason Lee: 90  
Crook, Errol: 6  
Crowley, Martha: 81  
Cui, Wanjun: 10, 20  
Cunningham, Solveig A.: 6, 119  
Curry, Alisha Janette: 98  
Dacosta, Mario: 51  
Dahms, Harry F.: 41, 42, 80, 91  
Daily, Ashley M.: 110  
Dalton, Kimberly: 87  
Damarin, Amanda K.: 61  
Danaher, William: 18, 79  
Dao, Vy Thuc: 55  
Dar, Aneliese: 27  
Das, Shyamal K.: 75, 147  
Davenport, Natasha M.: 73  
Davidson, Theresa C.: 86  
Davis, Maria G.: 114, 123  
Davis, Shannon N.: 34  
Davison, Beth L.: 1

De Welde, Kris: 8, 89  
 Delavega, Elena: 80  
 Dellinger, Kirsten: 82, 94  
 Dickenson, Danielle: 49  
 Dietrich, David R.: 90  
 Dilks, Lisa M.: 133  
 Djamba, Yanyi K.: 26  
 Doan, Long: 36  
 Dodge, Jamie Gutierrez: 67  
 Donley, Amy: 60  
 Donovan, Ceaser: 18  
 Dove, April L.: 122  
 Drente, Patricia: 66  
 Driscoll, Adam R.: 54  
 Drozdowski, Amanda: 27  
 Drummond, Holli R.: 104, 134  
 Dryden, Nathanael E.: 50  
 Duffe, Shelene: 76  
 Dunaway, R. Gregory: 14  
 Dunn, M. G.: 114  
 Dunn, Thomas P.: 27, 62  
 Duque, Ricardo: 144  
 Dye, Meredith Huey: 134, 146  
 Eason, John M.: 88  
 East, Elizabeth: 33  
 Easterling, Beth A.: 75, 98  
 Eastis, Carla M.: 107  
 Eastman, Jason T.: 18  
 Edmond, Mary Bond: 10  
 Edmonds, Doris: 51  
 Eisenhart, Emily: 70  
 Elliott, Sinikka: 89, 111  
 Ellison, Christopher G.: 14, 40, 105  
 Emerson-Lewis, Michelle: 51  
 Engiles, Alyssa: 130  
 Entwisle, Doris R.: 119  
 Erdemli, Serkan: 120  
 Ernestes, Amy M.: 20  
 Evans, Carol Jo: 98  
 Evans, Derek: 77  
 Evans, Lorraine: 139  
 Everett, Diane D.: 143  
 Everett, Tiffani: 36  
 Everts, Dr. Dorothy E.: 17  
 Ezzell, Matthew B.: 111, 125  
 Fairchild, Emily: 59  
 Falcon, Maja F.: 89  
 Falk, William W.: 55, 88  
 Farrar, Brandy: 36, 124  
 Feldmeyer, Ben: 57  
 Ferguson, David M.: 88  
 Fischer, Micheal: 51  
 FitzGerald, Scott: 16, 45  
 Flatt, Christy: 67  
 Fogleman, Carlie E.: 135  
 Ford, Jason A.: 57  
 Foy, Steven L.: 21  
 Freed, Christopher R.: 100  
 Freeland, Rob: 85  
 Frevert, Tonya K.: 49  
 Frey, Scott: 20, 42  
 Freymeyer, Robert H.: 13  
 Friedman, Sarah: 67  
 Friedrich, Stephanie: 98  
 Fryman, Melanie L.: 30  
 Gadberry, James H.: 43  
 Gaddis, S. Michael: 126  
 Gagne, Patricia L.: 4  
 Gaines, Margaret E.: 121  
 Gallagher, Charles A.: 99  
 Garcia, Jessie: 19  
 Garcia, Lisette M.: 31  
 Gardner, Sheena: 68, 78  
 Garnett, Richard: 28  
 Gartman, David: 80  
 Gay, David: 98  
 Gerbrandt, Roxanne: 8, 79  
 Ghoshal, Raj A.: 122  
 Giacalone, Katie: 3  
 Gibson, Charles: 127  
 Gilbert, Paul A.: 29  
 Gilbert, Shelby: 16, 56  
 Gill, Elizabeth A.: 102  
 Gill, Sandra K.: 122  
 Gill, Timothy M.: 91  
 Gilmore, Preston: 8  
 Glenn, Evelyn Nakano: 12  
 Glennie, Elizabeth J.: 56  
 Glumm, Karen: 98  
 Gondo, George C.: 91  
 Gore, Deanna L.: 98  
 Gore, Kacee: 124  
 Gossom, Audrey: 10  
 Gourdin, Dustin: 32  
 Grace, Dana: 77  
 Graham, P.J.: 114  
 Granberg, Ellen M.: 49  
 Green, John J.: 73  
 Green, Sara E.: 98  
 Greene, Dana: 17  
 Griffin, Christina: 44  
 Groce, Lewis A.: 79  
 Groce, Stephen B.: 79, 101  
 Grund, Jonathan M.: 100  
 Guadalupe, Xavier L.: 113  
 Guidry, Tiffany: 73  
 Guinn, Bianca: 113  
 Guittar, Nick: 58, 140  
 Guittar, Stephanie: 140  
 Hadler, Markus: 28  
 Hale, Timothy: 66  
 Hall, Joanne E.: 109  
 Hamby, Bryant W.: 14  
 Hamil-Luker, Jenifer: 98  
 Hamlett, Lauren E.: 100  
 Hanks, Roma Stovall: 47  
 Hanna, Deborah M.: 21  
 Hansell, Tom S.: 1  
 Hanson, Rebecca Annice: 2  
 Harden, Garrick: 19  
 Harris, Catherine: 35  
 Harris, Jonathan W.: 23  
 Harris, Rosalind: 95  
 Harrison, Anthony Kwame: 126  
 Harrison, Daniel: 13, 32  
 Harrison, Jill: 137  
 Hartin, Laura: 149  
 Hasan, Naadiya: 39  
 Hauman, Nicholas: 58  
 Hawdon, James: 32  
 Hawthorne, Shermeka M.: 6  
 Hayes, Terrell A.: 143  
 Haynes, Stacy: 14  
 Hecht, Jaime D.: 98  
 Heise, David: 85  
 Henderson, Andrea: 40, 142  
 Heneghan, Jennifer: 15  
 Hennink, Monique M.: 100  
 Henricks, Thomas S.: 138  
 Henson, Melissa: 140  
 Henson, Trudy Knicely: 48  
 Herbst, Jessica: 2  
 Hernandez, Marguerite: 45  
 Hess, Amie: 52  
 Higgins, Paul: 47  
 Hillsman, Sally: 117  
 Hinote, Brian P.: 127, 146  
 Holladay, Nicholas: 98  
 Holland, William Wyatt: 16  
 Holmes, Bernadette J.: 51  
 Holtzman, Mellisa: 84  
 Hood, Thomas C.: 138  
 Hook, Tina C.: 40  
 Hosman, Sarah S.: 79  
 Howard Ecklund, Elaine: 130  
 Hsu, Tzeli: 149  
 Hudson, Kenneth: 6  
 Hughes, Michael: 31, 110  
 Hughey, Matthew: 29, 68, 112, 138  
 Humphreys, Jean S.: 27, 127  
 Hunt, Andrea N.: 128  
 Hunt, David: 139  
 Hunter, Anne K.: 137  
 Hunton, Randi L.: 122  
 Hurlbert, Jeanne S.: 37  
 Hurst, Allison L.: 133  
 Hutchinson, Richard N.: 54  
 Ibarra, Zulema: 70  
 Imani, Nikitah Okembe-Ra: 102, 116  
 Irvin, Matthew W.: 18, 79  
 Jackson, Brandon A.: 39, 96, 118  
 Jackson, Regine O.: 49  
 Jackson, Sandra L.: 6  
 Jaffee, David: 131  
 Jann, Paige: 98  
 Jaret, Charles: 141  
 Jasinski, Jana: 10  
 Jason, Kendra J.: 8, 124  
 Jefcoat, Carley: 73  
 Jefferson, Samuel: 51  
 Jenks, David: 104  
 Jennings, Laura: 101  
 Jeon, Seungbong: 144  
 Johnson, Barbara E.: 13  
 Johnson, Ebony L.: 62  
 Johnson, Jennifer A.: 52, 58

Johnson, Lee M.: 104  
 Jokinen-Gordon, Hanna M.: 123  
 Jones, Mark P.: 21  
 Jordan, Carol E.: 134  
 Jordan, Meggan M.: 96  
 Judkins, Bennett M.: 13, 140  
 Juska, Arunas: 109  
 Kain, Edward L.: 106  
 Kalleberg, Arne: 24  
 Kane, Melinda D.: 90  
 Kane, Wendi: 53  
 Kannady, Rachel: 148  
 Kasun, Paul: 86  
 Katz, Meredith A.: 90, 145  
 Katz-Fishman, Walda: 53  
 Kaufman, Gayle: 34  
 Kaufman, Jerry: 77  
 Keith, Verna M.: 31  
 Kelly, Kimberly: 90  
 Keniston, Leonda: 43  
 Kerley, Kent R.: 63  
 Kerr, Keith T.: 19  
 Kershaw, Njeri: 29, 37  
 Khan, Hajra: 14  
 Kiecolt, K Jill: 31  
 Kim, Joongbaeck: 15, 148  
 Kim, Sangmoon: 78  
 Kimuna, Sitawa R.: 26  
 King, Colby R.: 131  
 Kiskute, Vaiva: 98  
 Kitchen, Deeb P.: 50, 103  
 Kleiner, Anna: 73  
 Knauss, Steve: 50  
 Knickmeyer, Nicole: 92  
 Knop, Brian M.: 22  
 Knox, David: 75, 98  
 Kolb, Kenneth H.: 111, 125  
 Kolberg, Naomi R.: 122  
 Kolozsvari-Wright, Orsolya: 99  
 Kooistra, Paul: 32  
 Koontz, Amanda: 60  
 Koropecyj-Cox, Tanya: 75  
 Krause, Andrew: 98  
 Krebs, Andrew V.: 133  
 Kroll-Smith, Steve: 44  
 Kroner, Crystal: 99  
 Kuck, Douglas L.: 49  
 Kurth, Suzanne B.: 137  
 Kusujiarti, Siti: 44  
 Lagrange, Randy: 78  
 Lamb, Geri D.: 134  
 Lamonica, Aukje K.: 20  
 Land, Kenneth C.: 78  
 Lanza-Kaduce, Lonni: 112  
 Laporta, David J.: 38  
 Larkins, Alicia: 134  
 Lasalle, Katie: 61  
 Lee, Bo Hyeong: 73  
 Lehman, Brett M.: 15, 37  
 Lei, Lei: 131  
 Liew, Hui: 78, 149  
 Lincoln, Anne: 130  
 Litsey, Steven: 110  
 Livermore, Michelle M.: 124  
 Lo, Celia C.: 62, 92  
 Locher, Julie L.: 149  
 Lodge, Peter: 116  
 Loftus, Zachary: 143  
 Logan, Page: 73  
 Longest, Kyle C.: 11  
 López, Edwin: 96  
 Lowe, Mecca J.: 95  
 Luo, Baozhen: 26  
 Luo, Ye: 100  
 Lybeck, Eric Royal: 74  
 Lynxwiler, John: 98  
 Lyons, Heather: 75  
 MacDonald, Jessica Lee: 119  
 MacDonald, Rob: 148  
 MacKinem, Mitchell B.: 47, 55  
 Madden, Paul: 77  
 Maibach, Edward: 16  
 Malcom, Nancy L.: 144  
 Malley, Sara E.: 135  
 Manning, Jason P.: 48  
 Maples, James N.: 148  
 Markert, John: 147  
 Marsh, Kristin L.: 25  
 Marshall, Douglas A.: 116  
 Marshall, Holli: 68  
 Martin, Leslie: 25  
 Martin, Lindsey Erin: 134  
 Martin, Patricia Y.: 94  
 Mason, Sara F.: 23  
 Massey, Wil: 111  
 Matthews, Todd: 72, 104  
 Maume, David: 81, 94  
 Mauney, Heather: 120, 129  
 May, Caroline: 34  
 May, David C.: 134  
 Mays, Brittany: 37  
 Mays, Steven: 28  
 McCahill, Joseph Francis: 127  
 McCall, Patty L.: 78  
 McCandless, N. Jane: 129  
 McCarthy, Deborah M.: 3  
 McClure, Stephanie M.: 139  
 McDaniel, Chris P.: 142  
 McDonald, Maria Trull: 109  
 McDonald, Steve: 131  
 McDonough, Shannon M.: 126  
 McFarland, Heather: 74  
 McGrady, Patrick B.: 118  
 McGrath, Joanna C.: 112  
 McKay, Jeff: 28  
 McKelvey, Joel B.: 11  
 McKendry-Smith, Emily E.: 137  
 McLeese, Michelle F.: 81  
 McLucas, Karla M.: 148  
 McNeil, Bryce J.: 59  
 McQueeney, Krista: 125  
 McSpirit, Stephanie: 44  
 McVay, Christine: 99  
 McWilliams, Summer: 56, 129  
 Meador, John E.: 119  
 Meikle, Paulette A.: 141  
 Meine, Manfred F.: 27, 62  
 Mello, Heather L.: 115  
 Mickelson, Roslyn: 121  
 Middleton, Brian: 74  
 Miles, Andrew: 73  
 Miller, Beverly Paige: 144  
 Miller, Byron A.: 31, 126  
 Miller, Jacob Alden: 127  
 Miller, Kristen G.: 114, 123  
 Miller, O. Alexander: 86  
 Miller-Ardila, Carla: 51  
 Milligan, Tracy: 17  
 Milne, Jason: 130  
 Milner, Adrienne: 77  
 Miranda, Deb Yoder: 118  
 Mitchell, Jim: 109  
 Mitra, Debarashmi: 7  
 Mize, Trent: 136  
 Moadab, Nasim: 130  
 Mobley, Catherine: 3  
 Moller, Stephanie: 121  
 Molnar, Joseph J.: 72, 95  
 Molotch, Harvey: 44  
 Montgomery, Jolynn: 73  
 Mooney, Linda: 98  
 Moore, Lori D.: 133  
 Moore, Sara B.: 34  
 Morooka, Hideki: 98  
 Morris, Katherine: 46  
 Morris, Libby V.: 95  
 Morris, Sally: 32  
 Morrison, Emory: 130  
 Mundy, Karen C.: 13, 140  
 Munoz, John: 72  
 Murphy, John W.: 53  
 Myers, Tré: 136  
 Navarro, Jordana N.: 10  
 Ndofor, Michael: 35  
 Neary, Brigitte U.: 39  
 Neblett, Nichols M.: 26  
 Nelson, Lynn D.: 7  
 Neuenschwander, Sara: 140  
 Newsome, Yvonne: 82  
 Ngo, Christina H.: 15  
 Nielsen, Donald A.: 40, 116  
 Nielsen, Francois: 31  
 Nooney, Jennifer G.: 115  
 Norris, Claire M.: 110  
 Nowack, Sherry: 50  
 Nylander, Albert: 119  
 Oakley, Deirdre: 141  
 O'Connor, John: 145  
 O'Connor, Shannon: 66  
 Odom, Kelsey: 130  
 Olson, Linda S.: 119  
 O'Neal, Latoya: 66  
 O'Rand, Angela M.: 12, 64, 105  
 Ostertag, Stephen F.: 138  
 Otonicar, Jayna: 74  
 Owens, Dallas: 117

Padavic, Irene: 133  
 Page, Amy Dellinger: 14  
 Paige, Callie R.: 143  
 Palmer, Courtney: 86  
 Paolucci, Paul B.: 79  
 Parham, Caroline: 71  
 Parisi, Domenico: 72  
 Parker, Josie: 132, 141  
 Parker, Karen F.: 78  
 Parris, Christie: 3  
 Parsons, Tiffany: 129  
 Pattison, Evangeleen F.: 143  
 Paulk, Jeffrey: 125  
 Payne, Julianne: 65, 81  
 Pederson, Joellen: 120  
 Perdue, Robert Todd: 54  
 Perez, Geovanny: 54  
 Persaud, Chandrouti R.: 93  
 Petersen, Rebecca D.: 98  
 Petrie, Michelle: 3  
 Petrovic, Miodrag: 8  
 Pinheiro, Diogo L.: 11  
 Pinkerton, Allie: 111  
 Pitt, Richard N.: 115  
 Platt, Chelsea: 60  
 Platts, Todd: 99  
 Poling, Amanda: 126  
 Ponder, Rachel E.: 145  
 Potter, Daniel J.: 121  
 Poulson, Stephen C.: 74  
 Powers, Rebecca S.: 124  
 Praeli, Lorella: 19  
 Prager, Keith J.: 4  
 Precoda, Karl: 9  
 Price, Carmel E.: 135  
 Pritchard, Adam J.: 134  
 Proescholdbell, Rae Jean: 73  
 Prokos, Anastasia: 94  
 Pruitt, Cenate: 59, 132  
 Puffer, Eve S.: 73  
 Puhmann, Aaron: 77  
 Qiu, Hanyao: 34  
 Quattromani, Lauren M.: 20  
 Rabiner, Sarah: 104  
 Rahmings, Chris: 56  
 Ramsey, Darwin: 48  
 Randall, Nancy Horak: 98  
 Rashotte, Lisa: 49  
 Ratliff, Thomas N.: 9  
 Ray, Brad: 65, 103  
 Ray, Victor: 136  
 Rayburn, Rachel L.: 140  
 Reed, Sarah J.: 14  
 Reid, Julie: 89  
 Reid, Keshia M.: 126  
 Reid, Lesley Williams: 57  
 Reiser, Christa: 98  
 Reiter, Abigail B.: 95  
 Reiter, Elizabeth M.: 95  
 Reitman, Roger J.: 107  
 Reitzel, John D.: 58  
 Reitzes, Donald C.: 141  
 Resnik, David: 27  
 Reynolds, John R.: 121  
 Rice, John S.: 119  
 Rich, S. Lynne: 87  
 Richardson, Jeannae: 51  
 Riedel, Marc: 78  
 Rikard, Rv: 65, 76  
 Riley, Kelsey: 112  
 Ritchey, Andrew: 137  
 Ritchey, Ferris J.: 62  
 Ritzer, George: 64  
 Roach, Samantha: 10  
 Roach, Teresa: 47, 110  
 Robboy, Howard: 62  
 Robertson, Angela A.: 58, 78  
 Robinson, Dawn T.: 85, 136  
 Robinson, Zandria F.: 88  
 Rogers, Kimberly B.: 85  
 Rogers, Kyle: 120  
 Rogers, Richard Lee: 78, 147  
 Rohlinger, Deana A.: 120  
 Roksa, Josipa: 143  
 Roscigno, Vincent: 24, 94  
 Rote, Sunshine: 31  
 Rowan, Kathy: 16  
 Rowland, Aaron: 46  
 Rowley, Adam: 131  
 Rozenbroek, Katelyn J.: 132  
 Rubtsova, Anna A.: 7  
 Ruel, Erin: 141  
 Rusche, Sarah: 8, 41  
 Ryan, John: 32, 137  
 Ryan, March A.: 69  
 Sagreiya, Renu Urvashi: 5  
 Samson, Frank: 146  
 Samson, William: 23  
 Sana, Mariano: 97  
 Santana, Shannon A.: 98  
 Saunders, Emily K.: 98  
 Sawtell, Carolyn Sloane: 113  
 Sbicca, Joshua: 54  
 Scardaville, Melissa C.: 59  
 Schierle, Caroline Jeanette: 45  
 Schild, Marianne D.: 87  
 Schindler, Katy: 120  
 Schlaerth, Christian: 53  
 Schneider, Andreas: 21, 85  
 Schreier, Alan A.: 27  
 Schrock, Doug: 18  
 Schröder, Tobias: 85  
 Schubert, Dan: 6, 80  
 Scott, Jerome: 53  
 Scott, Shaunna: 44  
 Scroggins, Jennifer R.: 10, 30  
 Seaborn Thompson, Maxine: 65  
 Seale, Elizabeth: 73  
 Sebastian, Rachel A.: 34  
 Semora, Bonnie: 48  
 Sereny, Melanie: 149  
 Sessions, Miriam R.: 47, 60, 120  
 Seyfrit, Carole L.: 84  
 Shank, Daniel: 85  
 Sheff, Elisabeth: 83, 118  
 Shefner, Jon D.: 33, 46  
 Shelly, Robert: 84  
 Sheneman, Marie: 75, 130  
 Sherkat, Darren E.: 40  
 Sherohman, James: 84  
 Shihadeh, Edward S.: 37, 57  
 Shriver, Thomas E.: 2  
 Shrock, Peter: 133  
 Shrum, Wesley M.: 144  
 Shupe, Frances L.: 4  
 Sidhu, Damanvir K.: 16  
 Sills, Stephen J.: 27  
 Simons, Ronald L.: 49, 75  
 Simpson, Ida H.: 41  
 Simula, Brandy L.: 52, 76  
 Singelmann, Joachim: 61, 114  
 Sirisunyaluck, Bangon: 63  
 Skott, Beth P.: 107  
 Slates, Stephanie L.: 119  
 Slevin, Kate: 83  
 Sloan, Melissa: 81  
 Small, La Fleur F.: 123  
 Smith, Carrie L.: 144  
 Smith, Kelli K.: 142  
 Smith, Megan: 81  
 Smith, Shelley A.: 131  
 Smith, Valerie: 17  
 Smith-Lovin, Lynn: 85, 136  
 Sohoni, Deenesh S.: 8, 14  
 Sohoni, Tracy W.p.: 14  
 Solebello, Nicholas P.: 111  
 Song, Lijun: 21  
 Sonleitner, Nancy: 92  
 Soyer, Mehmet: 74  
 Spalter-Roth, Roberta: 84  
 Spencer, Zoe: 136  
 Spenner, Kenneth: 105  
 Spivey, Michael: 102  
 Spring, Ken: 107  
 Spurrier, Craig: 48  
 Stainback, Kevin: 81  
 Stanley, Marshica: 39  
 Stearns, Elizabeth: 56, 121  
 Steele, David F.: 50  
 Steele, Jamie B.: 70  
 Steffensmeier, Darrell: 57  
 Stern, Michael J.: 66  
 Stets, Jan E.: 108  
 Stewart-Cain, Karen: 99  
 Stompler, Mindy: 94  
 Stoner, Alex: 33  
 Storch, Jennifer: 40, 142  
 Stroble, Christine M.: 56  
 Stull, Lachae Ann: 122  
 Stutzman, Emily: 72  
 Su, Xiaoli: 75  
 Sullivan, Kevin: 145  
 Sumerau, J Edward: 60  
 Summers, Sarah K.: 109  
 Sutherland, Jean-Anne: 9, 41, 101  
 Sutphin, Suzanne T.: 126

Sydnor, Emily: 95  
 Talukdar, Jaita: 22  
 Taniguchi, Hiromi: 4  
 Taplin, Ian M.: 11  
 Taquino, Michael: 72  
 Tate, Nicole M.: 56  
 Tatum, Zachary: 141  
 Taylor, Rae: 60  
 Taylor, William: 46  
 Tenorio, Kimberly A.: 62  
 Tester, Griff: 82  
 Thibodeaux, Jarrett A.: 144  
 Thomas, James M.: 36  
 Thomas, Shaun: 37  
 Thompson, Ashley B.: 81  
 Thompson, Maxine S.: 65, 76  
 Tinkler, Justine: 52  
 Tiryakian, Edward A.: 91  
 Tomaskovic-Devey, Donald: 94  
 Toothman, Erica L.: 60  
 Treiber, Linda A.: 35  
 Tripp, Brad: 51  
 Trueblood, Amber B.: 98  
 Tucker, Stephanie: 98  
 Turner, R Jay: 110  
 Tuttle, Demetrice D.: 26  
 Tuttle, Joshua: 9  
 Tyson, Sarah R.: 98  
 Uassouf, Gabriela: 6  
 Ueno, Koji: 56  
 Unruh, Lynn: 115  
 Vaccaro, Christian: 96, 120  
 Valle, Giuseppina: 120  
 Van Loon, Francis: 100  
 Van Voorhis, Matthew F.: 16  
 Vandergriff-Avery, Maria: 107  
 Vasquez, Lauren: 68  
 Ventimiglia, Joe C.: 87  
 Vogt Yuan, Anastasia S.: 63  
 Volion, Ashley M.: 38  
 Waldron, Linda M.: 9, 22  
 Wallace, Erica R.: 22  
 Walter, Charles: 29, 110  
 Walters, Mikel: 113, 117  
 Walton, Calvin W.: 31  
 Walton, Chip: 18  
 Walton, Tobin: 33  
 Ward, Jr., Russell E.: 4  
 Warner, David F.: 131  
 Warr, Amanda: 66  
 Wasserman, Jason Adam: 60, 127  
 Watford, Zachary: 28  
 Watkins, William C.: 57  
 Watne, Zachary P.: 80, 131  
 Watson, Amanda: 146  
 Watson, Lesley: 132  
 Watts, Stephen: 10  
 Weaver, Alicia A.: 3  
 Weaver, Greg S.: 95  
 Webb, Susan E.: 55, 88  
 Webber, Gretchen: 89  
 Weber, Lynn: 44  
 Weil, Jeannie Haubert: 97  
 Weinberg, Lisa Munson: 121  
 Weinstein, Raymond M.: 55  
 Weiss, Gregory: 106, 139  
 Weiss, Harald E.: 57  
 Welch, Casey: 43, 103  
 Wernet, Christine A.: 71  
 Weston, William J.: 61  
 Whalen, Travis F.: 6  
 Wharton, Carol: 96  
 White, Bradford Emory: 5  
 White, Patricia E.: 108  
 Wiest, Julie B.: 58, 83, 117  
 Wiggan, Greg: 31, 56  
 Wilcox, Pamela: 134  
 Wiley, Jonathan D.: 69  
 Wilke, Arthur S.: 129  
 Wilkinson, Matt: 76, 83  
 Wilkinson, Matthew E.: 76  
 Wilkinson, Meisha: 30  
 Will, Jeffrey A.: 17  
 Willis, Amy K.: 93  
 Willis, Cecil: 78, 134  
 Wills, Jeremiah B.: 103  
 Willson, Shane M.: 46  
 Wilson, George: 124  
 Wilson, Kenneth R.: 27, 98  
 Wilson, Kris: 16  
 Wilson, Thomas C.: 86  
 Wimberley, Dale W.: 62  
 Wimberley, Ronald C.: 72, 95  
 Wimmer, Peg: 13  
 Wingfield, Adia Harvey: 82  
 Winslow-Bowe, Sarah: 115  
 Winstead, Vicki: 66  
 Winters, Lisa J.: 57  
 Wisdom, Summer: 38  
 Wise, Michael: 35  
 Witte, James: 3, 16  
 Witte, Joe: 16  
 Wojtkiewicz, Roger A.: 97  
 Wolnik, Darlene: 145  
 Wood, Peter B.: 134  
 Worthington, Sonya Y.: 98  
 Wouters, Edwin: 100  
 Wright, James D.: 140  
 Wright, James L.: 137  
 Wu, Shanhui: 72  
 Wynn, Colleen E.: 134  
 Xu, Jun: 100  
 Xu, Xiaohe: 63, 87  
 Yagatich, William A.: 88  
 Yancey, George A.: 103  
 Yoder, Maggie: 98  
 Yoon, Jungwon: 7  
 Yore, Michelle: 115  
 Yost, Elizabeth: 66  
 Young, Rebecca: 79  
 Zavodny, Madeline: 119  
 Zhang, Zhi: 63  
 Zhao, Wei: 124  
 Zhao, Xiaoquan: 16  
 Zuckerman, Marni: 140

## Notes

---

**Hyatt Regency Atlanta—Lenox, Heritage**

**Atlanta Conference Center Level**

**These escalators go UP to Embassy Hall Level of International Tower  
(Cairo, Hong Kong, Manila,  
Montreal, Singapore, Vancouver)**

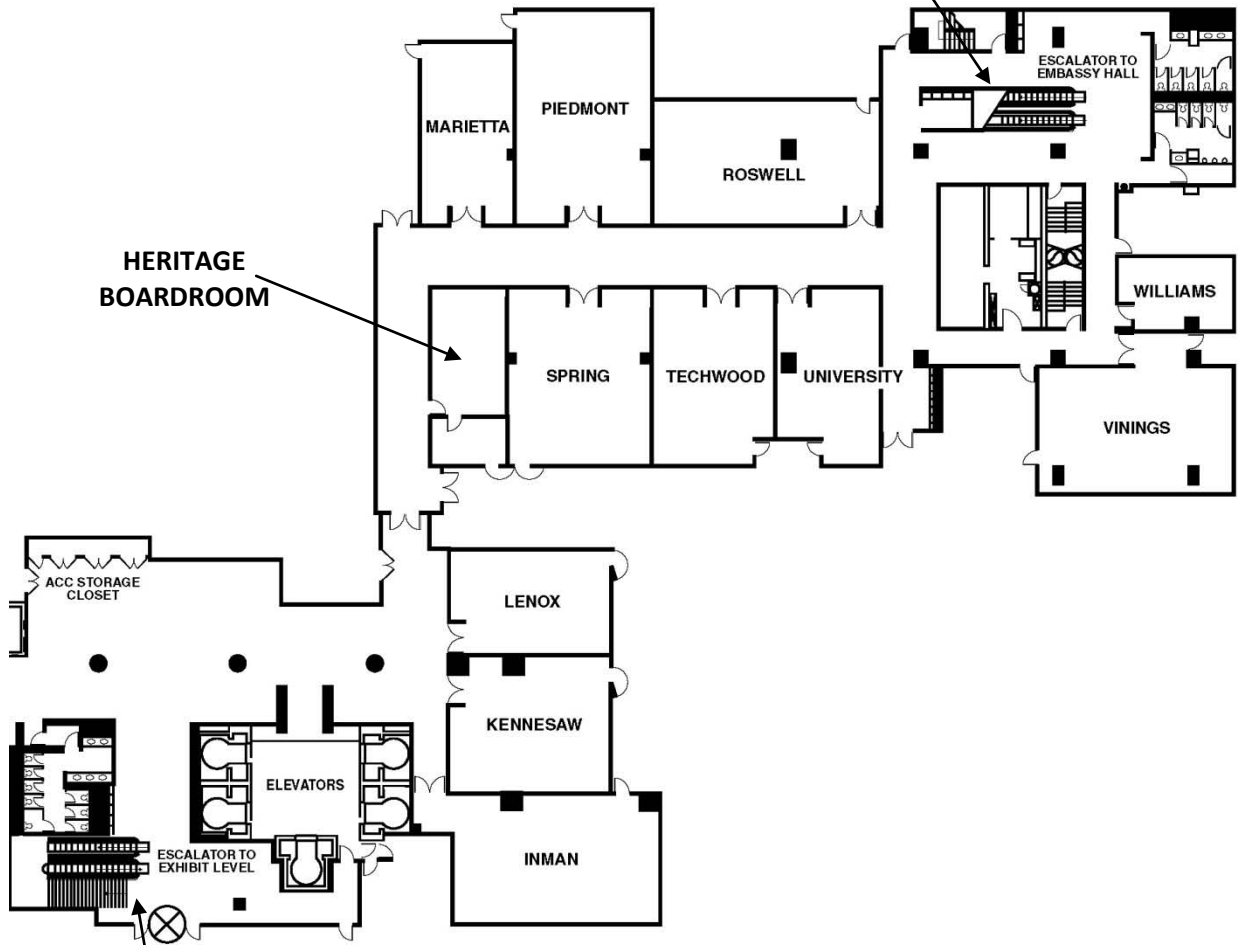

**HERITAGE BOARDROOM**

**These escalators go UP to  
Exhibit Level  
(Grand Hall A-D and East)**

# Hyatt Regency Atlanta—Grand Hall A, B, C, and East

## Exhibit Level

These escalators go UP to Ballroom Level and then to the Lobby; from the Lobby go to International Tower to access other meeting areas

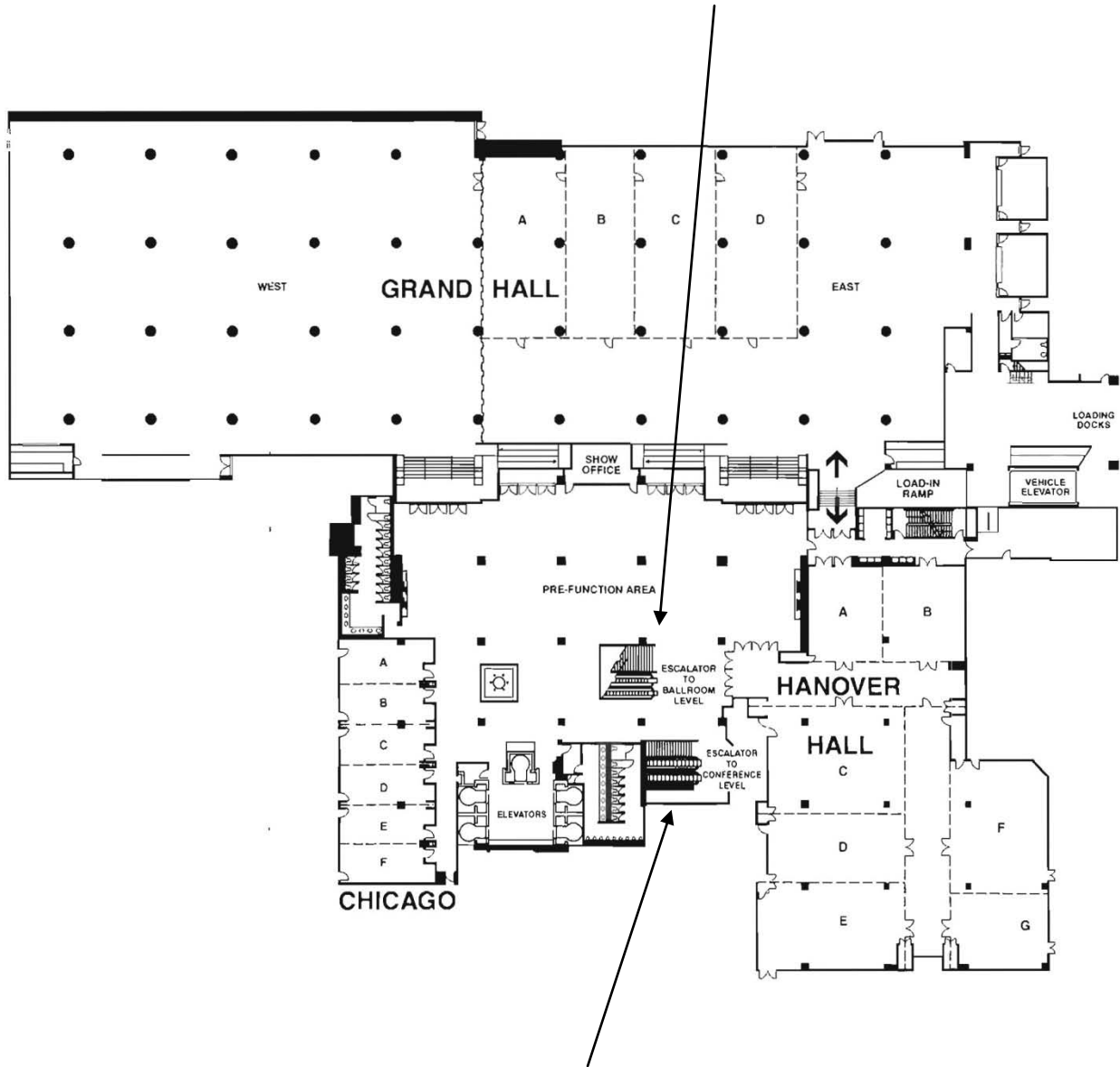

These escalators go DOWN to Atlanta Conference Center Level (Lenox, Heritage)

**Hyatt Regency Atlanta—International Ballrooms North and South, Cairo, Hong Kong, Manila, Montreal, Singapore, Vancouver**

**Ballroom and Embassy Hall Levels of International Tower**

These escalators go UP to Registration and to the Lobby, and they go DOWN to the Embassy Hall Level, and then to Atlanta Conference Center Level.

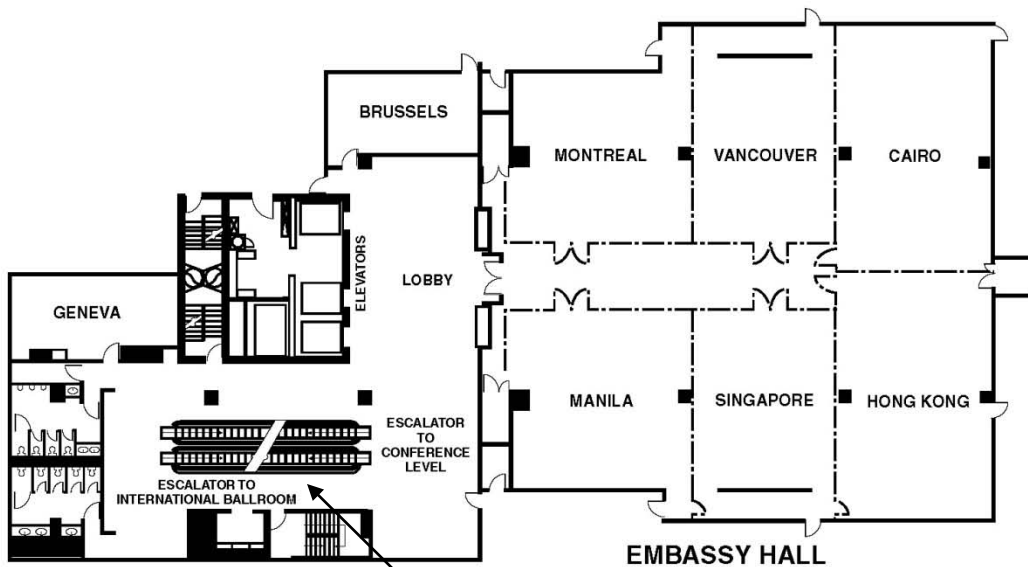
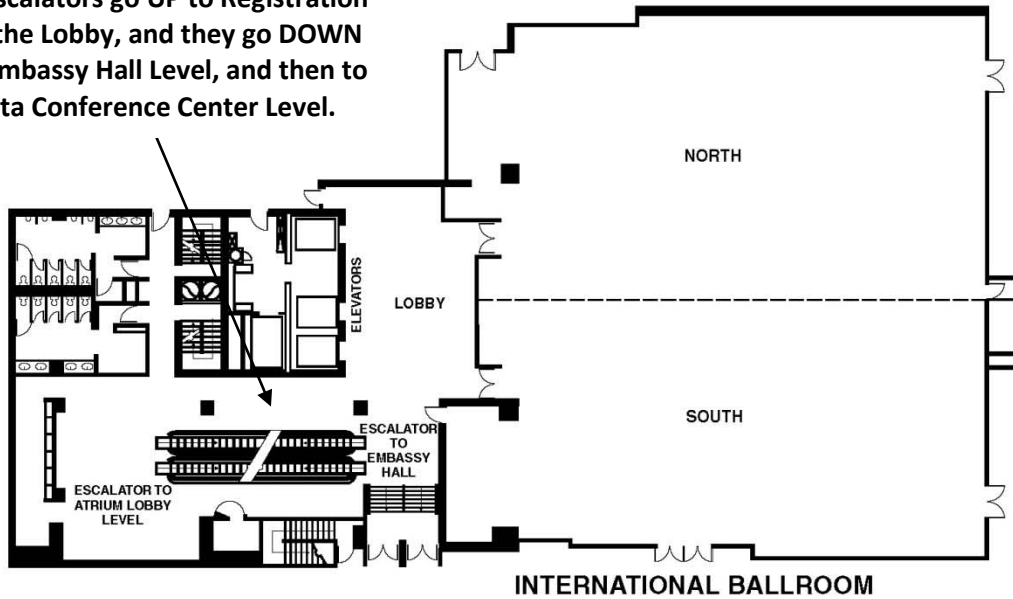

These escalators go UP to the International Ballroom Level and then to Registration and the Lobby; they go DOWN to Atlanta Conference Center Level (Lenox and Heritage).

# Hyatt Regency Atlanta—Overview

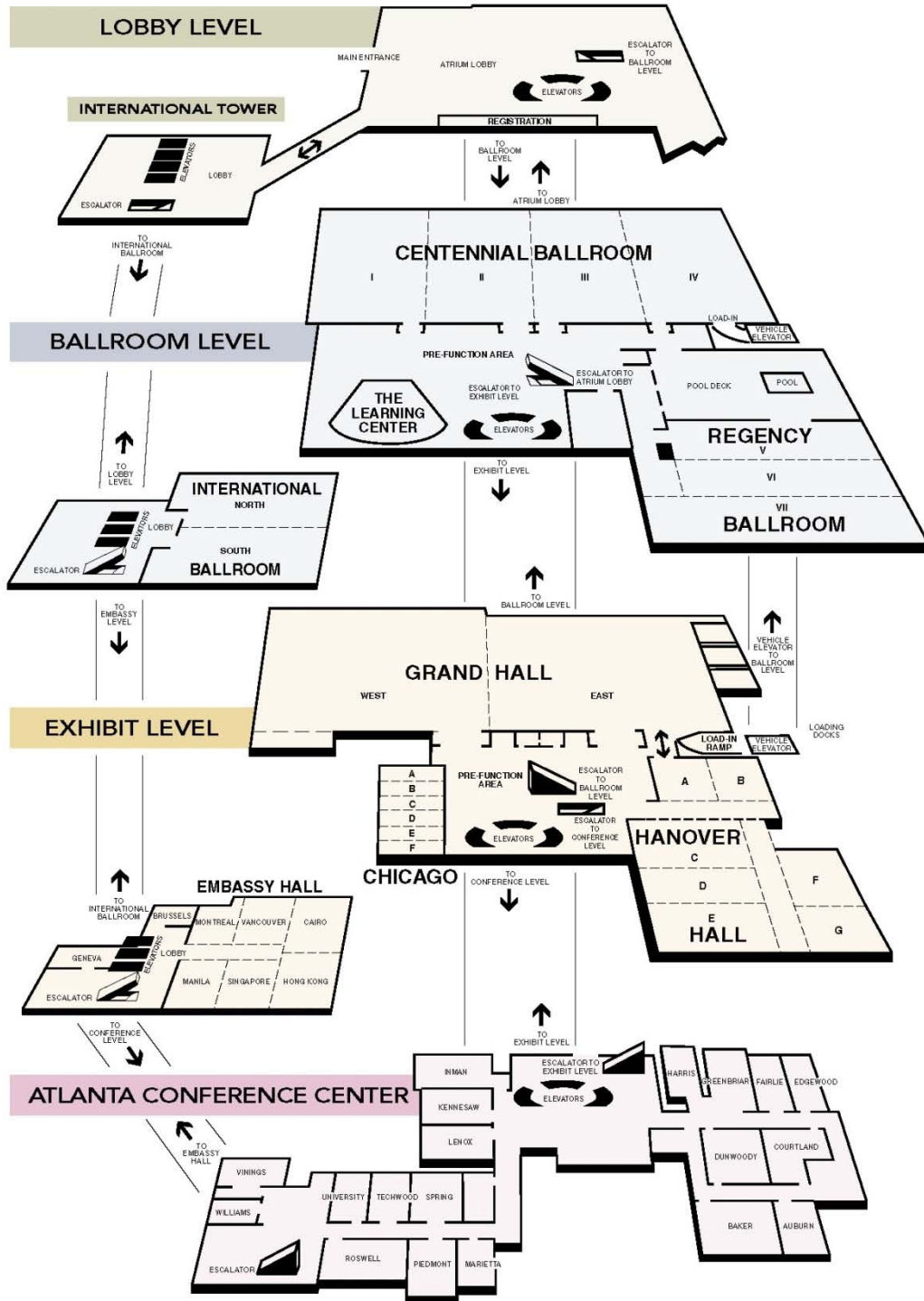

**2011 Annual Meeting: April 6-9 in Jacksonville, FL**

